

W:\2015\15-5795 North Bluffs Dev Corp - The Porches at Rockwater\Design Drawings\Contract 1\LR15-5795-CVR.dwg 6/7/17 at 9:52am

PARKER STREET IMPROVEMENTS

NORTH LITTLE ROCK, ARKANSAS

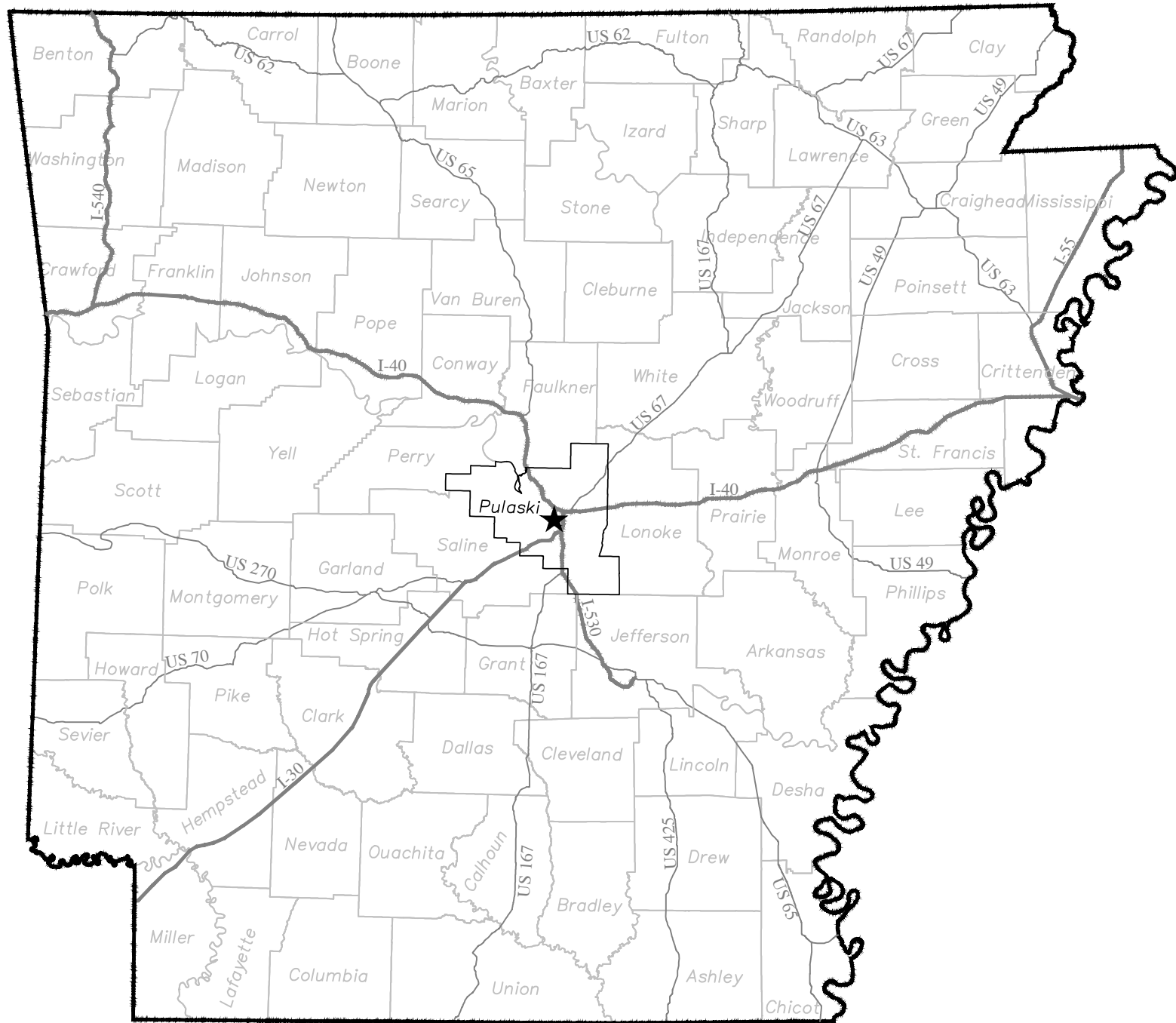

LOCATION MAP

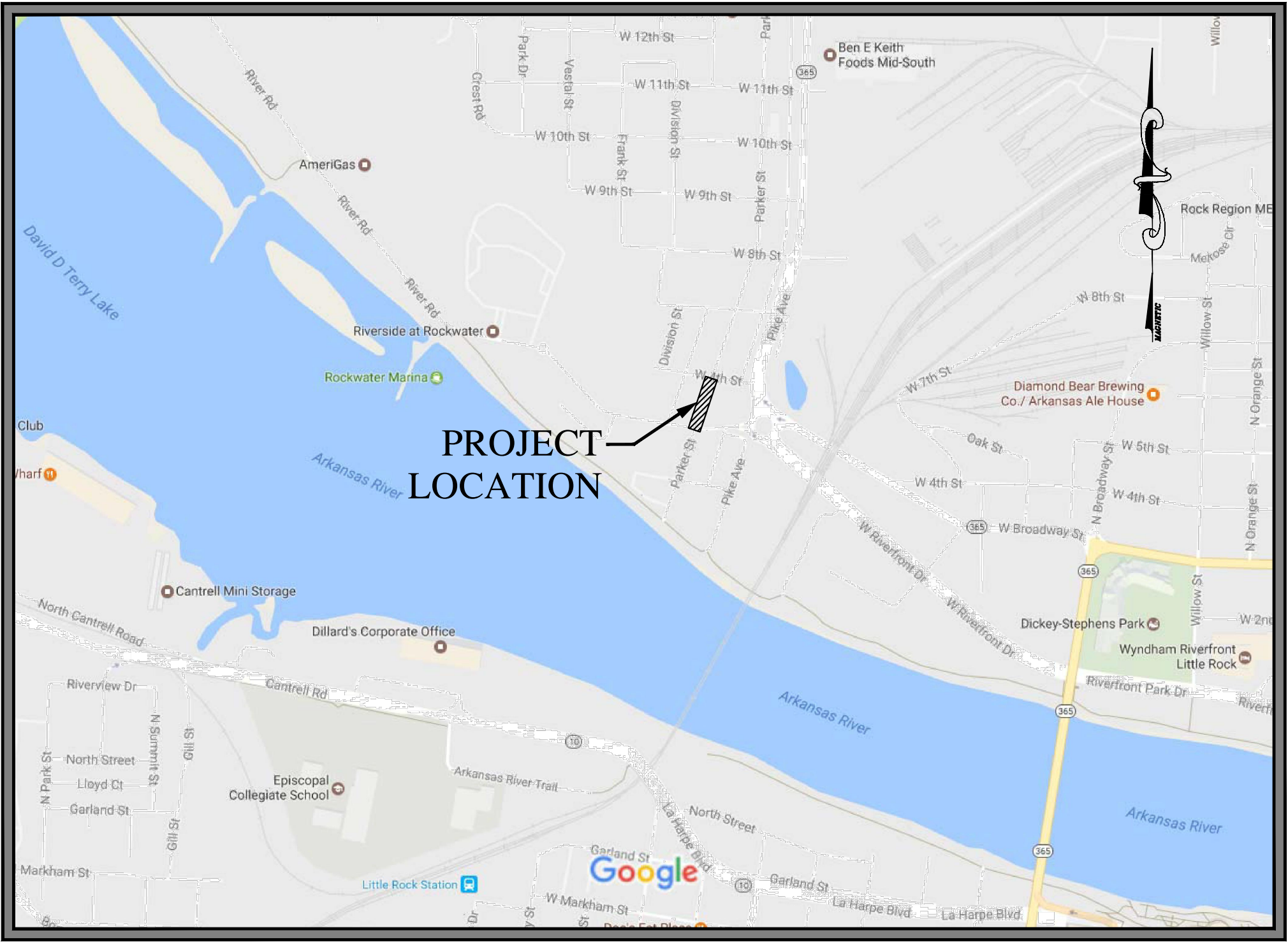

VICINITY MAP

INDEX TO DRAWINGS

1. COVER SHEET
2. TOPOGRAPHIC SURVEY
3. SITE LAYOUT
4. PARKER STREET PLAN AND PROFILE
5. PARKER STREET CROSS SECTIONS
6. MISCELLANEOUS DETAILS

APRIL, 2017
MCE PROJECT NO. LR15-5795-1

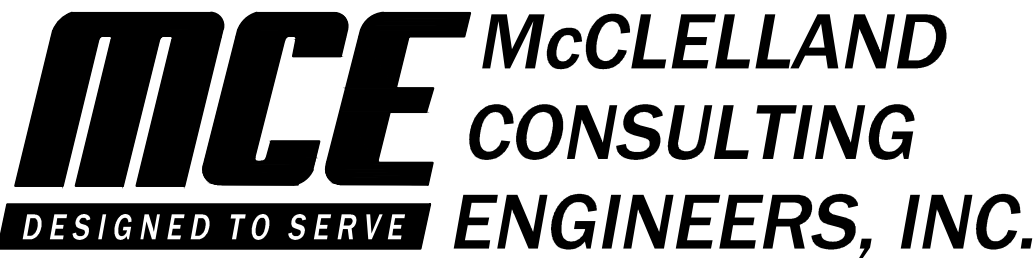

1810 N. College Fayetteville, AR 72702 PH# 479-443-2377
7302 Kanis Rd. Little Rock, AR 72204 PH# 501-371-0272
4606 S. Garnett Rd. Ste. 401 Tulsa, OK 74146 PH# 918-619-6803

<http://www.mce.us.com>



Know what's below.
Call before you dig.

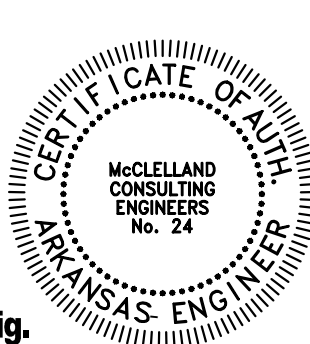

ORIGINAL SIGNATURE ON FILE



1. ALL OSHA REGULATIONS SHALL BE STRICTLY FOLLOWED AND SPECIAL CARE TAKEN TO PREVENT INTERACTION W/ OVERHEAD OR UNDERGROUND POWER SOURCES.
2. THE LOCATION OF KNOWN SUBSURFACE STRUCTURES, PIPE, POWER, GAS, PHONE, ETC. ARE SHOWN ON THE PLANS. THE CONTRACTOR SHALL BE RESPONSIBLE FOR OBTAINING INFORMATION AND SATISFYING HIMSELF AS TO THE LOCATION OF THE AFORESAIDED ITEMS, SHOWN AND NOT SHOWN. ALL REPAIRS TO UTILITIES DAMAGED BY CONTRACTOR SHALL BE MADE AS REQUIRED BY THE OWNER OF THE UTILITY OR STRUCTURE. THE COST OF SUCH REPAIRS NECESSARY SHALL BE BORNE BY THE CONTRACTOR.
3. ALL STREETS, DRIVES, WALKS, DRAINAGE STRUCTURES, FENCES, ETC. THAT ARE DISTURBED SHALL BE RESTORED TO THEIR ORIGINAL OR BETTER CONDITION USING LIKE MATERIALS. COST OF SUCH REPAIRS SHALL BE BORNE BY THE CONTRACTOR UNLESS PROVISION FOR PAYMENT IS MADE IN THE PROPOSAL.
4. ALL CONCRETE SHALL DEVELOP 3000 PSI COMPRESSIVE STRENGTH IN 28 DAYS UNLESS OTHERWISE SPECIFIED.
5. THE CONTRACTOR IS REQUIRED TO NOTIFY THE ONE CALL CENTER AT 811 (48) HOURS PRIOR TO DIGGING IN ORDER THAT UNDERGROUND UTILITIES IN THE AREA CAN BE LOCATED.
6. WATERLINES SHALL HAVE MINIMUM OF 10 FEET HORIZONTAL CLEARANCE FROM SANITARY SEWERS. WHEN WATERLINES CROSS SANITARY SEWERS THEY SHALL HAVE A MINIMUM OF 18 INCHES VERTICAL SEPARATION WITH WATER ON TOP, ELSE ENCASEMENT PIPE WILL BE REQUIRED. ANY DEVIATION MUST BE APPROVED BY THE ARKANSAS DEPARTMENT OF HEALTH IN WRITING.
7. INSTALL POLYETHYLENE ENCASEMENT AT ALL LOCATIONS WHERE NEW WATERLINE CROSSES EXISTING NATURAL GAS LINES (20' EACH SIDE OF CROSSING) AND WHERE OTHERWISE SHOWN.



***PARKER STREET
IMPROVEMENTS***
NORTH LITTLE ROCK, ARKANSAS



SITE LAYOUT

PROJECT ENGR: MK	DRAWN BY: JAM
DATE: APRIL 2017	
SCALE: 1"=20'	JOB NUMBER: LR15-5795

W:\2015\15-5795 North Bluffs Dev Corp - The Porches at Rockwater\Design Drawings\Contract 1\LR15-5795-SITE PLAN.dwg 6/7/17 at 10:05am

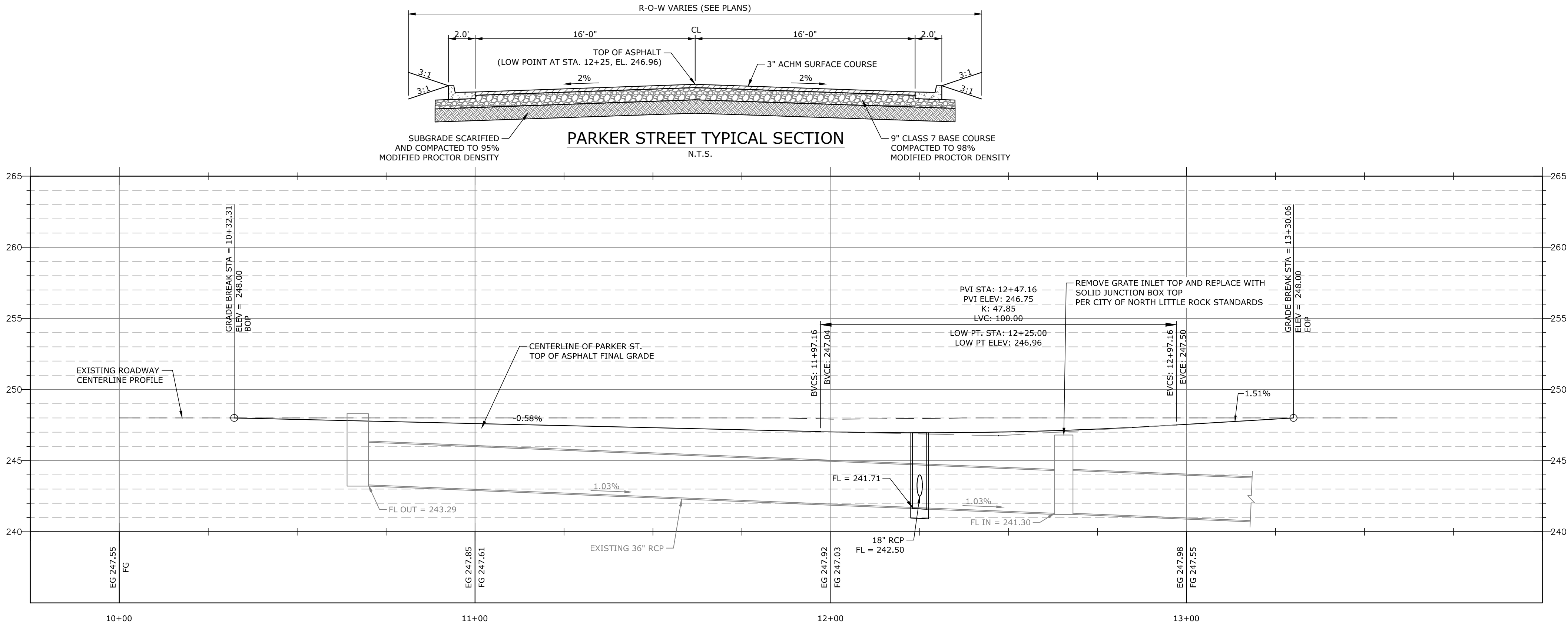
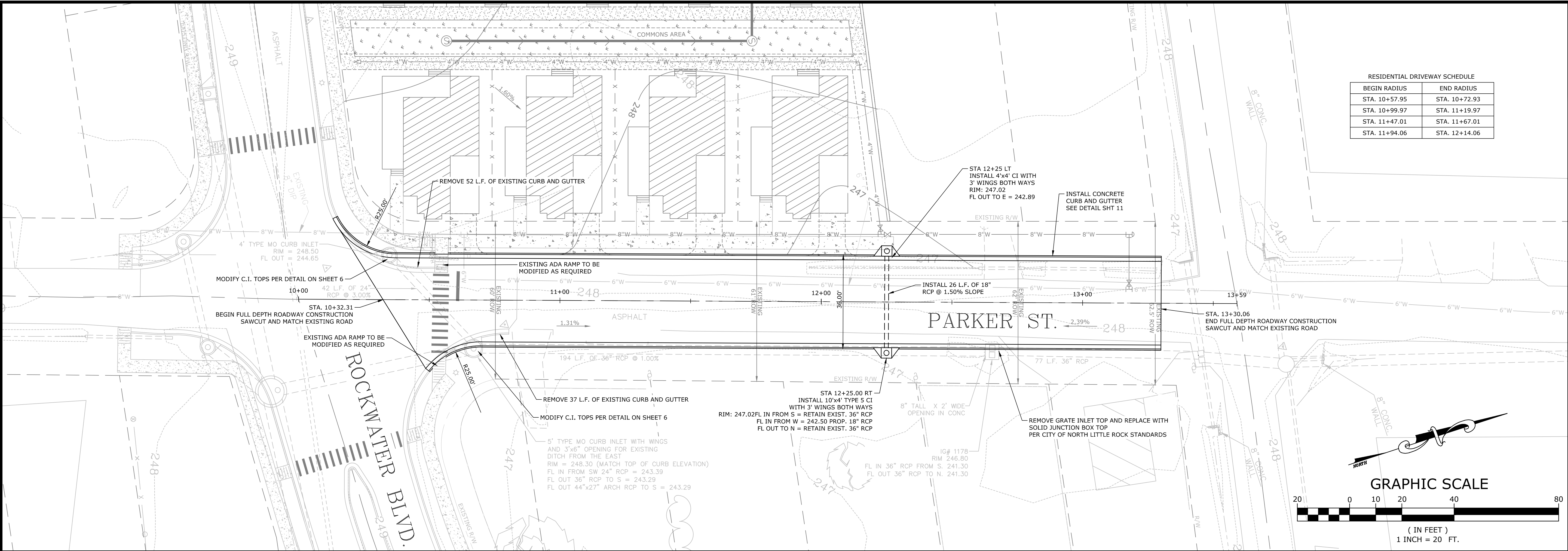

McCLELLAND CONSULTING, INC.
DESIGNED TO SERVE ENGINEERS, INC.

1800 N. College
Fayetteville, AR 72702
P# 479-443-2377

4606 S. Ginger Rd. Ste. 401
Tulsa, OK 74146
P# 918-619-6803

<http://www.mcc.us.com>

STATE OF ARKANSAS
REGISTERED PROFESSIONAL ENGINEER
No. 12362
JANUARY E. AKIN

ORIGINAL SIGNATURE ON FILE

PARKER STREET IMPROVEMENTS
NORTH LITTLE ROCK, ARKANSAS

One Call
811
Know what's below.
Call before you dig.

REVISIONS	
NO.	DATE

PROJECT ENGR:	DRAWN BY:
MK	JAM

DATE:	JOB NUMBER:
APRIL 2017	LR15-5795-1

SCALE:
AS SHOWN

4

W:\2015\15-5795 North Bluffs Dev Corp - The Porches at Rockwater\Design Drawings\Contract 1\LR15-5795-SITE PLAN.dwg 6/7/17 at 10:13am

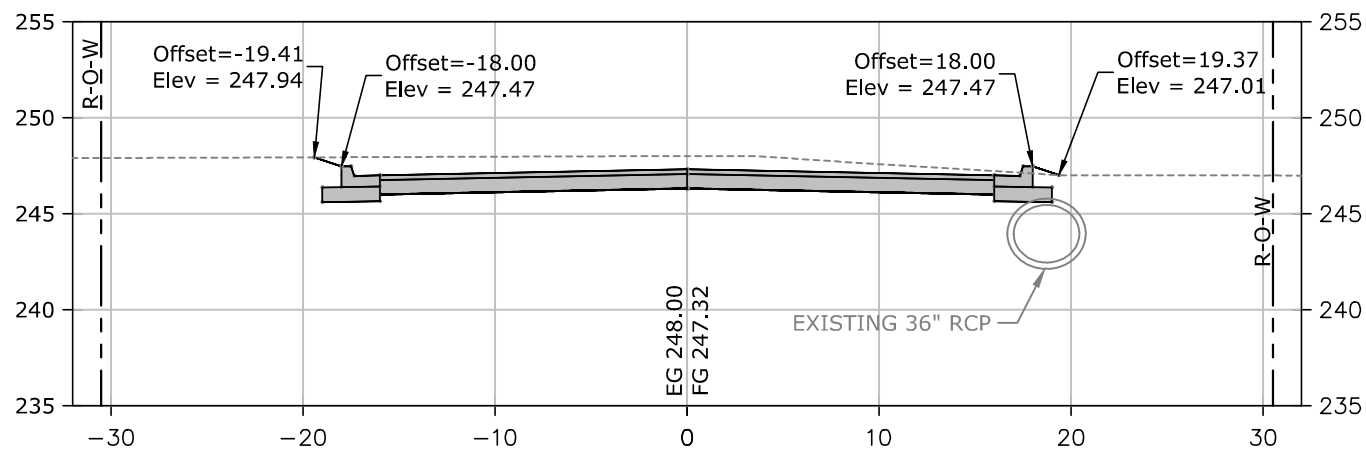

Total Volume at Station 11+50.00	
Cut Area	66.00
Fill Area	0.11
Cut Vol	100.43
Fill Vol	0.37
Net Vol	177.89

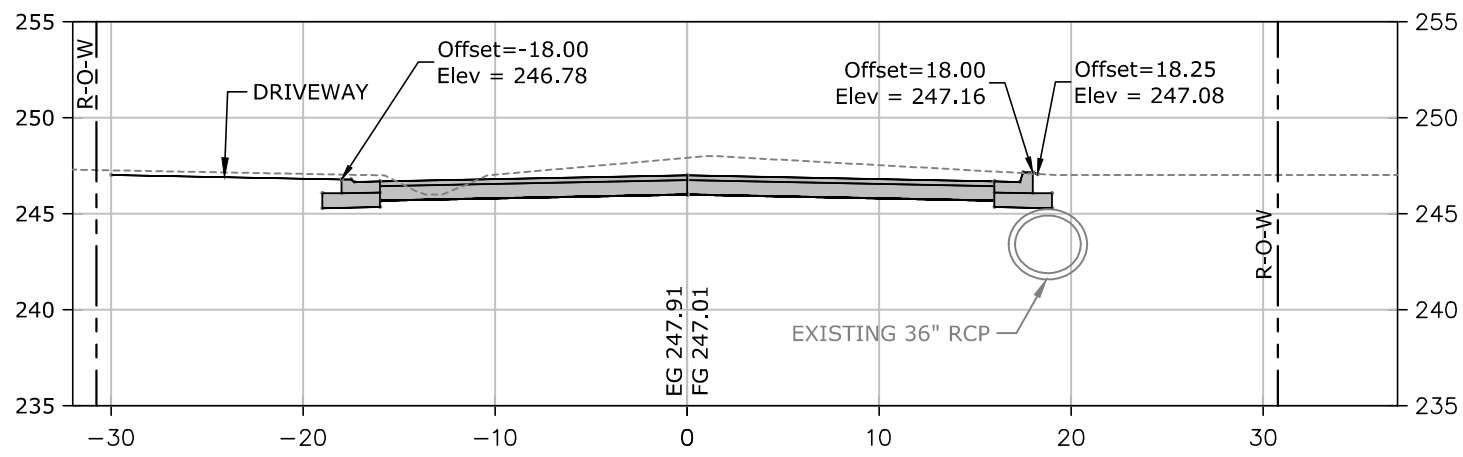

Total Volume at Station 12+04.00	
Cut Area	68.12
Fill Area	0.01
Cut Vol	10.23
Fill Vol	0.00
Net Vol	309.10

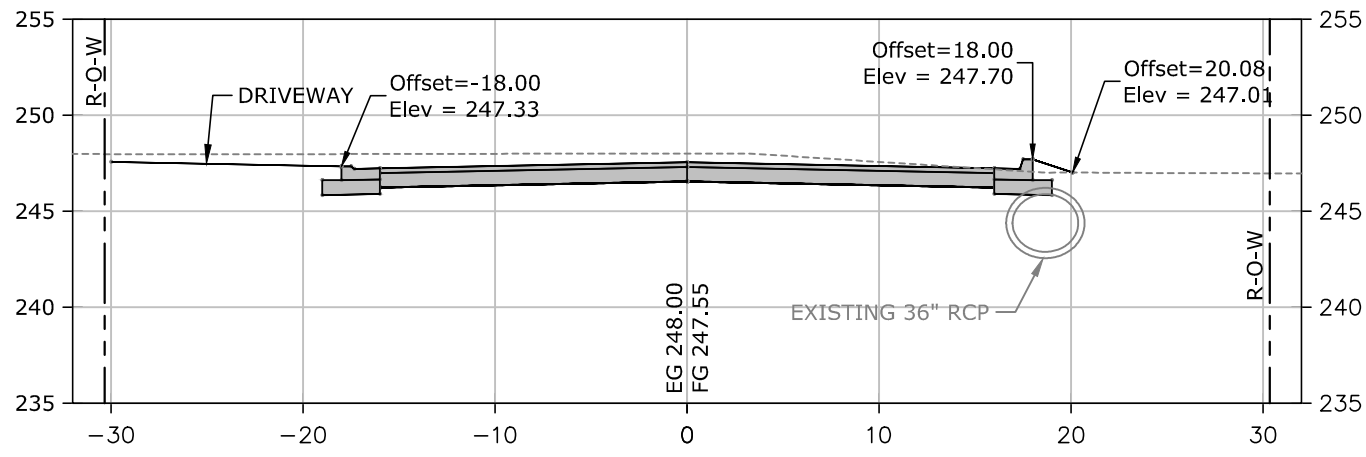

Total Volume at Station 11+09.92	
Cut Area	69.32
Fill Area	0.39
Cut Vol	22.24
Fill Vol	0.14
Net Vol	77.82

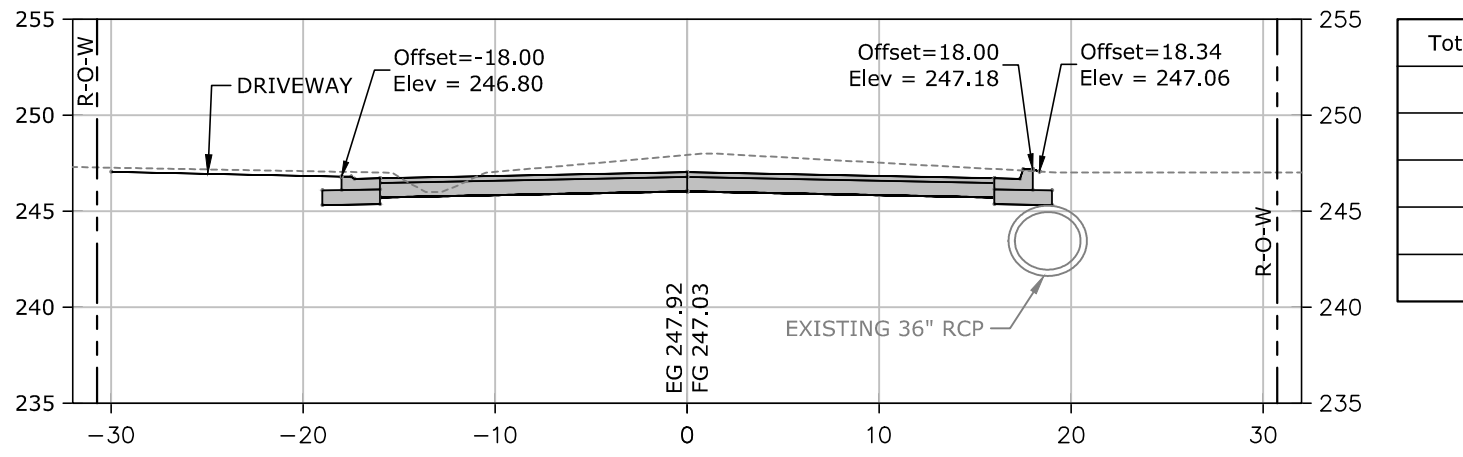

Total Volume at Station 12+00.00	
Cut Area	69.82
Fill Area	0.02
Cut Vol	44.77
Fill Vol	0.05
Net Vol	298.87

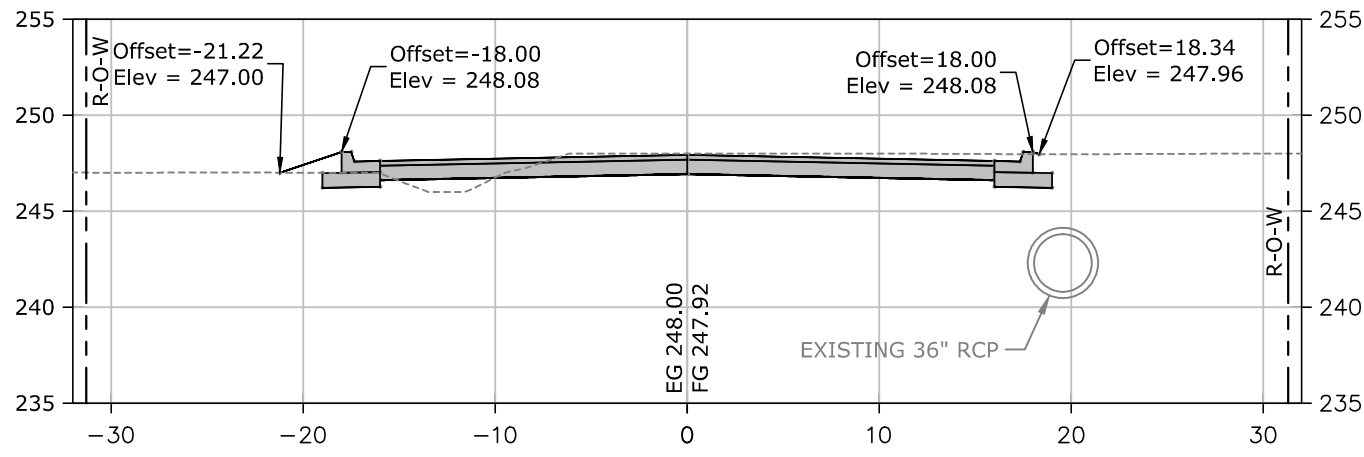

Total Volume at Station 13+25.00	
Cut Area	33.96
Fill Area	2.16
Cut Vol	39.56
Fill Vol	1.16
Net Vol	543.08

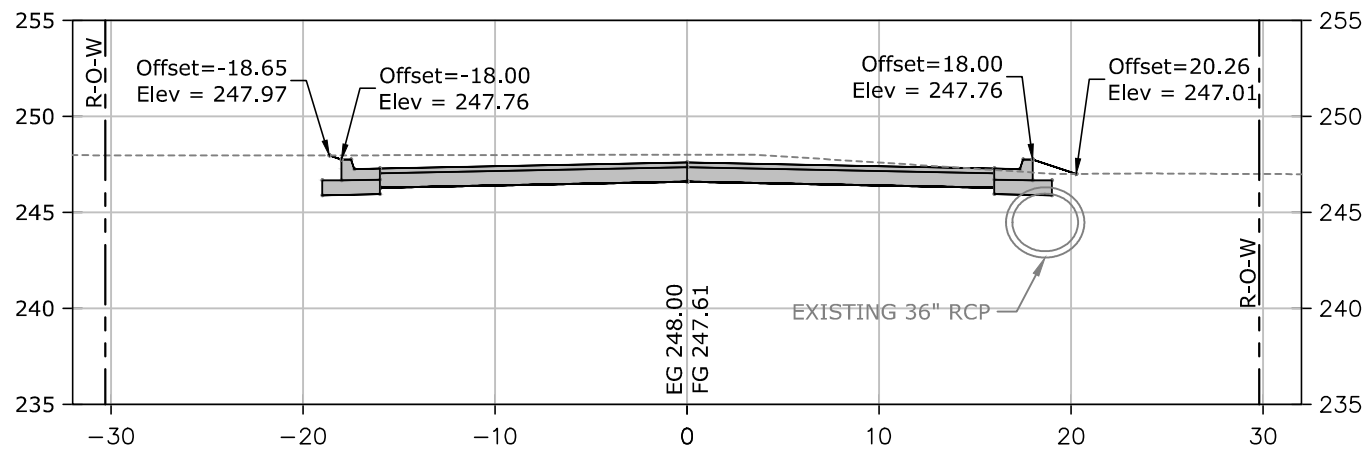

Total Volume at Station 11+00.00	
Cut Area	51.72
Fill Area	0.36
Cut Vol	59.90
Fill Vol	4.19
Net Vol	55.72

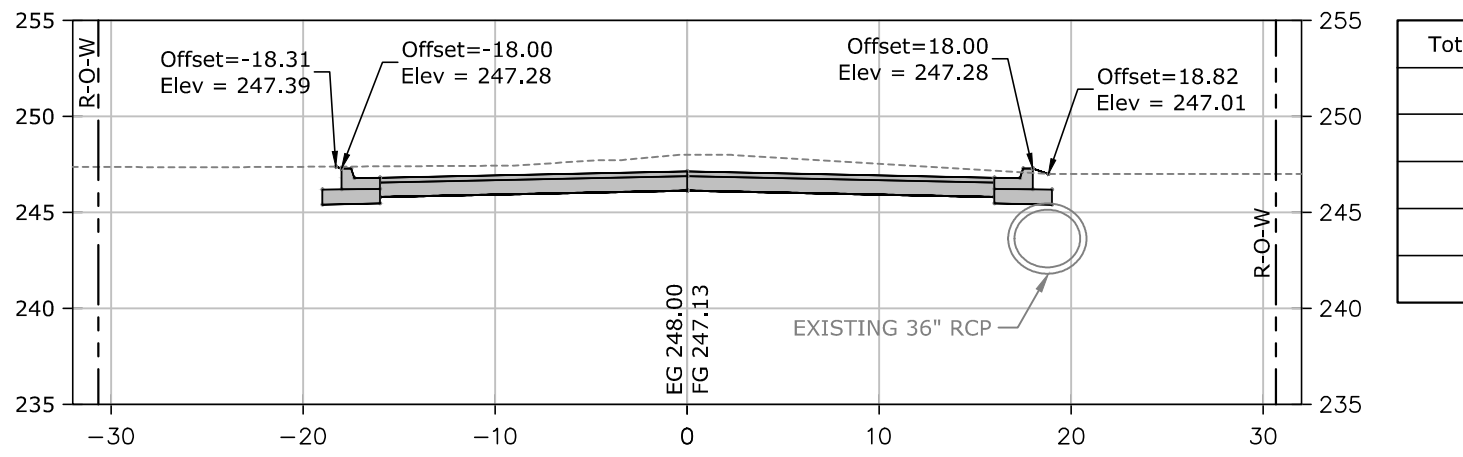

Total Volume at Station 11+81.62	
Cut Area	61.70
Fill Area	0.12
Cut Vol	59.16
Fill Vol	0.13
Net Vol	254.15

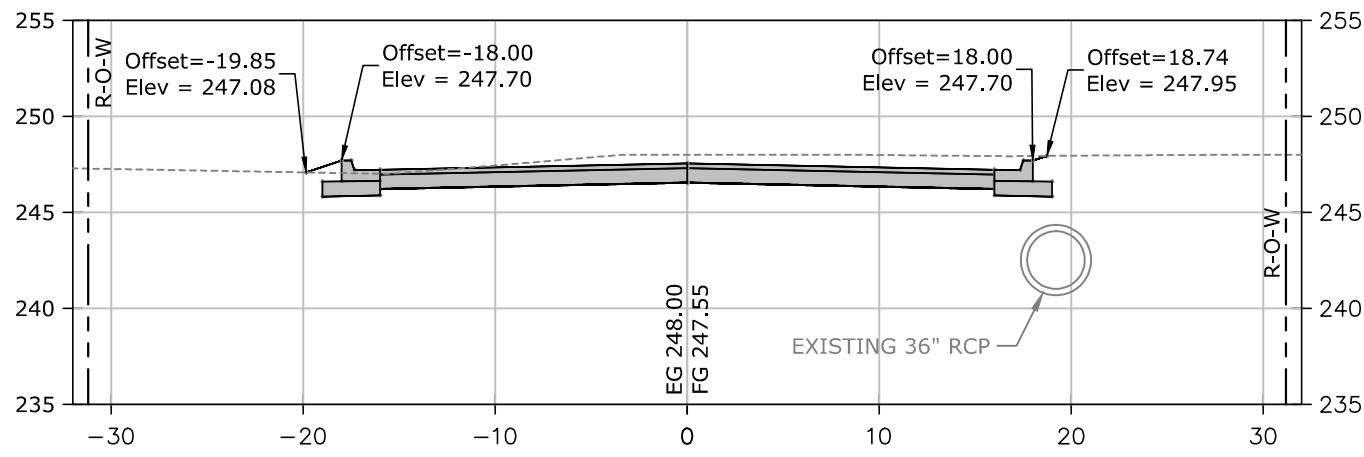

Total Volume at Station 13+00.00	
Cut Area	51.49
Fill Area	0.35
Cut Vol	95.89
Fill Vol	1.54
Net Vol	504.68

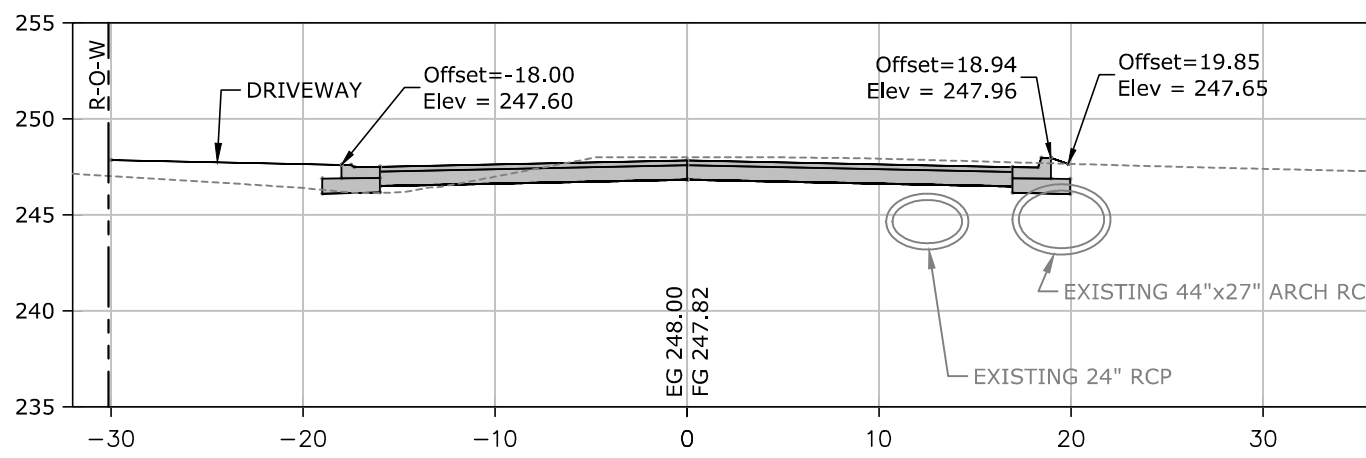

Total Volume at Station 10+62.88	
Cut Area	35.44
Fill Area	5.73
Cut Vol	0.00
Fill Vol	0.00
Net Vol	0.00

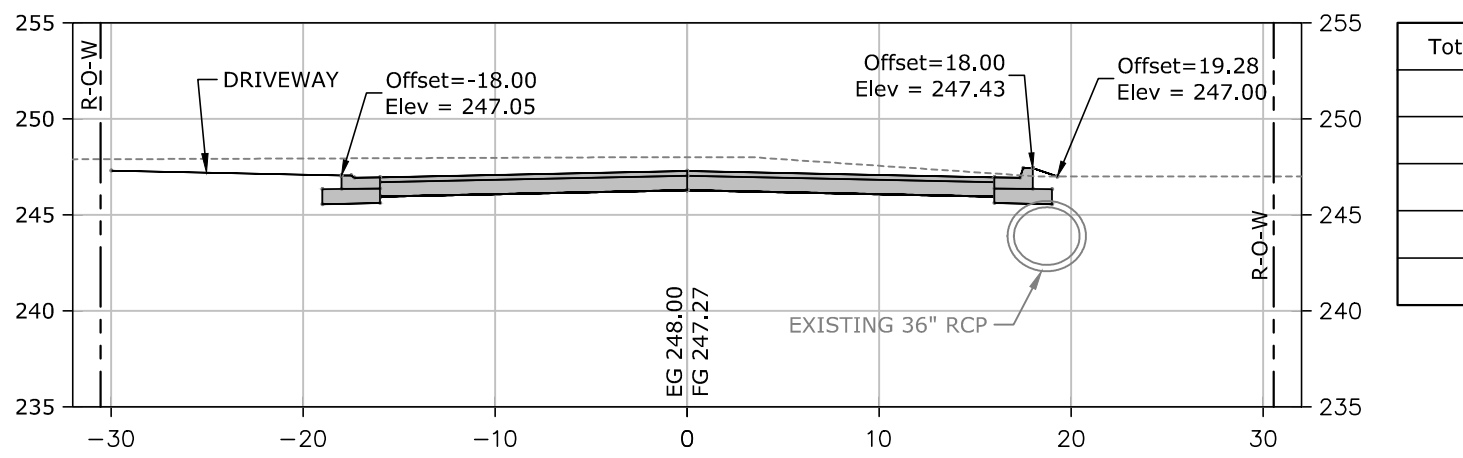

Total Volume at Station 11+56.96	
Cut Area	67.87
Fill Area	0.15
Cut Vol	17.26
Fill Vol	0.03
Net Vol	195.12

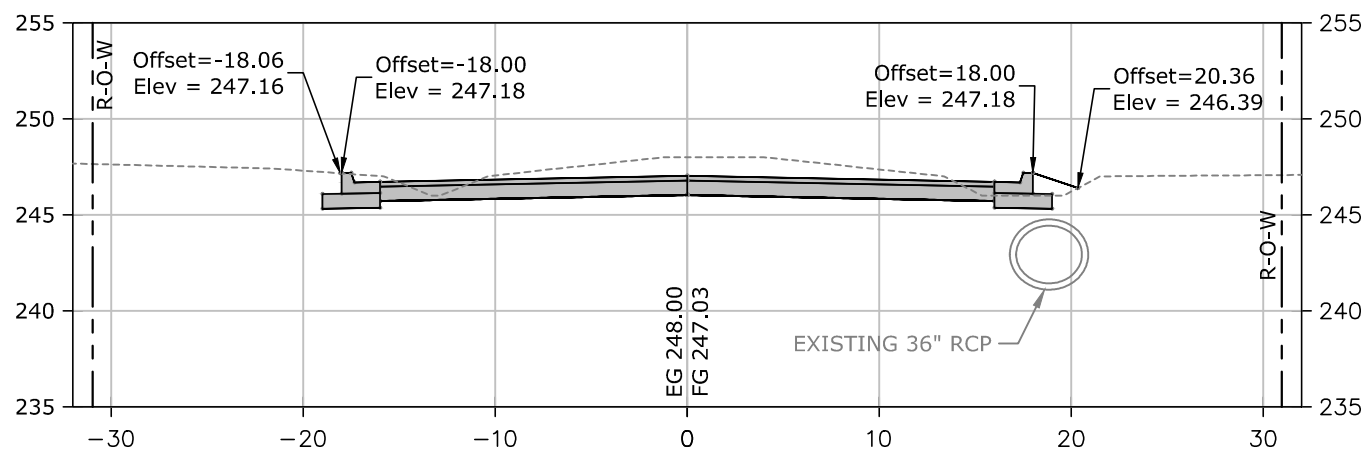

Total Volume at Station 12+50.00	
Cut Area	52.06
Fill Area	1.31
Cut Vol	102.37
Fill Vol	1.13
Net Vol	410.34

SCALE:
1"=10' HORIZ.
1"=10' VERT.

- NOTES:
- EARTHWORK SHALL BE PAID PER PLAN QUANTITIES ONLY.
 - EARTHWORK VOLUMES ARE SHOWN FOR REFERENCE.



ORIGINAL SIGNATURE ON FILE

PARKER STREET
IMPROVEMENTS
NORTH LITTLE ROCK, ARKANSAS

One Call
811
Know what's below.
Call before you dig.

REVISIONS	
NO.	DESCRIPTION
DATE	

PARKER STREET
CROSS
SECTIONS

PROJECT ENGR: MK
DRAWN BY: JAM

DATE:
APRIL 2017

SCALE:
1"=20'

JOB NUMBER:
LR15-5795-1

5

McCLELLAND
CONSULTING, INC.
DESIGNED TO SERVE
REGISTERED PROFESSIONAL ENGINEER
No. 12362
Tracy E. Kinn
1800 N. College
Fayetteville, AR 72702
7302 Kams Rd.
Little Rock, AR 72204
4606 S. Gansett Rd. Ste. 401
Tulsa, OK 74146
P# 479-443-2377
P# 918-619-6803
http://www.mcc.us.com

© 2017

