

# WALNUT STREET RESTORATION (15TH TO 17TH) NORTH LITTLE ROCK, AR



APRIL 2021

INDEX OF SHEETS	
SHEET	TITLE
C	COVER SHEET
1	PLAN AND PROFILE 1
2	PLAN AND PROFILE 2A
3	PLAN AND PROFILE 2B
4	CROSS SECTIONS 1
5	CROSS SECTIONS 2
6	DETAILS 1
7	DETAILS 2



CITY OF NORTH LITTLE ROCK  
Engineering Department

500 WEST 13TH STREET  
NORTH LITTLE ROCK, AR 72114

WALNUT STREET RESTORATION  
(15TH TO 17TH)

COVER SHEET

DATE: 4/2021  
DESIGNED BY: MCK  
DRAWN BY: MCK

SHEET NUMBER

C



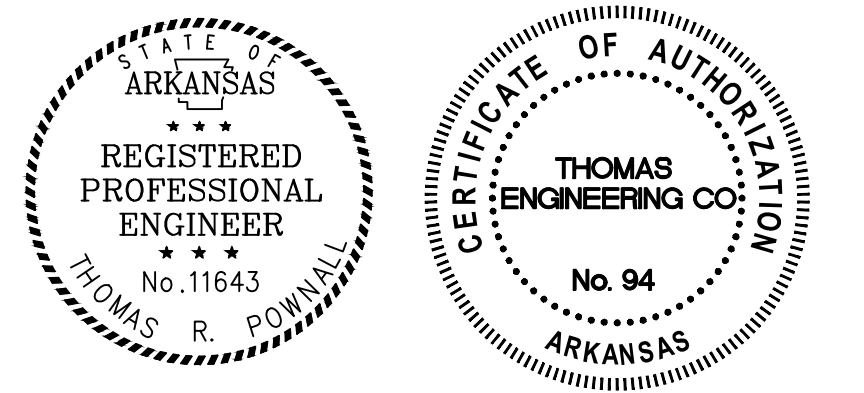
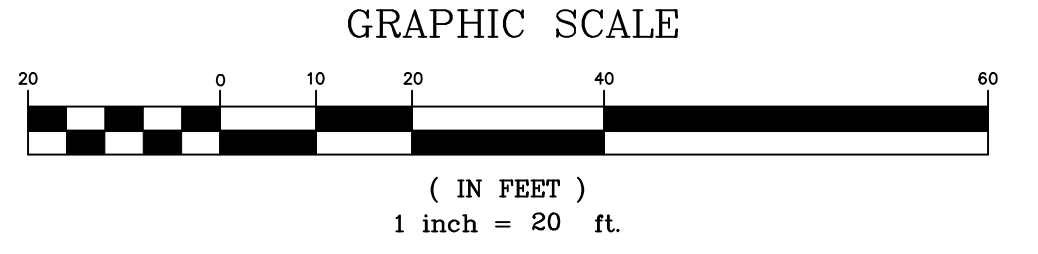
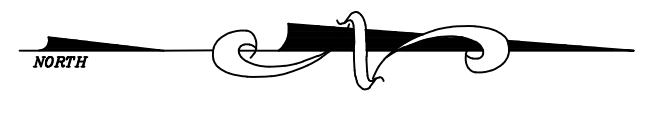
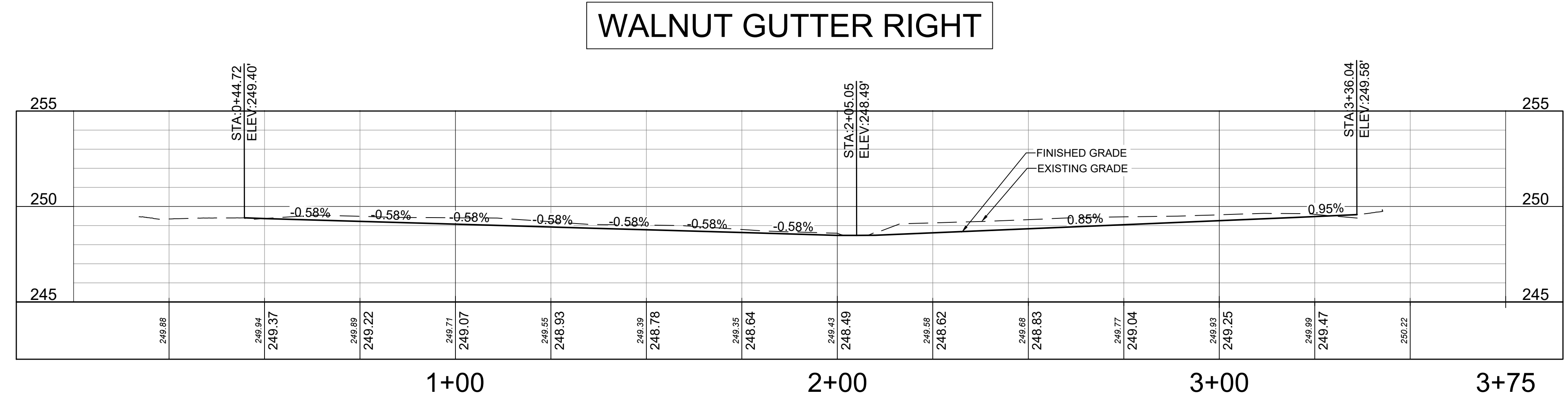
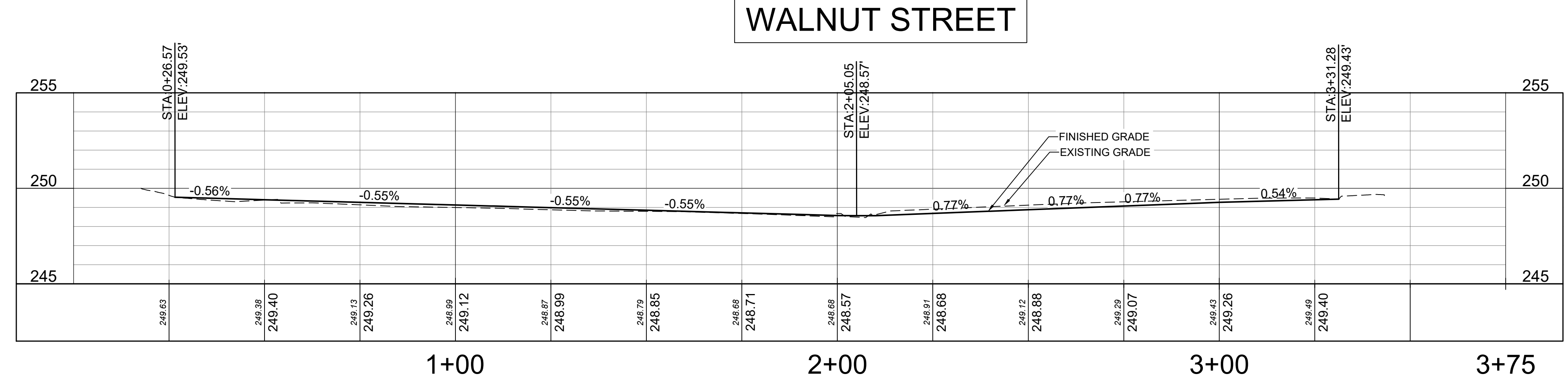
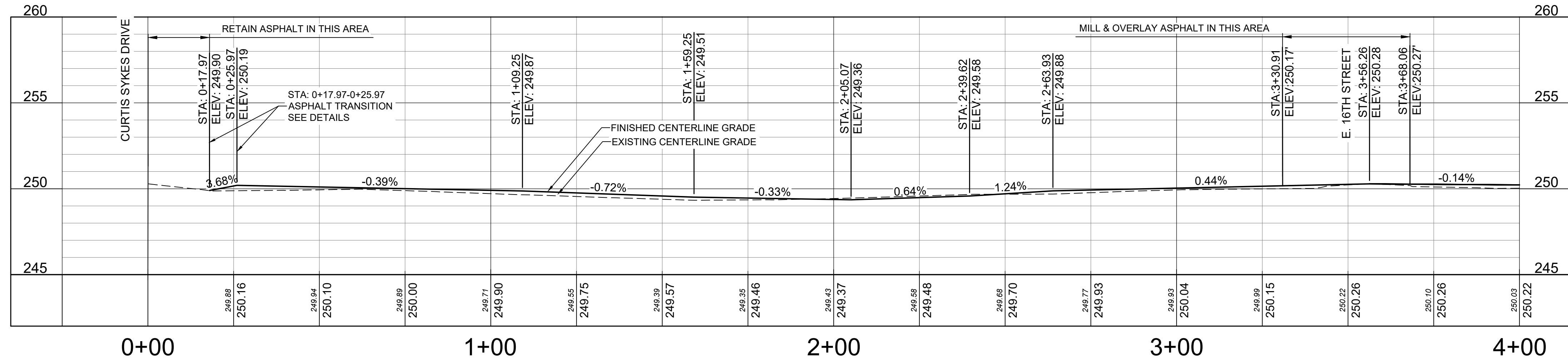
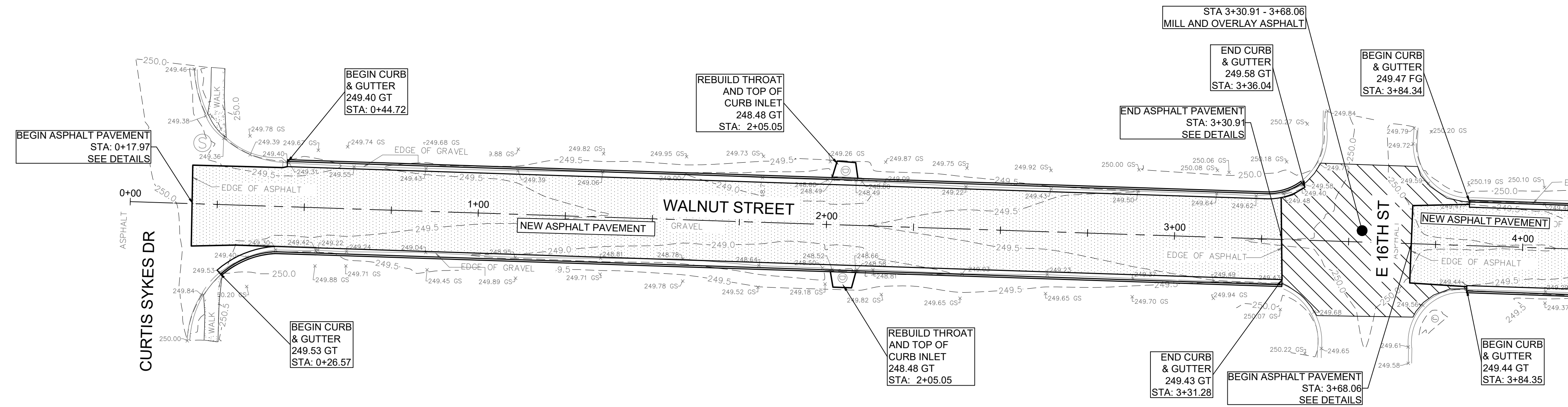

CENTERLINE AND EDGE OF GRAVEL ELEVATIONS BASED ON FIELD INFORMATION RECORDED ON 1/11/21

<p><b>THOMAS ENGINEERING COMPANY</b></p> <p>3810 LOOKOUT ROAD, N. LITTLE ROCK, AR. 72116 TEL: 501-753-4463 FAX: 501-753-6814</p>	<p>WALNUT STREET PROFILE VIEW 15TH STREET TO 17TH STREET NORTH LITTLE ROCK, ARKANSAS</p>		<p>APPROVED</p>	<p>DRAWN BY TRP</p>	<p>DATE 3/19/21</p>	<p>SHEET NO. 1</p>
	<p>SCALE 1" = 20'</p>					

WALNUT DESIGN.dwg

PLOTTED: 3/19/2021

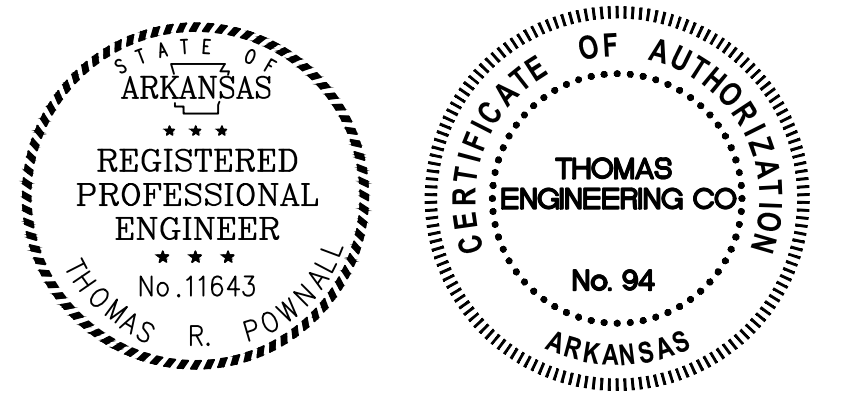
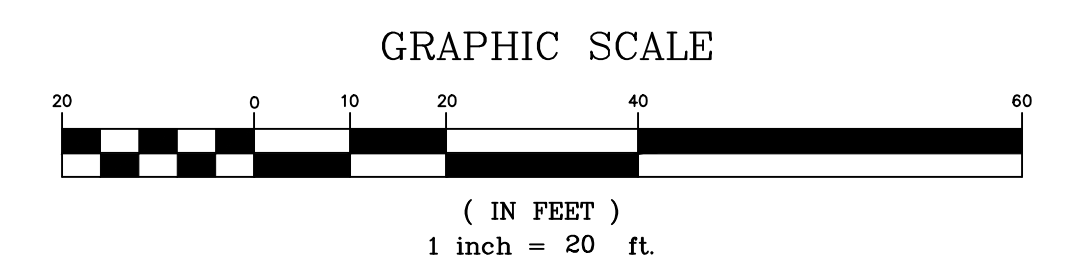
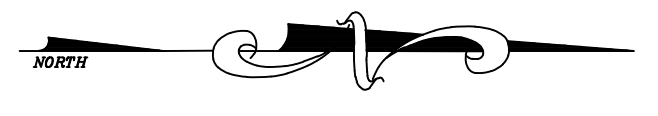
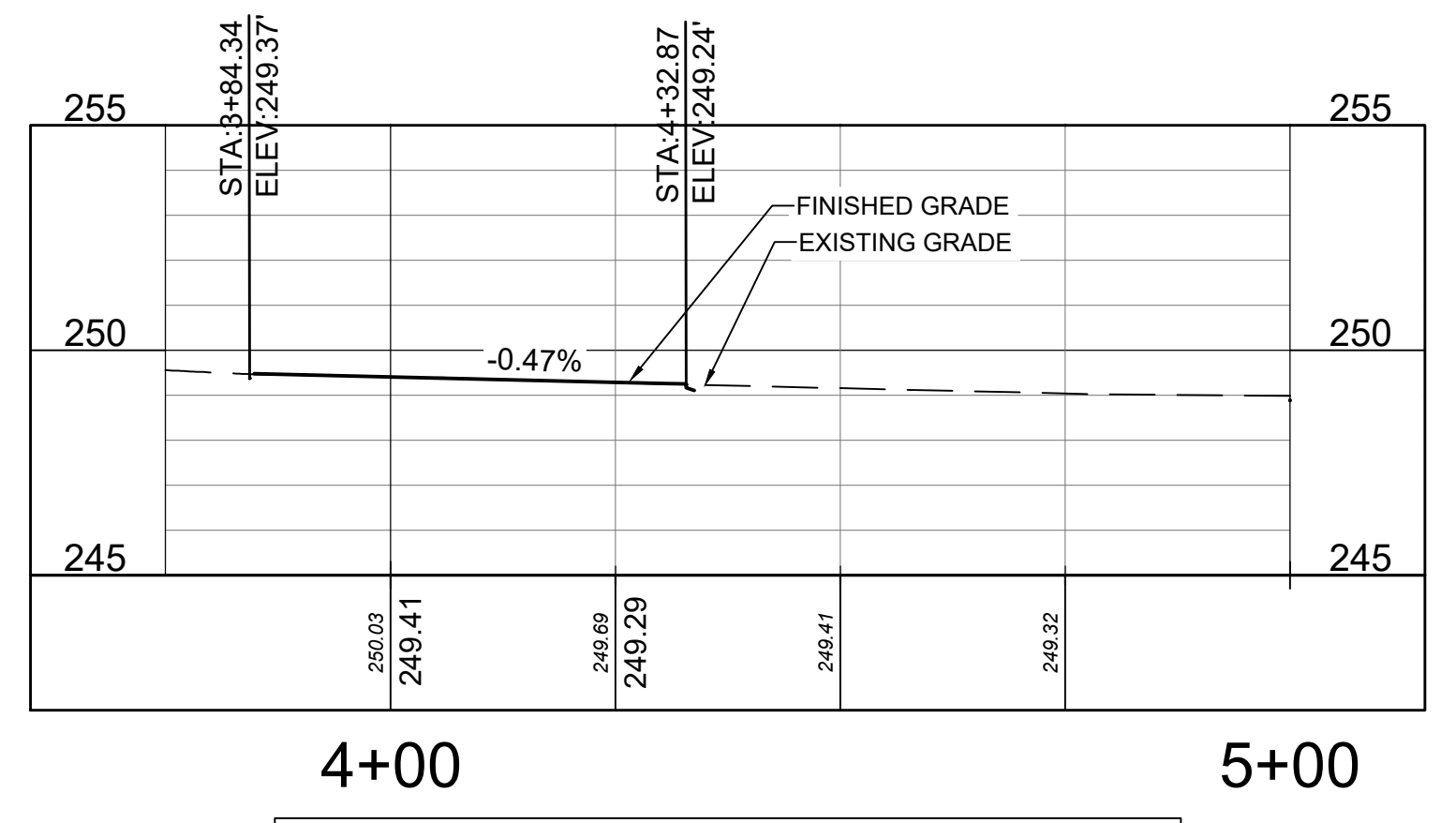
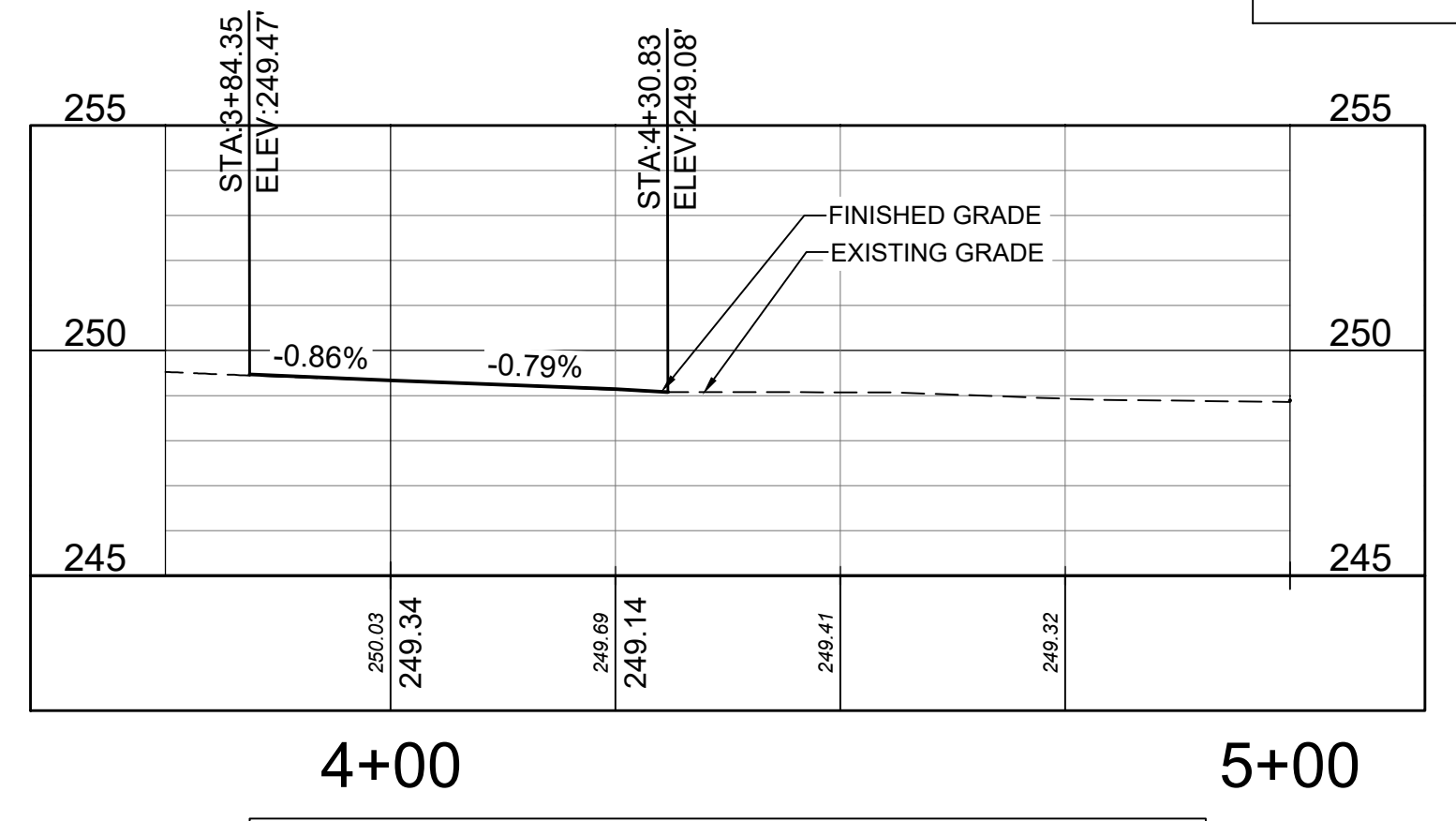
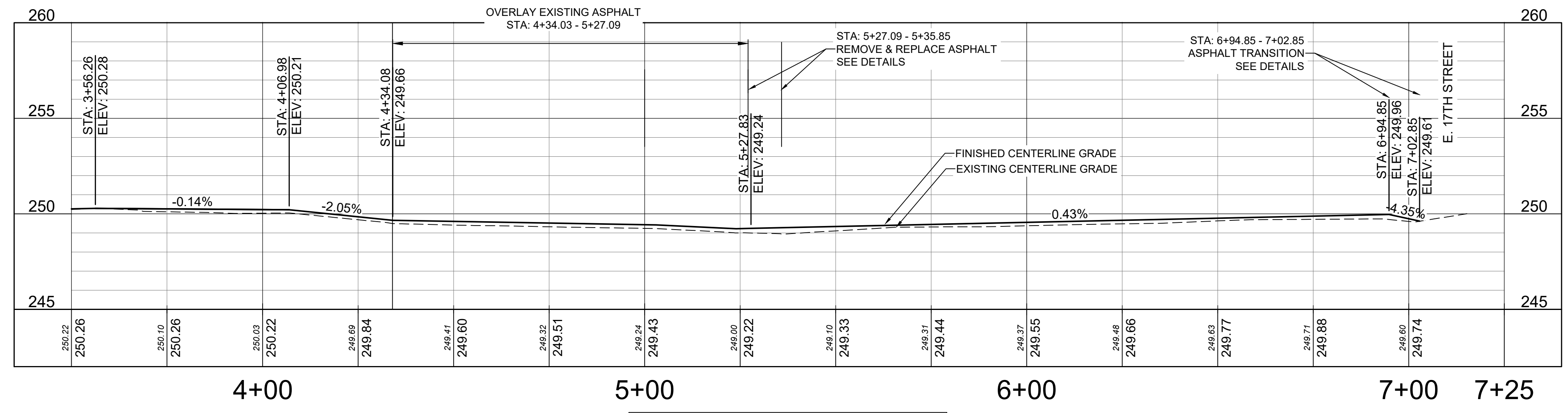
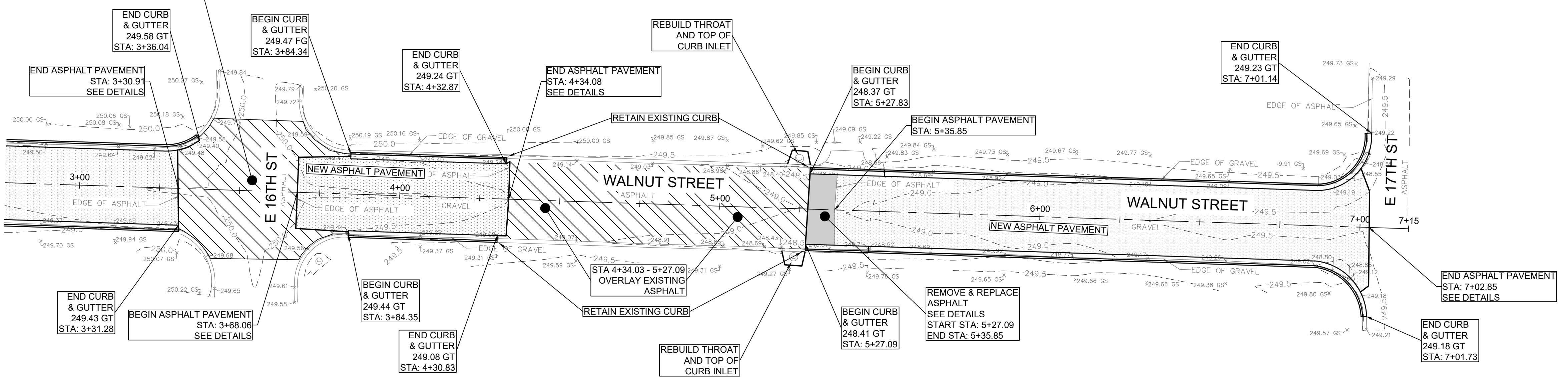

CENTERLINE AND EDGE OF GRAVEL ELEVATIONS BASED ON FIELD INFORMATION RECORDED ON 1/11/21

	<b>WALNUT STREET PROFILE VIEW</b> 15TH STREET TO 17TH STREET NORTH LITTLE ROCK, ARKANSAS			
	APPROVED SCALE 1"=20'	DRAWN BY TRP	DATE 3/19/21	SHEET NO. 2
3810 LOOKOUT ROAD, N. LITTLE ROCK, AR. 72116 TEL: 501-753-4463 FAX: 501-753-6814				

WALNUT DESIGN.dwg

PLOTTED: 3/19/2021

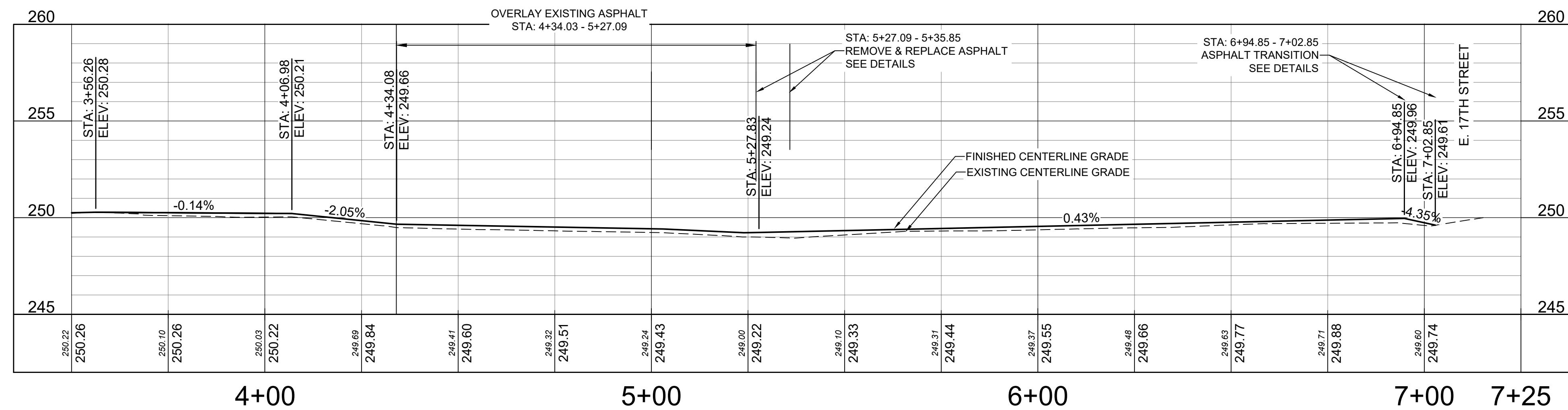
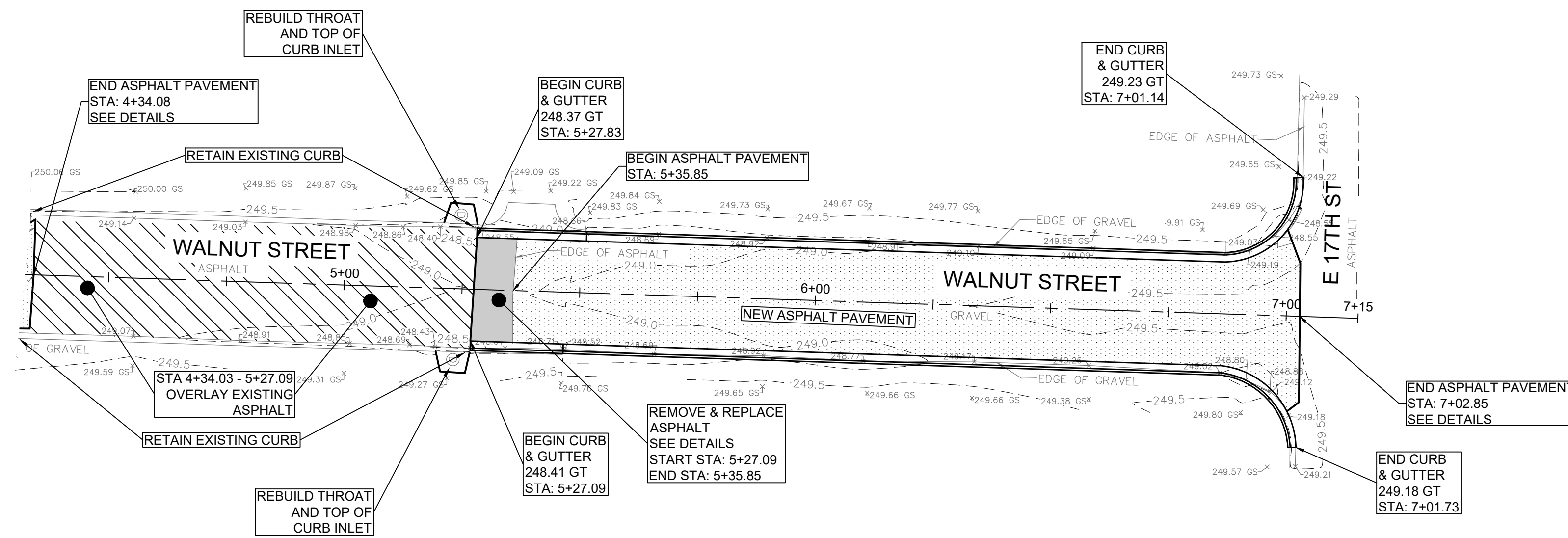

WALNUT STREET 2

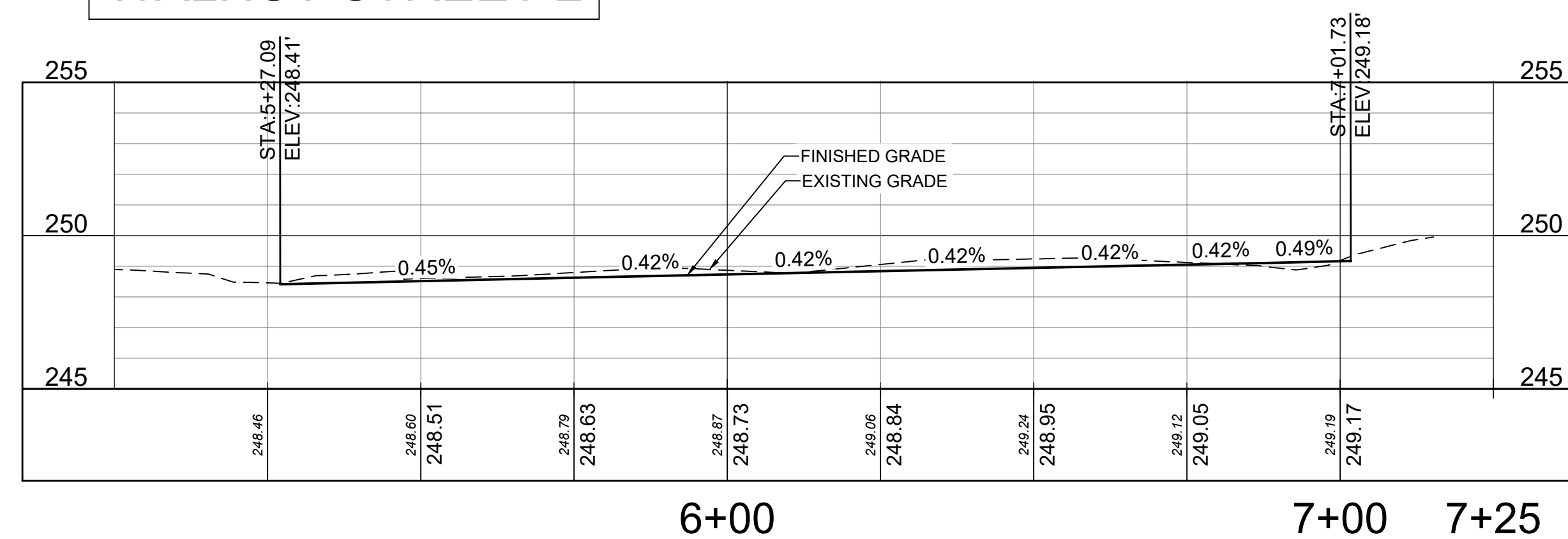

WALNUT GUTTER RIGHT

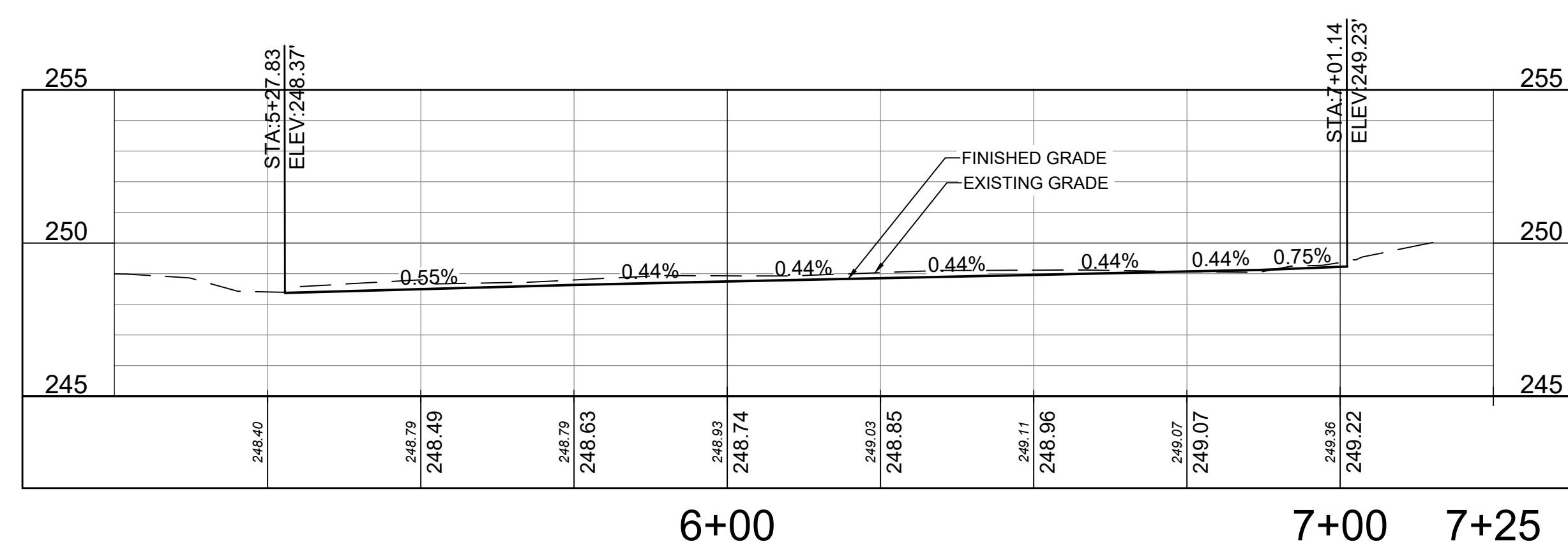

WALNUT GUTTER LEFT

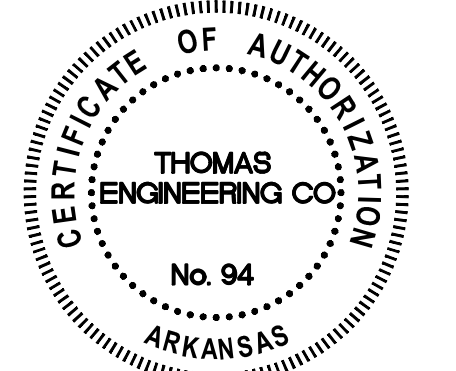
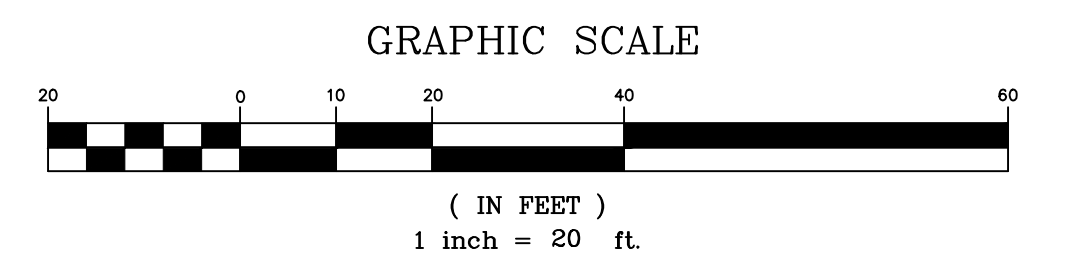

CENTERLINE AND EDGE OF GRAVEL ELEVATIONS BASED ON FIELD INFORMATION RECORDED ON 1/11/21



THOMAS ENGINEERING COMPANY

WALNUT STREET  
PROFILE VIEW  
15TH STREET TO 17TH STREET  
NORTH LITTLE ROCK, ARKANSAS

3810 LOOKOUT ROAD, N. LITTLE ROCK, AR. 72116  
TEL: 501-753-4463 FAX: 501-753-6814

APPROVED	DRAWN BY TRP	DATE 3/19/21	SHEET NO. 3
SCALE 1" = 20'			

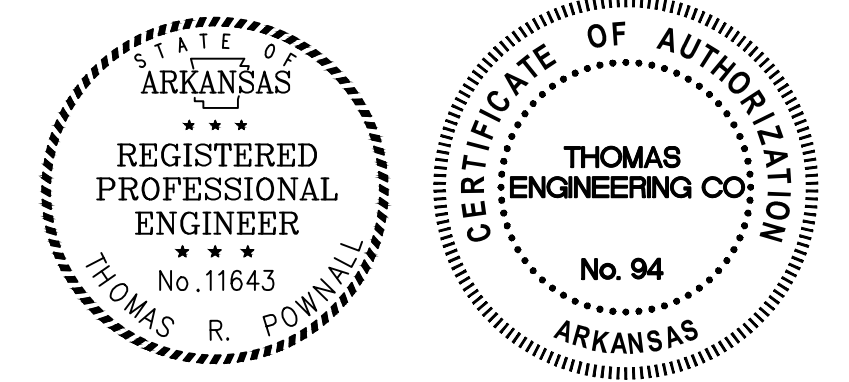
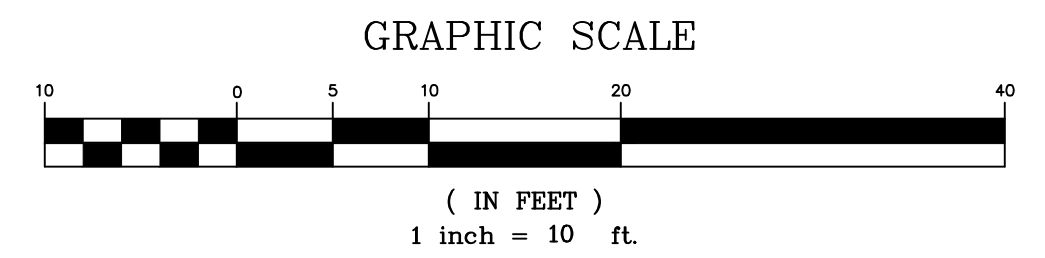
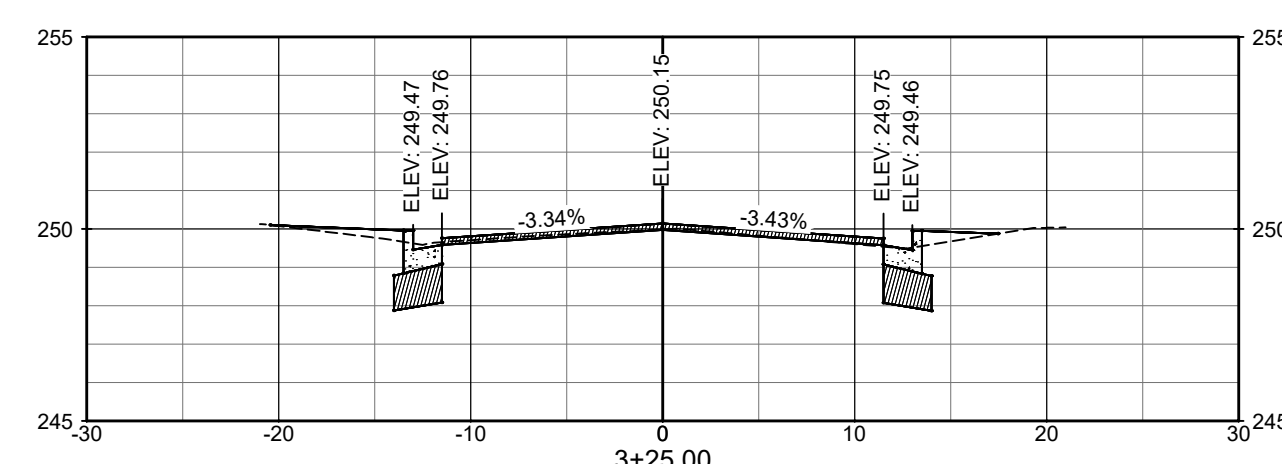
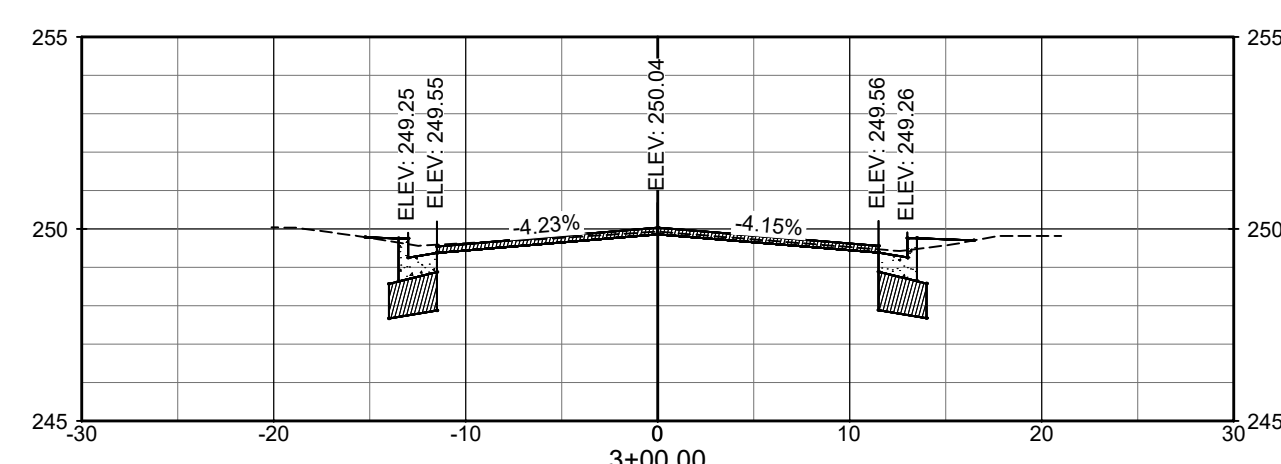
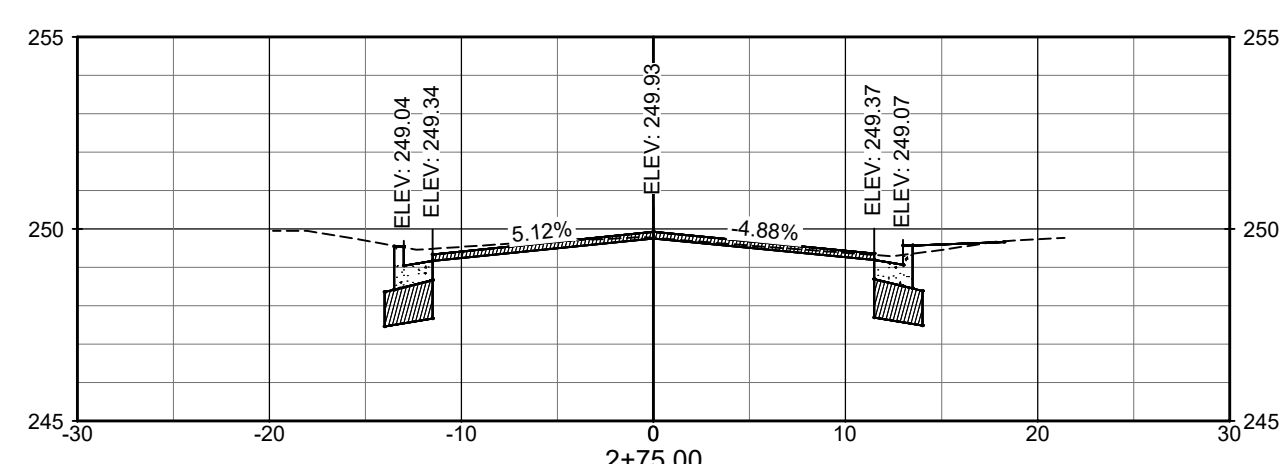
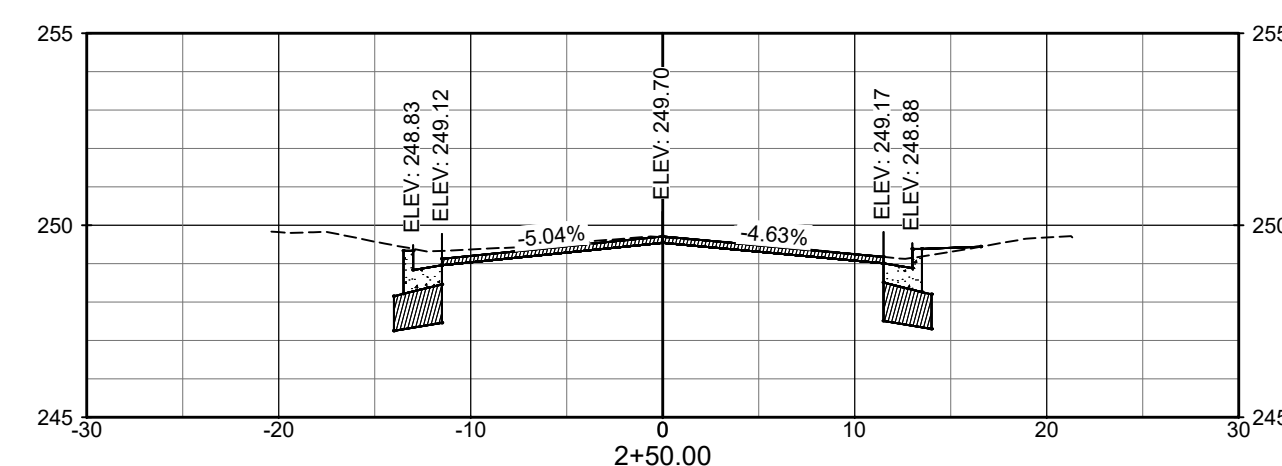
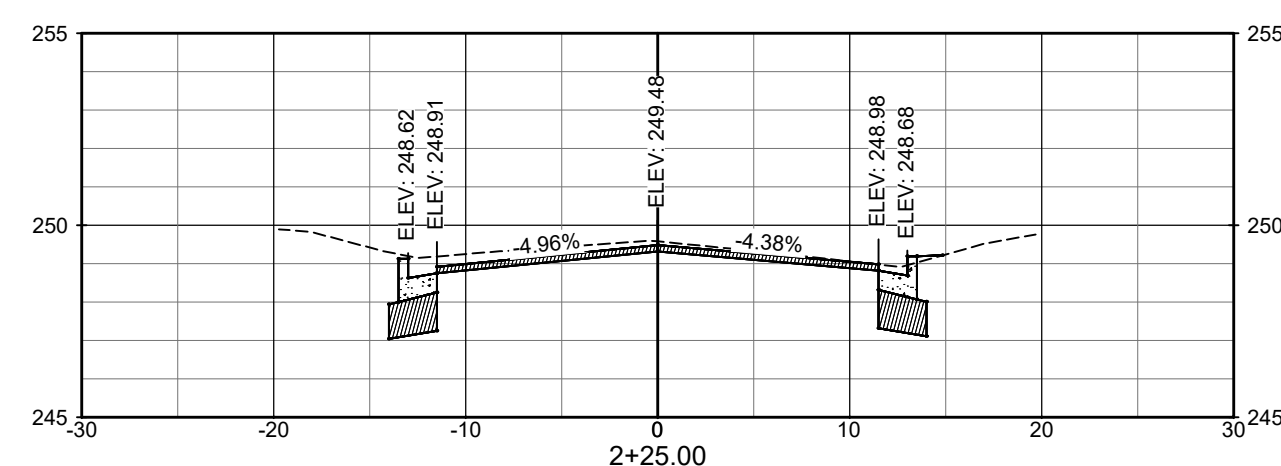
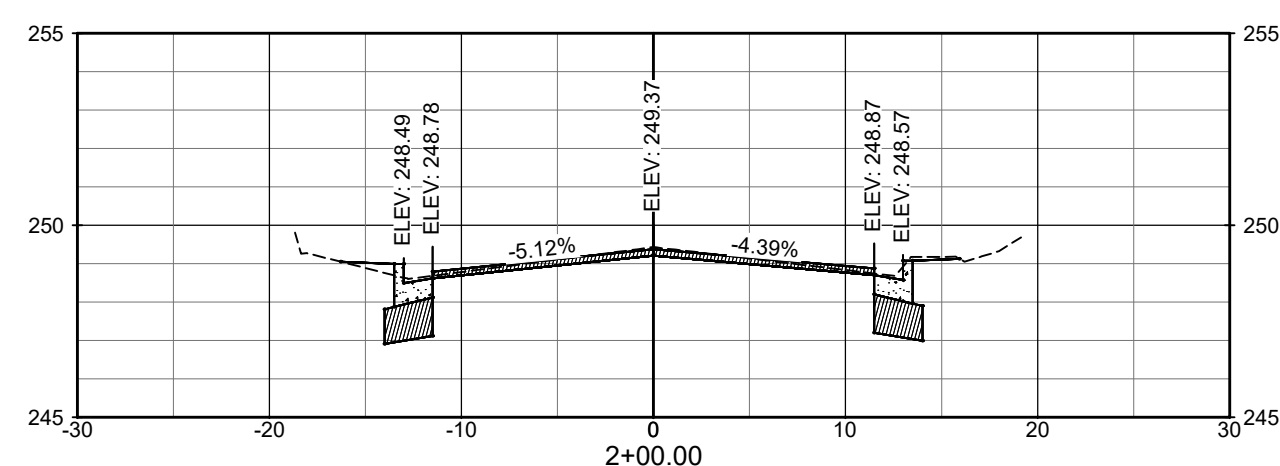
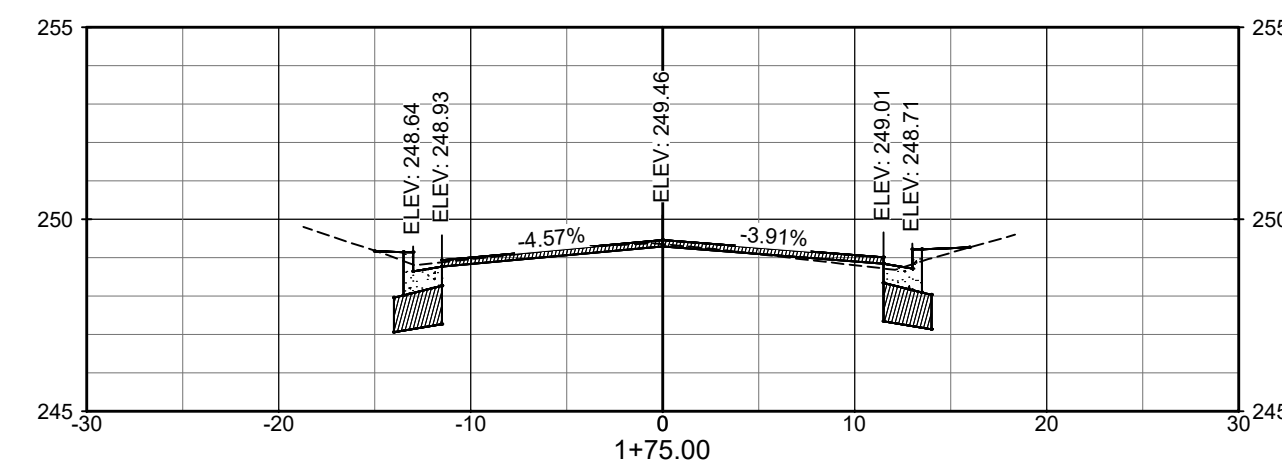
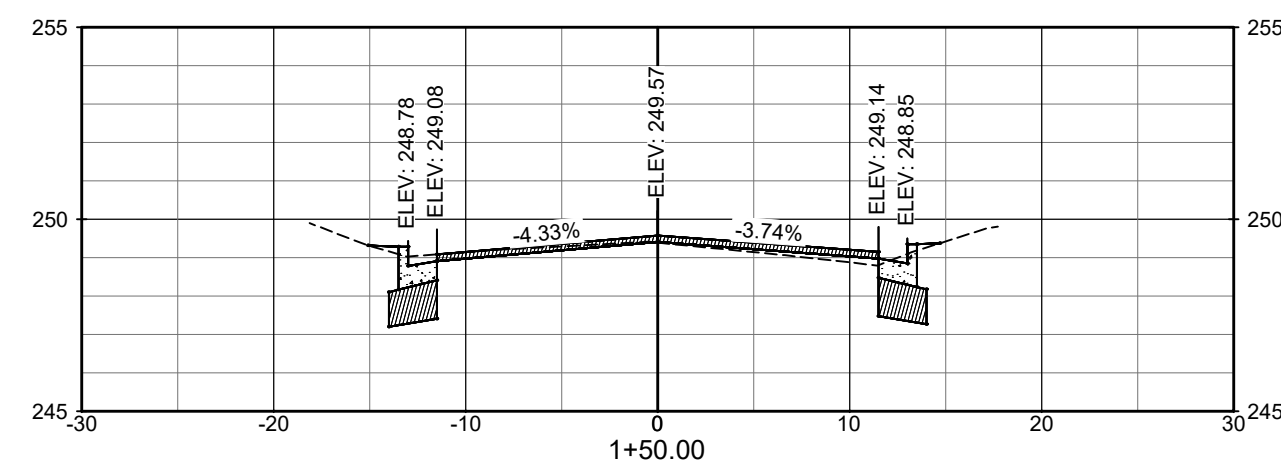
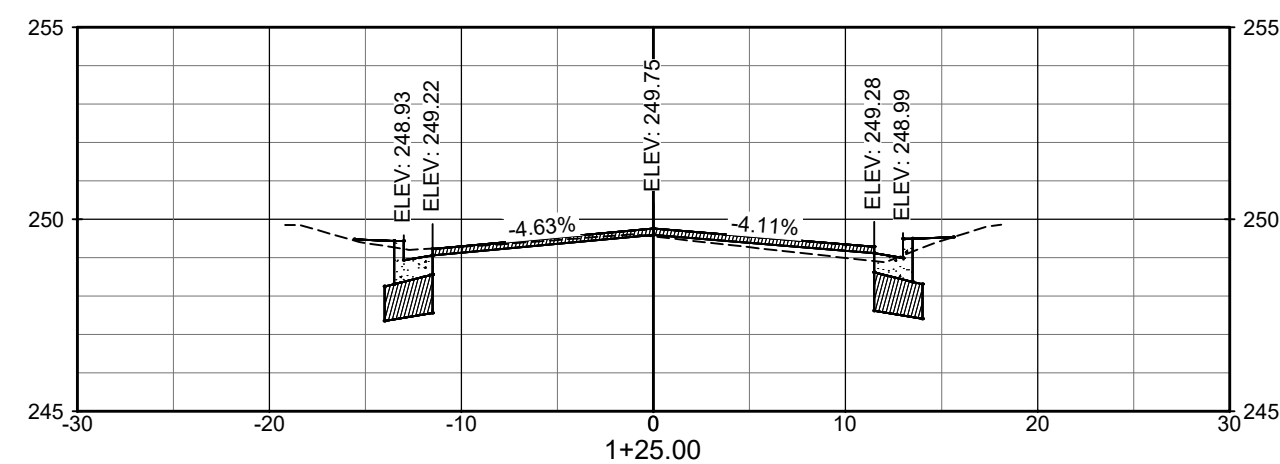
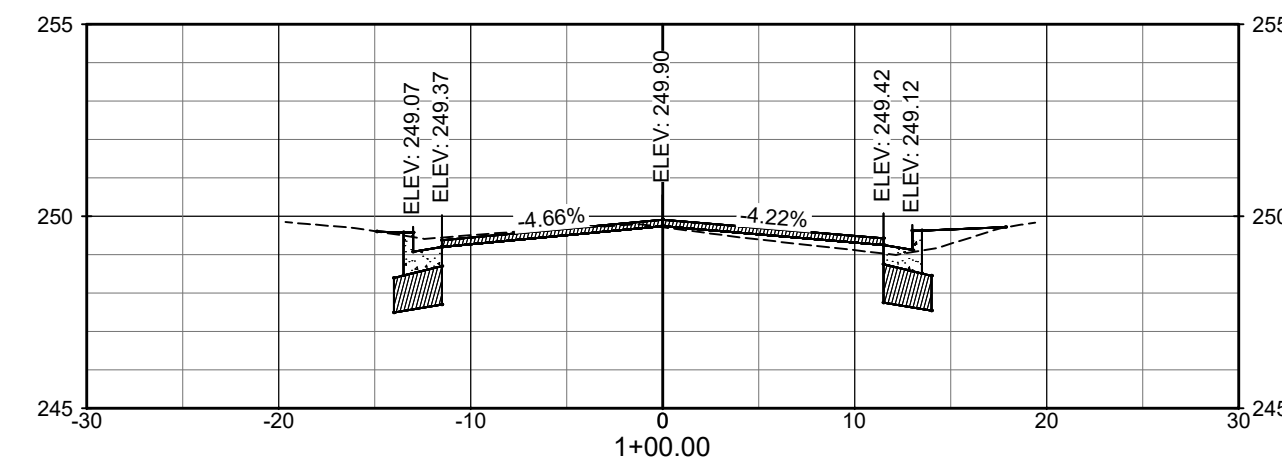
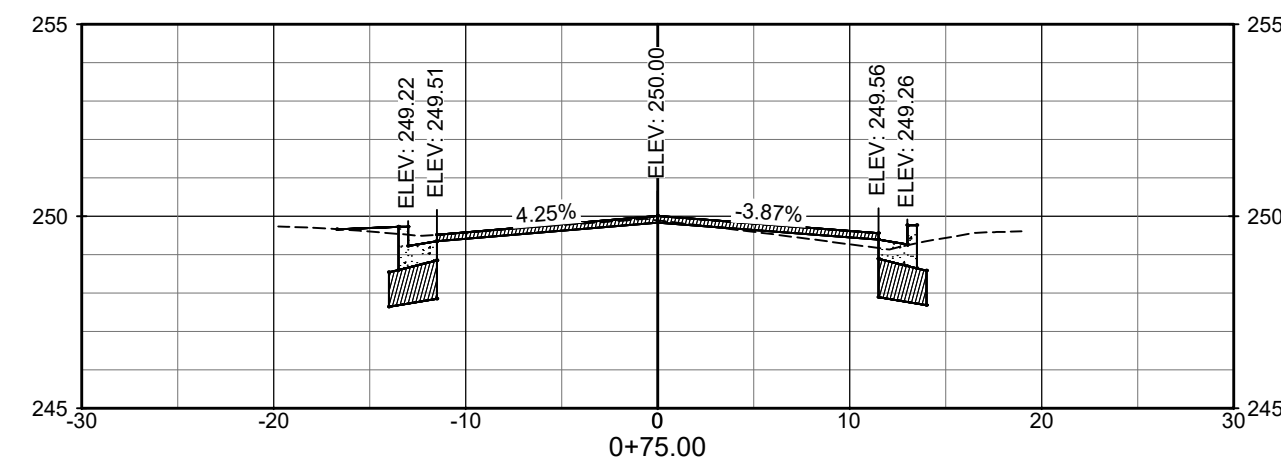
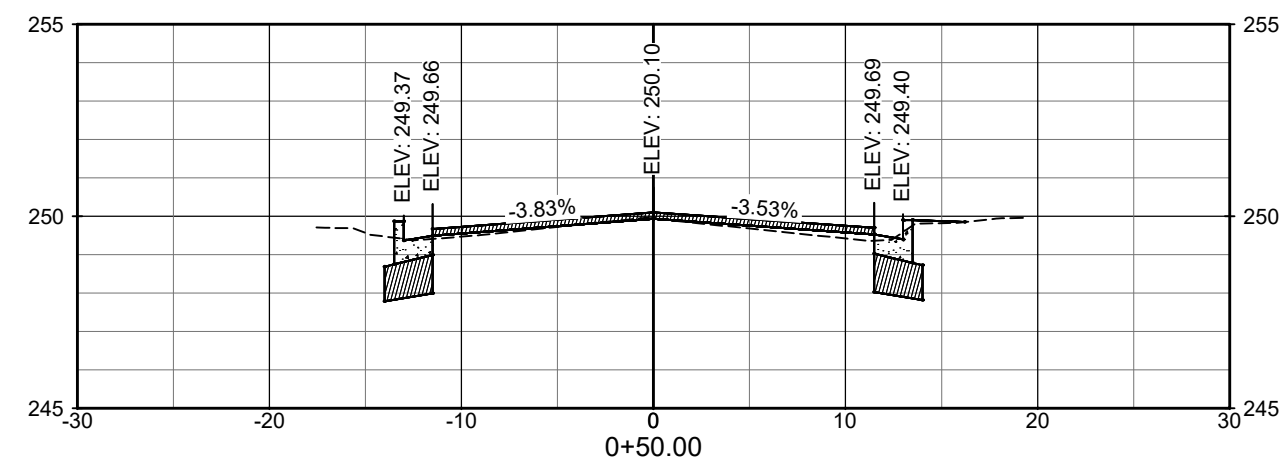
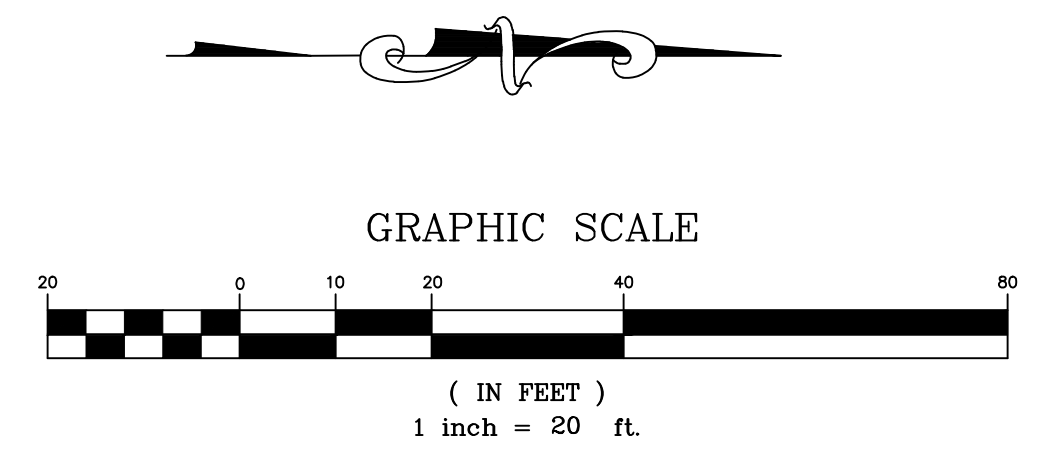
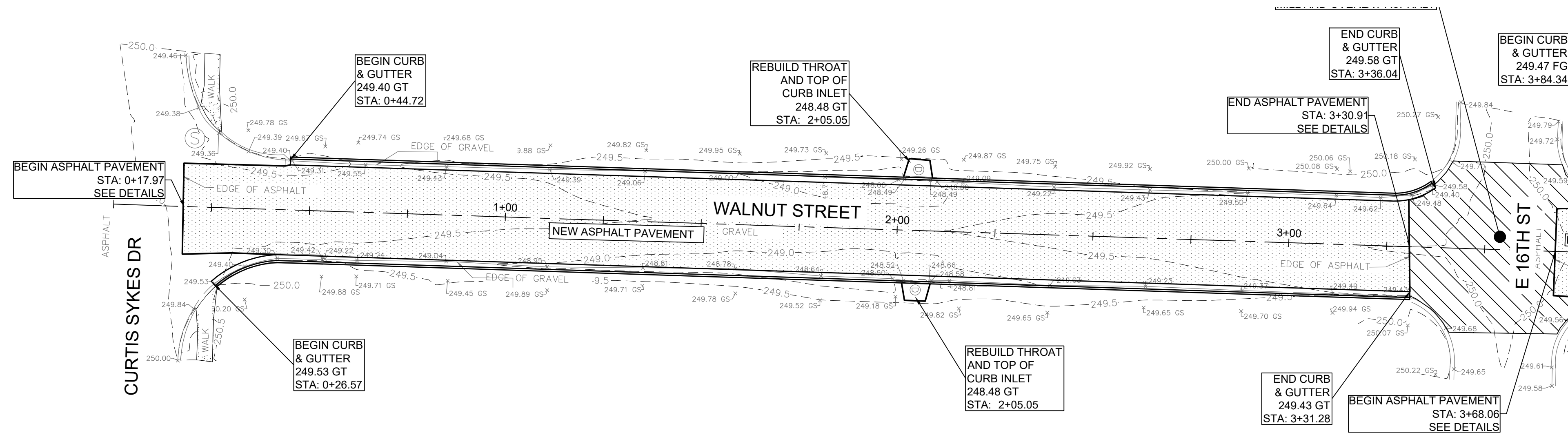

<p><b>THOMAS ENGINEERING COMPANY</b> 3810 LOOKOUT ROAD, N. LITTLE ROCK, AR. 72116 TEL: 501-753-4463 FAX: 501-753-6814</p>	<p>WALNUT STREET SECTION VIEW 15TH STREET TO 17TH STREET NORTH LITTLE ROCK, ARKANSAS</p>		
	<p>APPROVED TRP</p>	<p>DRAWN BY TRP</p>	<p>DATE 3/19/21</p>

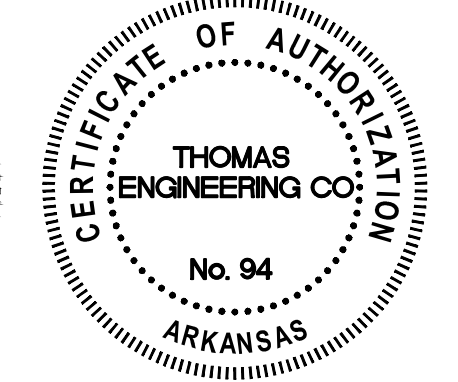
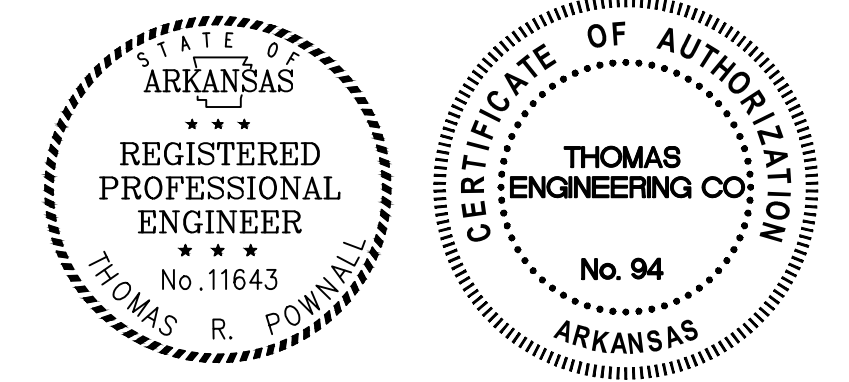
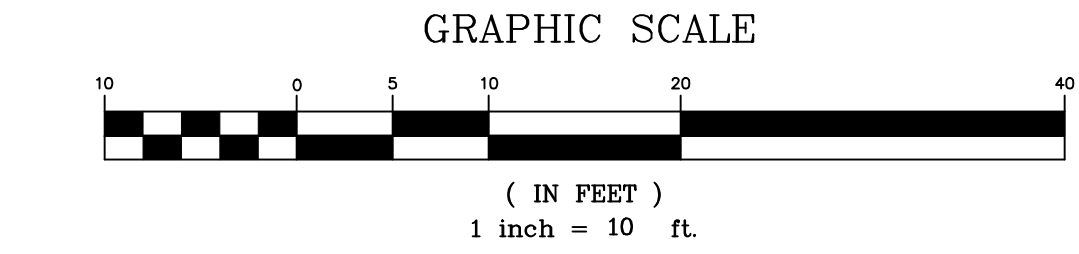
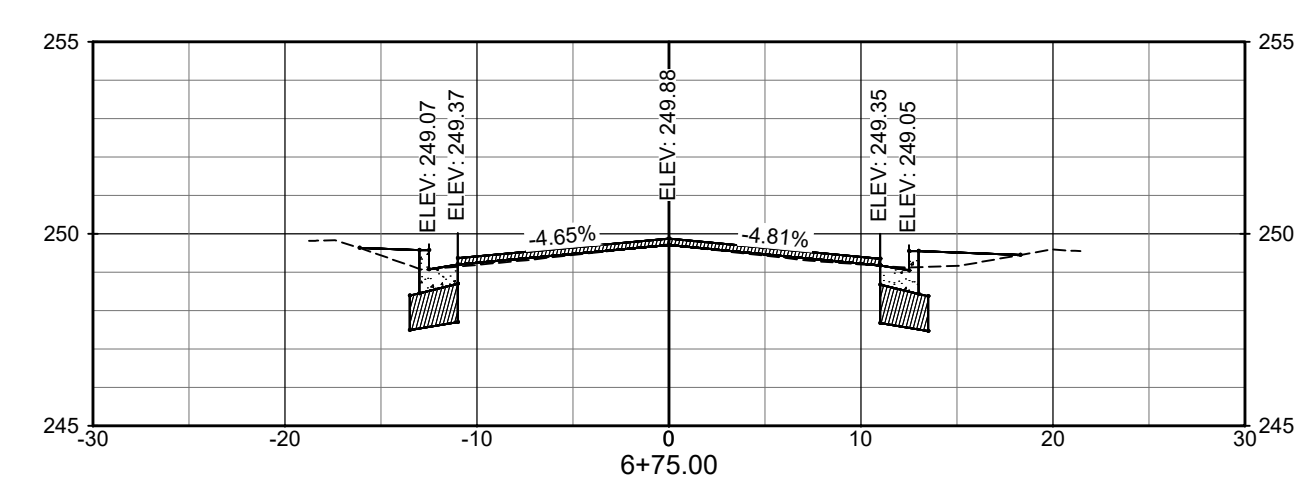
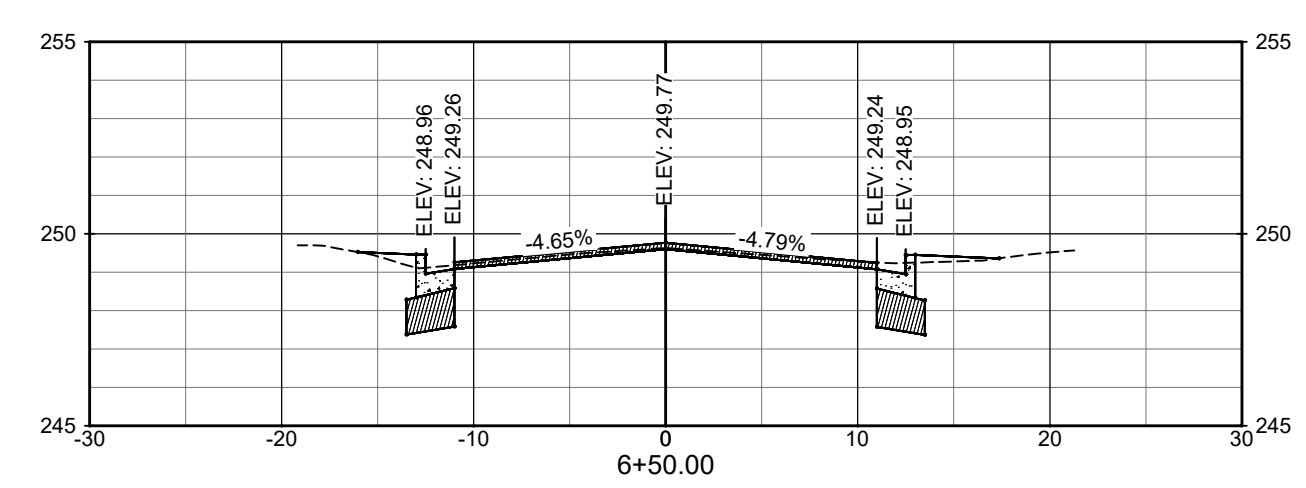
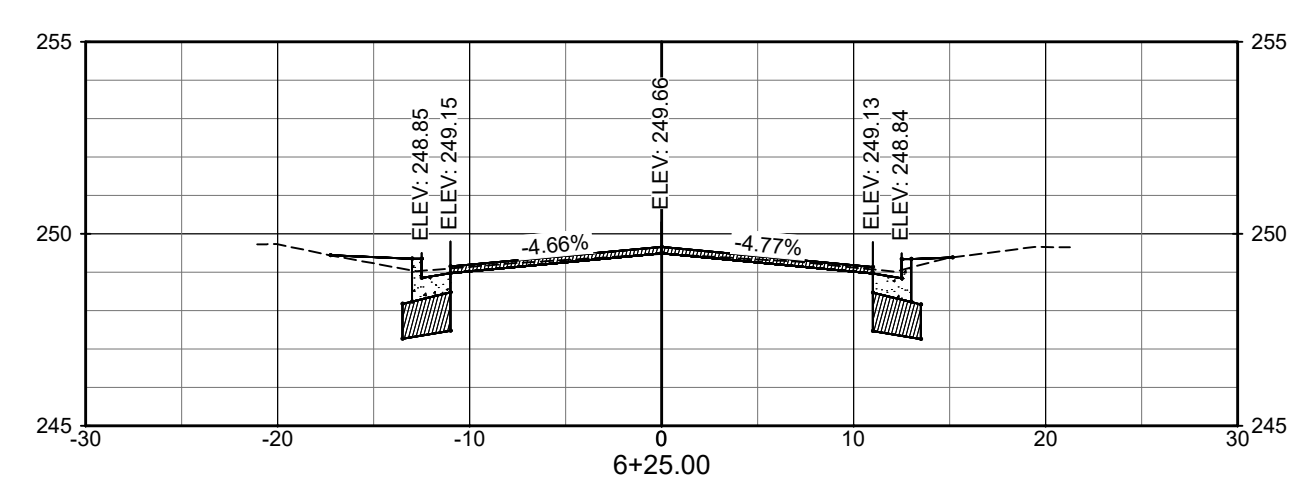
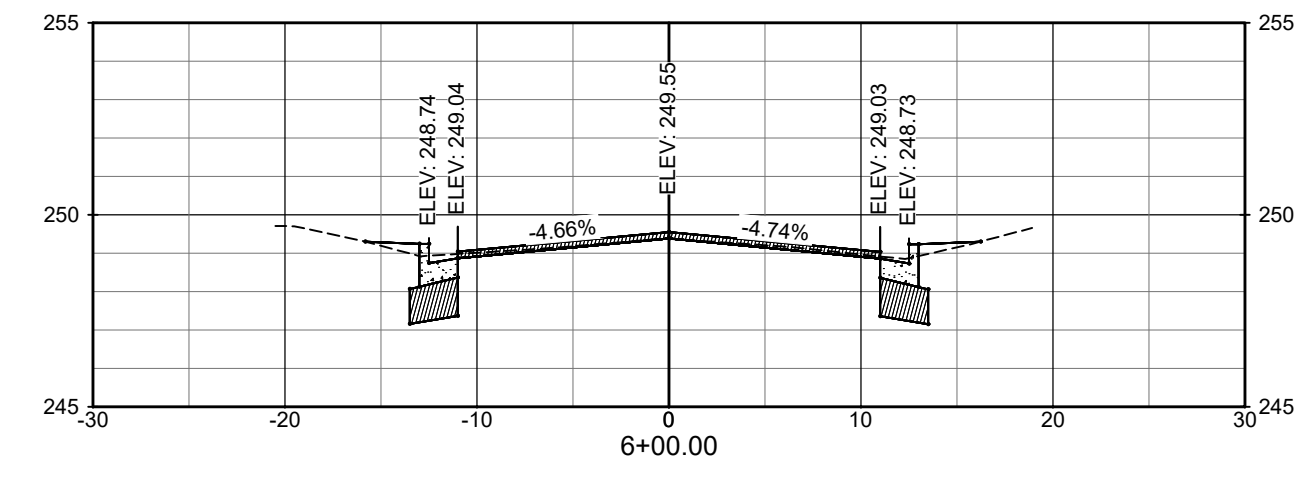
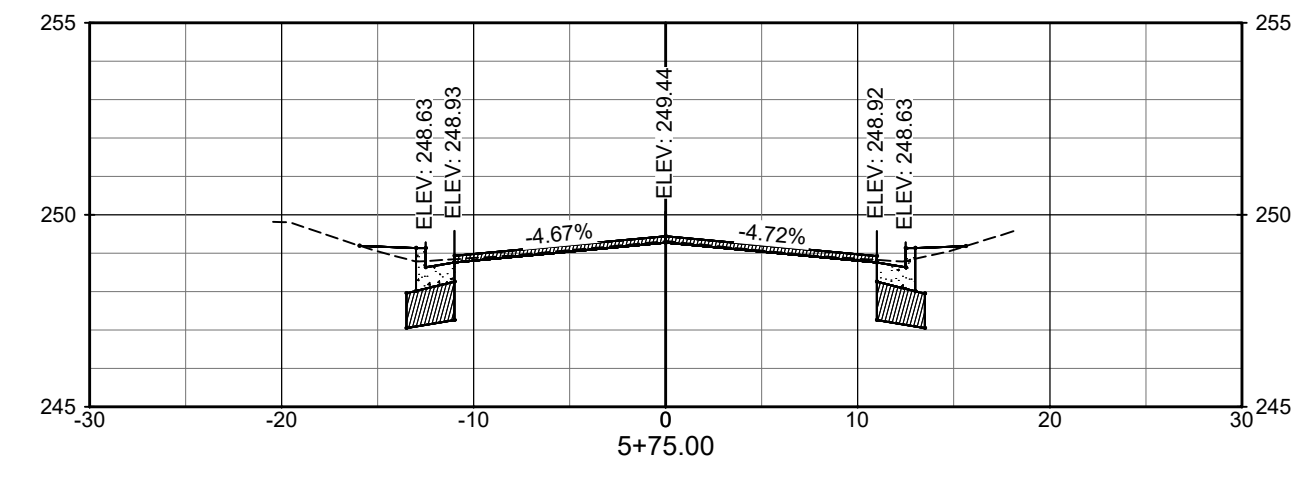
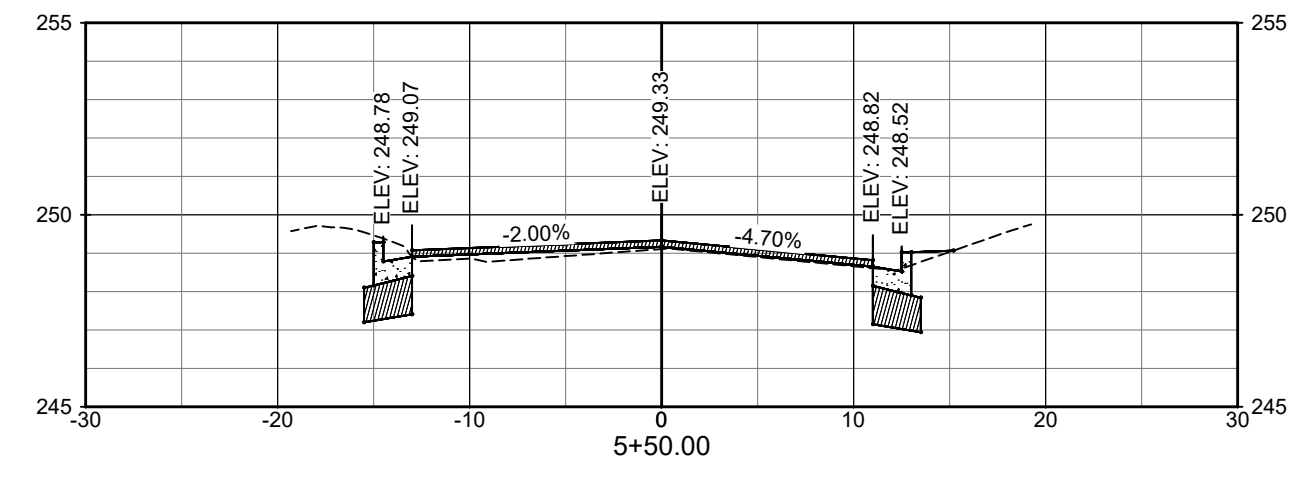
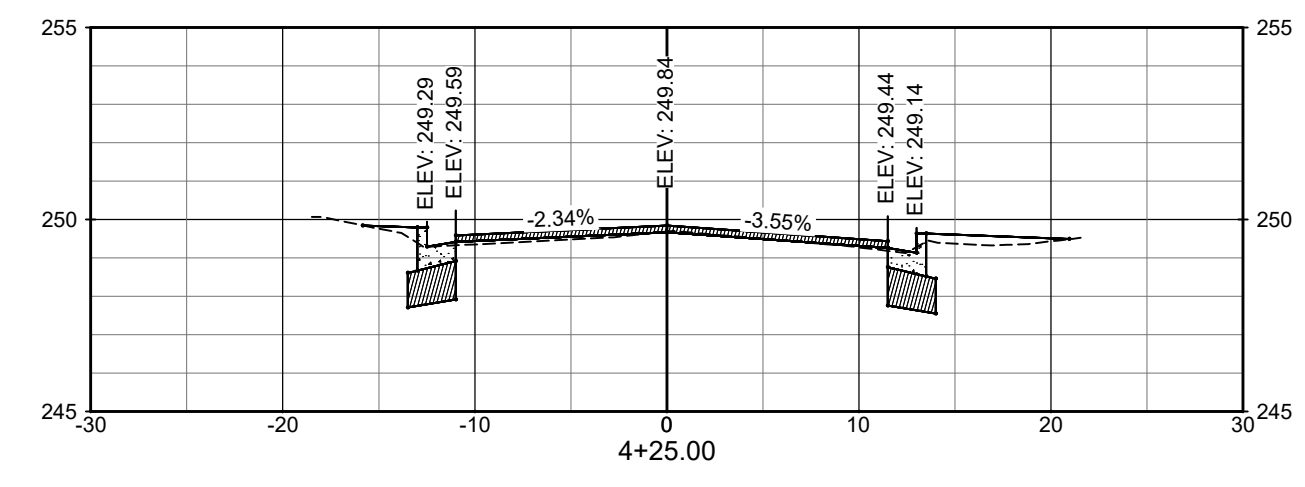
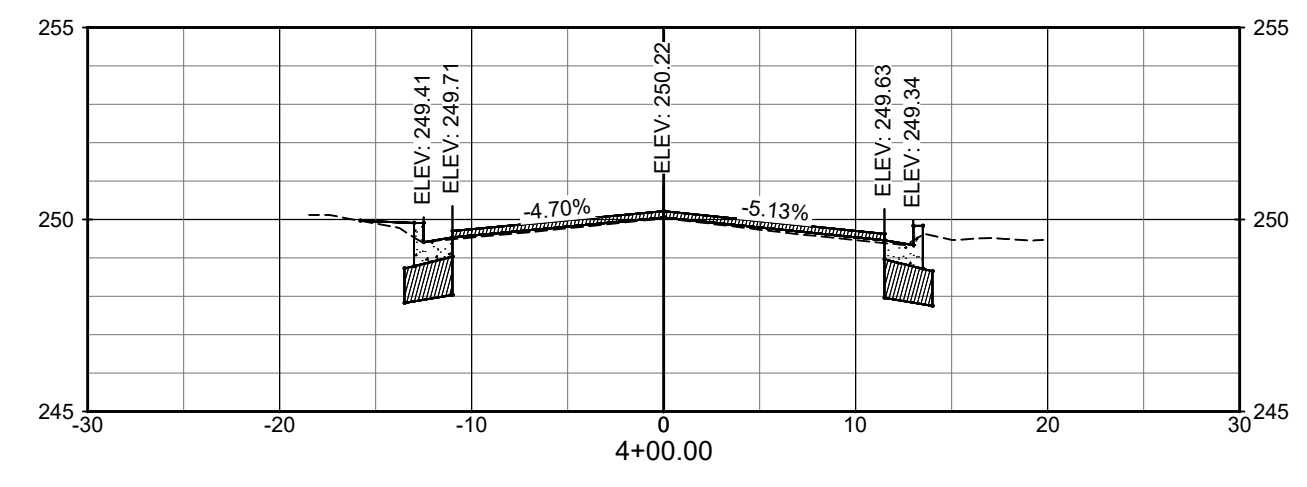
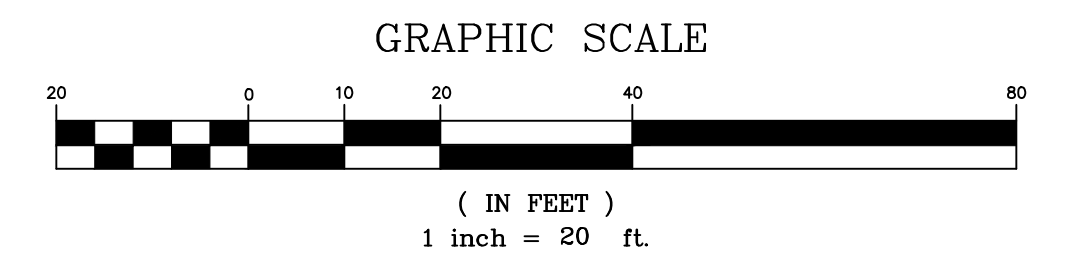
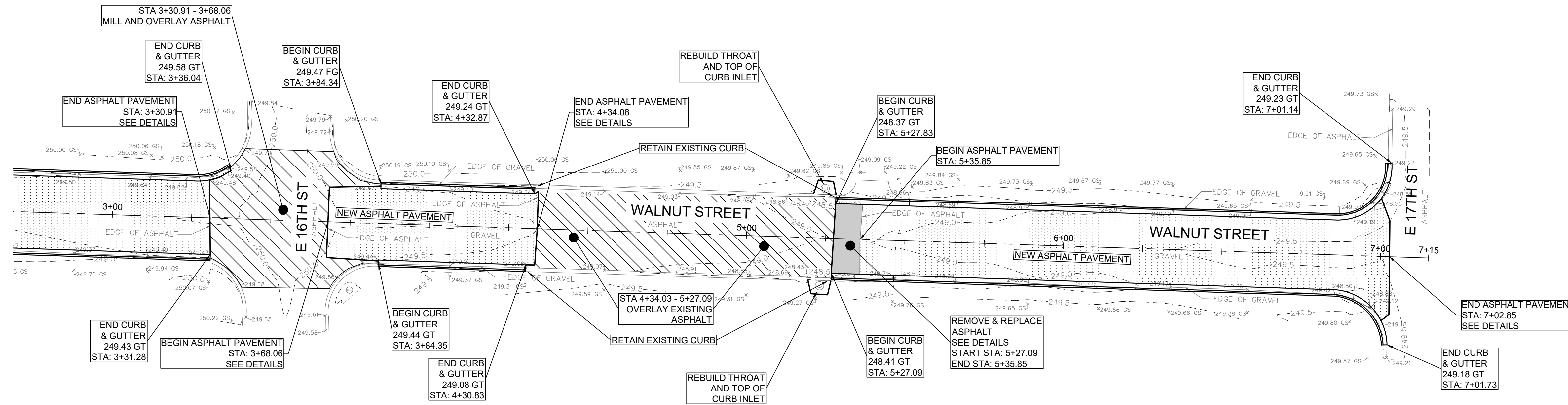

<b>THOMAS ENGINEERING COMPANY</b>				<b>WALNUT STREET SECTION VIEW</b> 15TH STREET TO 17TH STREET NORTH LITTLE ROCK, ARKANSAS			
3810 LOOKOUT ROAD, N. LITTLE ROCK, AR. 72116		TEL: 501-753-4463		FAX: 501-753-6814			
SCALE 1"=20' [FOR PROFILE]		SCALE 1"=10' [FOR SECTIONS]		<b>5</b>			



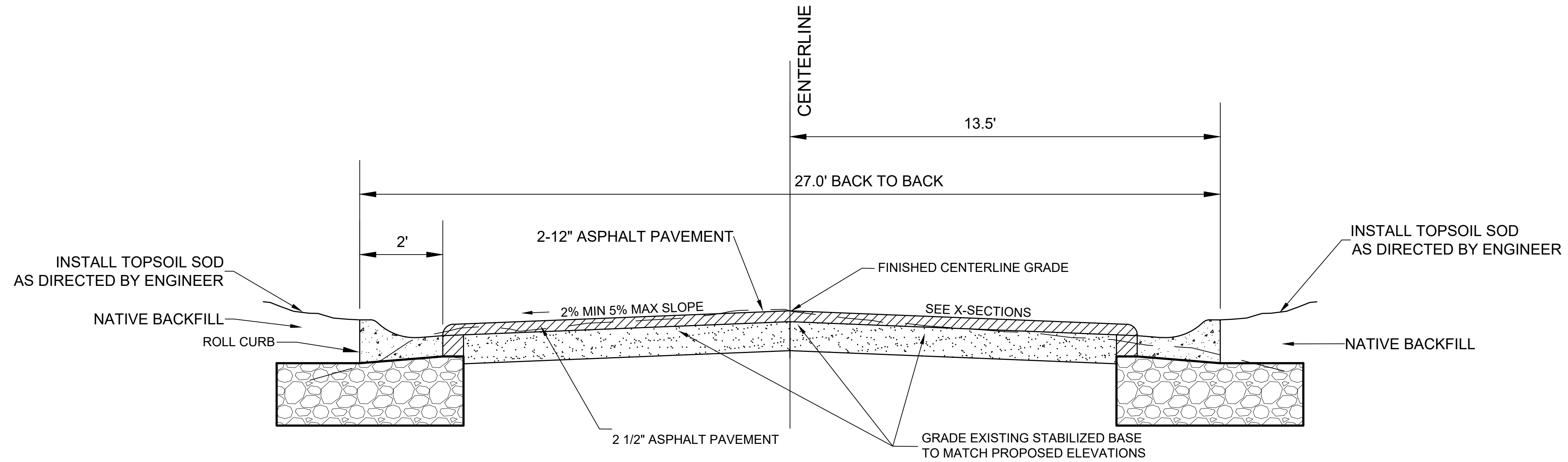

**TYPICAL SECTION  
WALNUT STREET**

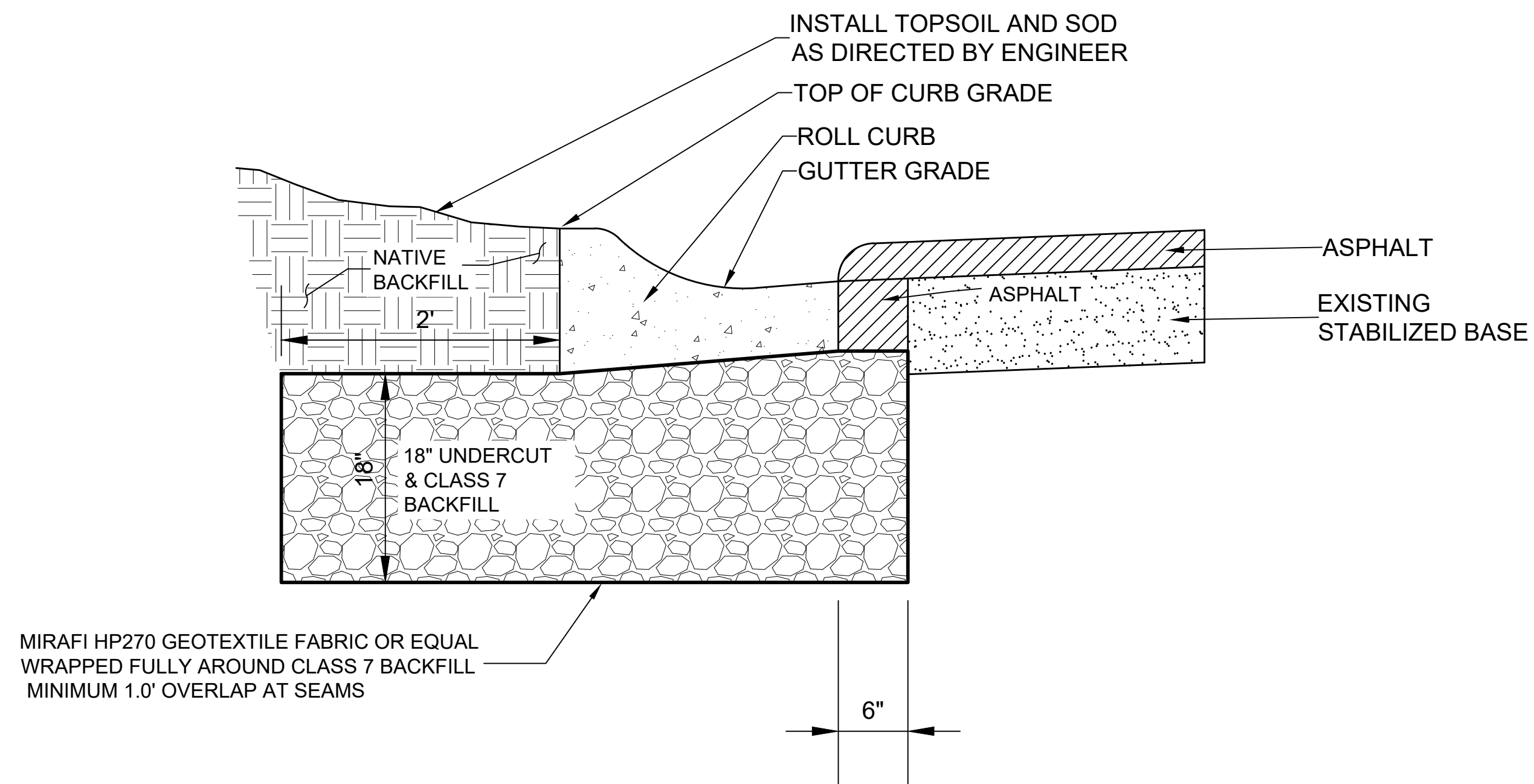

**TYPICAL SECTION  
CURB & GUTTER UNDERCUT**

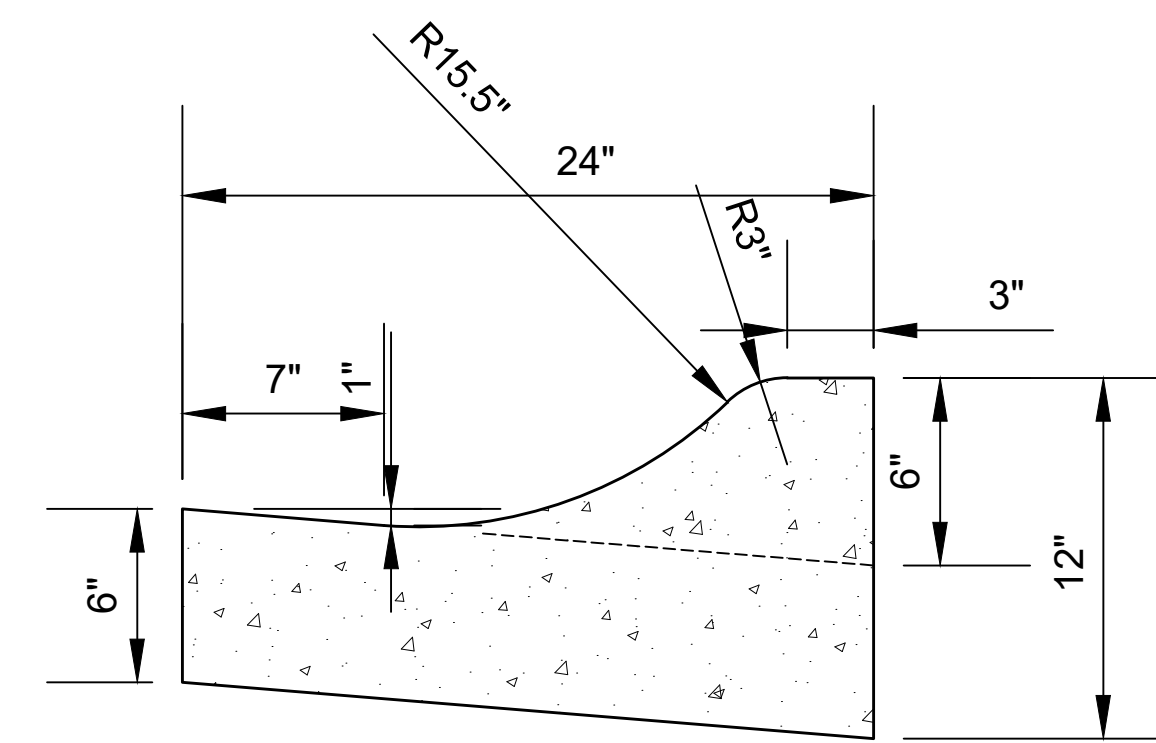

**6" ROLL CURB DETAIL**

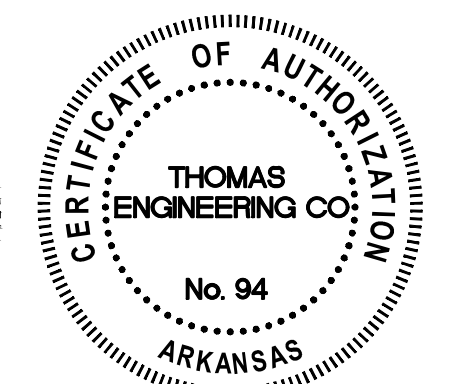

<p>THOMAS ENGINEERING COMPANY</p> <p>3810 LOOKOUT ROAD, N. LITTLE ROCK, AR. 72116 TEL: 501-753-4463 FAX: 501-753-6814</p>	<p>WALNUT STREET DETAILS 15TH STREET TO 17TH STREET NORTH LITTLE ROCK, ARKANSAS</p>			
	<p>APPROVED</p> <p>SCALE: N.T.S.</p>	<p>DRAWN BY</p> <p>TRP</p>	<p>DATE</p> <p>3/19/21</p>	<p>SHEET NO.</p> <p>6</p>

WALNUT DESIGN.dwg

PLOTTED: 3/19/2021

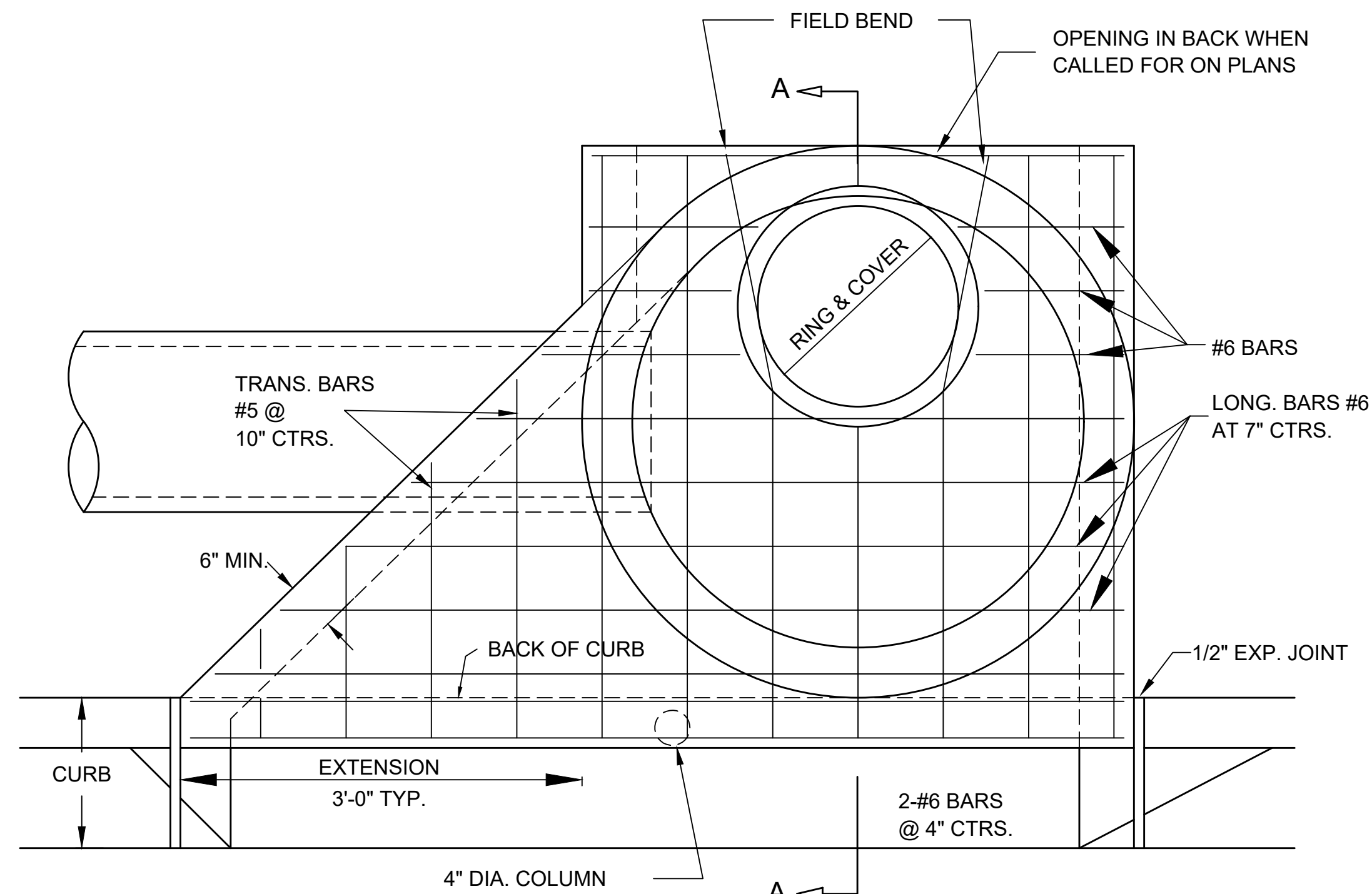

**CURB INLET  
PLAN - W/SINGLE EXTENSION**

NOTE: FOR DOUBLE EXTENSION USE SINGLE ON BOTH SIDES

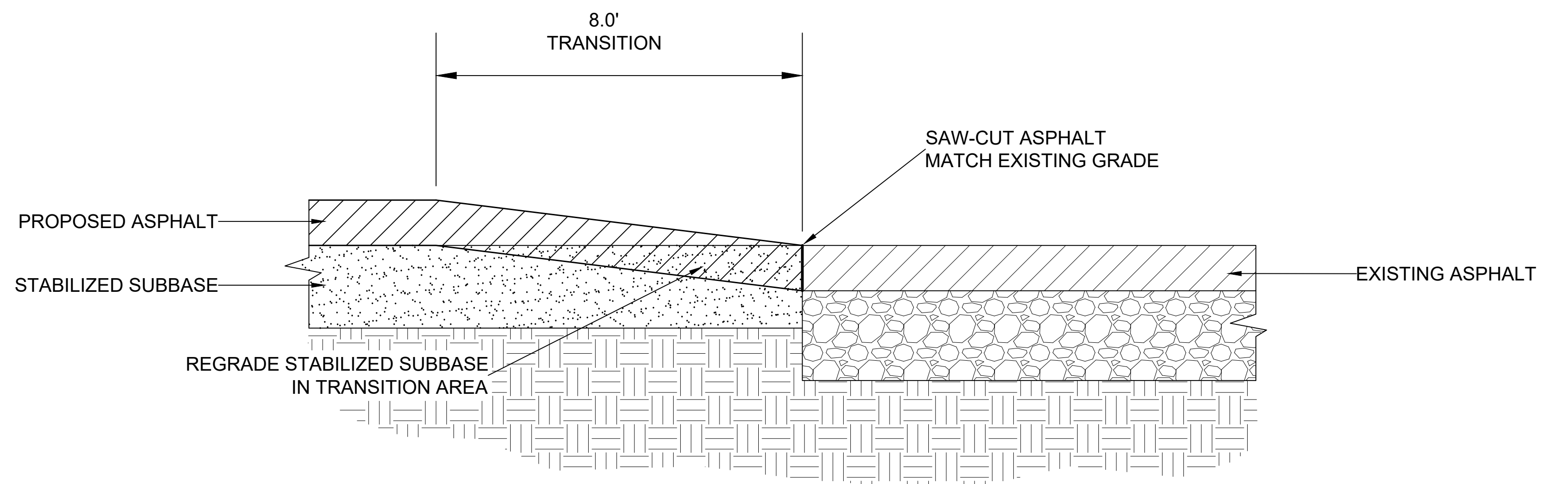

**TYPICAL SECTION  
ASPHALT TRANSITION**

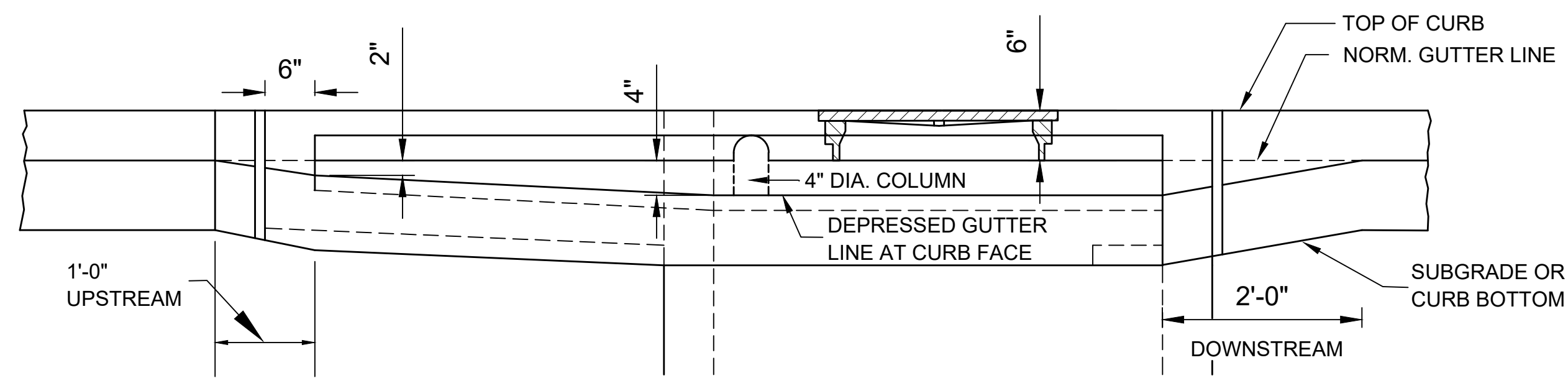

**FRONT ELEVATION**

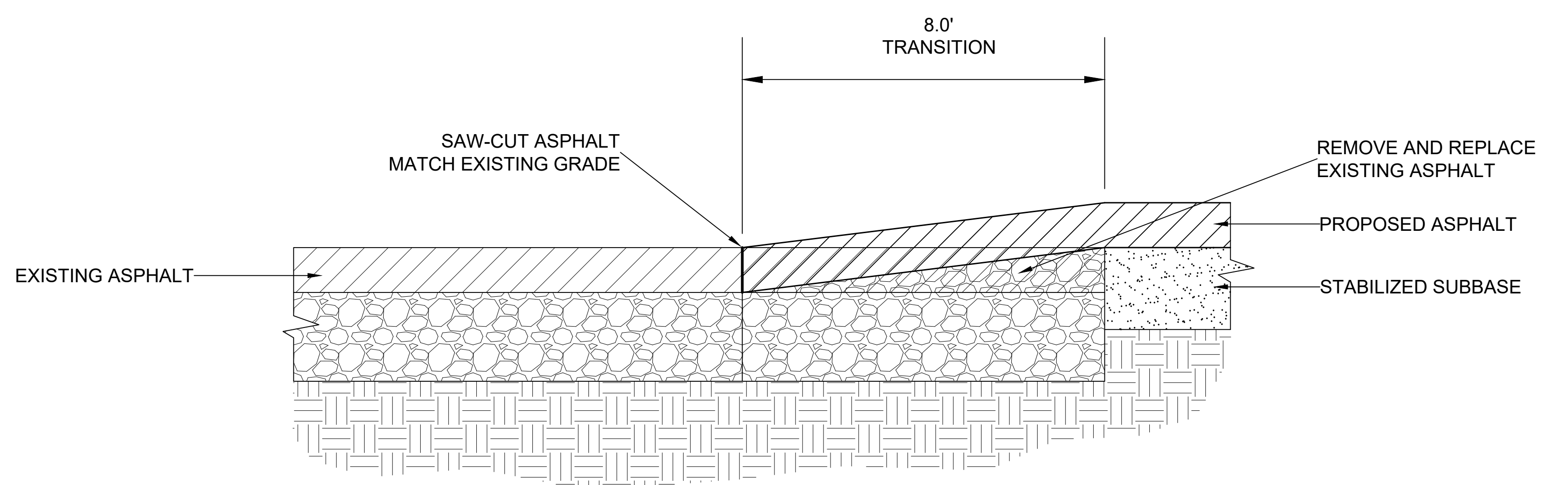

**TYPICAL SECTION  
ASPHALT RECONSTRUCTION**

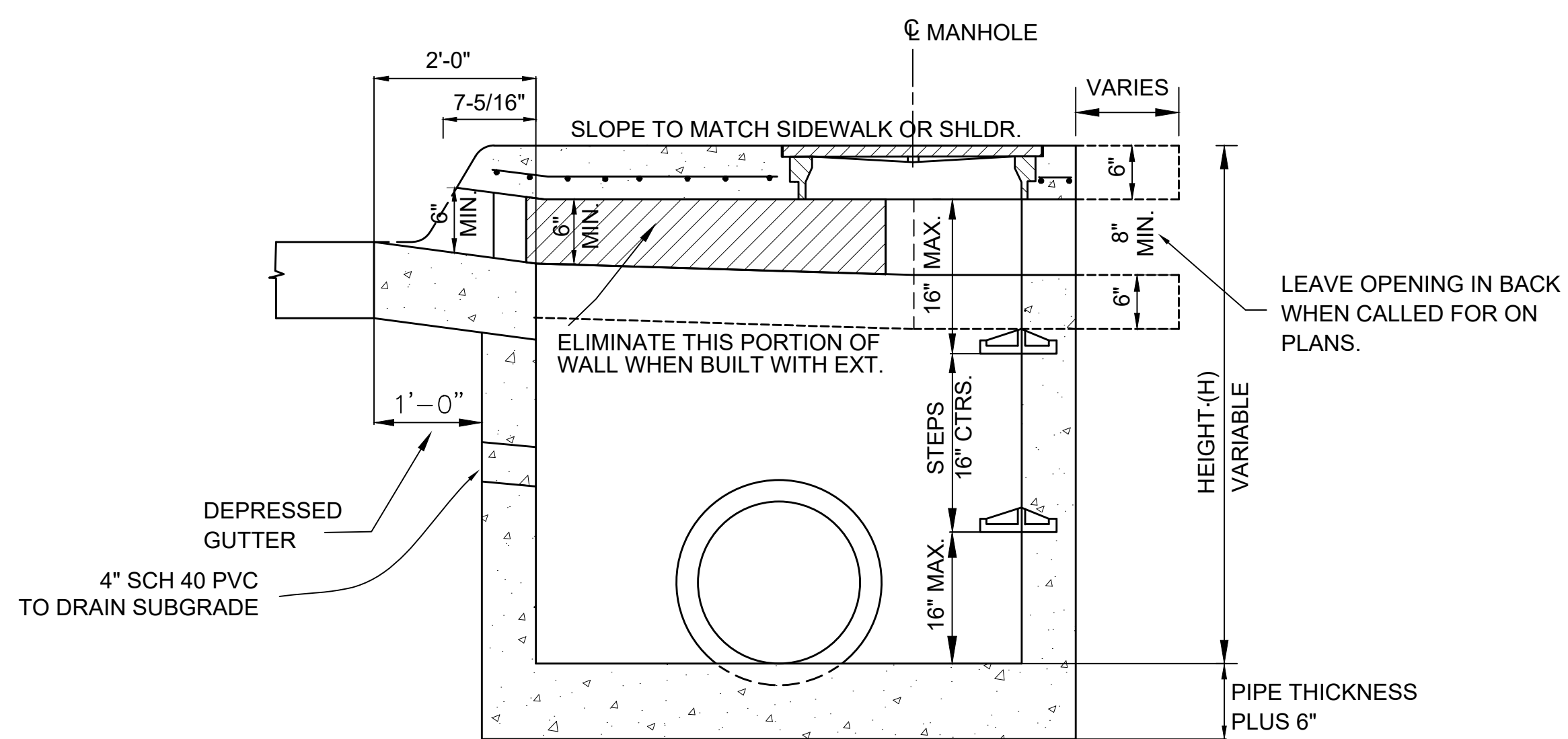

**SECTION A-A**

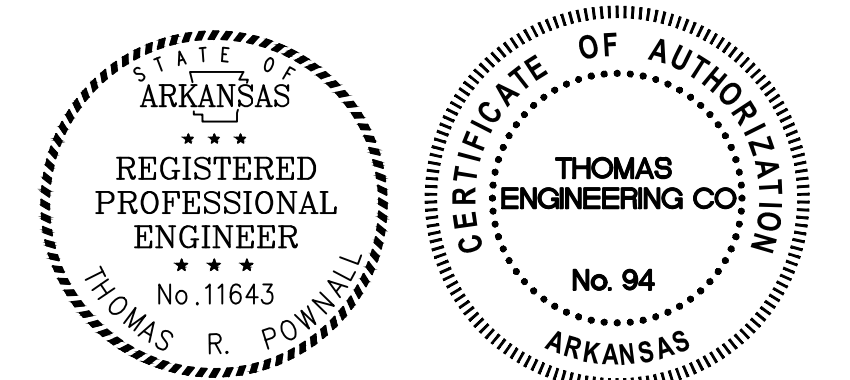

<p><b>THOMAS ENGINEERING COMPANY</b></p> <p>3810 LOOKOUT ROAD, N. LITTLE ROCK, AR. 72116 TEL: 501-753-4463 FAX: 501-753-6814</p>	<p>WALNUT STREET DETAILS 15TH STREET TO 17TH STREET NORTH LITTLE ROCK, ARKANSAS</p>			
	<p>APPROVED</p>	<p>DRAWN BY TRP</p>	<p>DATE 3/19/21</p>	<p>SHEET NO. 7</p>
<p>SCALE N.T.S.</p>				

WALNUT DESIGN.dwg

PLOTTED: 3/19/2021