

# REQUEST FOR BIDS

The City of North Little Rock (NLR) is requesting bids for installation of fiber from the new Fire Department outstation at HWY 165 and Blaze to an existing splice location at HWY 165 and Mitcham Rd. The project will include AFL ADSS 48CT Single Mode and Corning 12CT Single Mode fiber with splices in several locations on a total of 70 poles - both transmission and distribution. North Little Rock Electric has completed make-ready on these poles and they are ready for rigging.

The total footage of aerial fiber spans will be approximately 15,000' of 48CT fiber and 1,000' of 12CT fiber, with 250' of underground. This includes storage loops, splice tails and building penetrations, but does not include sag. All storage loops and splice tails will be 100'. All fiber must be tested end-to-end and the results must be provided before completion. Any materials left over will be the property of the City of North Little Rock.

The City of North Little Rock will supply ArcGIS plans of the route with pole attachment information. Splicing schematics will also be provided. These plans will include approximate span distances, dead-ends, trunnions, storages, enclosures, vaults and termination locations. The details of the prints are subject to change during the project and can be altered with a certain amount of flexibility if necessary. See attached documents for North Little Rock Electric's specifications for fiber construction. Contractor will supply all fiber, tangents, splice enclosures, vaults, dead-ends, pole hardware and materials required to complete the project. Contractor is responsible for all excavation and traffic signage permits.

Due to the scope of this job, the NLR Technology Infrastructure Architect will work directly with contractors on-site to address any issues that may arise and affect any changes if necessary. It is the job of the contractor to verify all materials needed and their quality except the fiber.

## Description of Fiber Route Prints (Prints Shown on Next Page)

### **ALL FIBER ATTACHMENTS TO BE INSTALLED 40" BELOW POWER SPACE**

**BIDDERS ACKNOWLEDGE AND UNDERSTAND THAT UPON AWARD OF THE WINNING BID, THE SELECTED BIDDER WILL BE REQUIRED TO REVIEW AND SIGN A CONTRACT WITH THE CITY OF NORTH LITTLE ROCK PRIOR TO BEGINNING WORK.**

Please submit all questions in writing to [ndicus@nlr.ar.gov](mailto:ndicus@nlr.ar.gov)

#### **Neal Dicus**

Technology Infrastructure Architect  
Department of Information Technology  
City of North Little Rock  
Office: 501-975-8824



**INVITATION TO BID**

Bid Number: 24-3869 Date Issued: Sunday, July 21, 2024

Date & Time Bid Opening: Tuesday, August 6, 2024 at 10:00 a.m.

Specifications Attached.

**Fire 11 Fiber Installation – HWY 165/Mitcham Rd. to HWY 165/Blaze**

PRICING MUST INCLUDE SALES TAX

DESCRIPTION	BID AMOUNT
Time for Both	
Lead Time on Material	
Installation Time	
Quantity	\$
Equipment	\$
Manufacture	\$
Pricing per Item	<i>SEE THE FOLLOWING PAGE FOR ITEMS AND PRICE SHEET.</i>
Labor	\$
Fusing Fiber Splicing per Fiber	\$

Only questions submitted in writing and email to [ndicus@nlr.ar.gov](mailto:ndicus@nlr.ar.gov) will be answered.

If you are obtaining this bid from our website, please be reminded that addendums may occur. It is therefore advisable that you review our listings for attachments including any changes to the bid.

The City of North Little Rock encourages participation of small, minority, and woman own business enterprises in the procurement of goods, services, professional services, and construction, either as a general contractor or sub-contractor. It is further requested that whenever possible, majority contractors who require sub-contractors, seek qualified small, minority, and woman businesses to partner with them.

**EXECUTION OF BID**

Upon signing this page, the organization certifies that they have read and agree to the requirements set forth in this bid including conditions set forth and pertinent information requests.

Name of Firm: \_\_\_\_\_ Phone No.: \_\_\_\_\_

Tax Identification No.: \_\_\_\_\_

Business Address: \_\_\_\_\_

Signature of Authorized Person: \_\_\_\_\_

Title: \_\_\_\_\_ Date: \_\_\_\_\_, 2023

**UNSIGNED BID COVER SHEET WILL BE REJECTED.**



**INVITATION TO BID**

Bid Number: 24-3869 Date Issued: Sunday, July 21, 2024

Date & Time Bid Opening: Tuesday, August 6, 2024 at 10:00 a.m.

**PRICING SHEET**

**Fire 11 Fiber Installation – HWY 165/Mitcham Rd. to HWY 165/Blaze**

PRICING MUST INCLUDE SALES TAX

This is a partial list of materials with estimated items needed. It is the job of the contractors to verify all materials needed and their quantity except for the fiber.

Quantity	MATERIALS	BID AMOUNT
15,000'	AFL ADSS 48 Count Single Mode 4 Tube Fiber	\$
1,000'	Corning Flat 12 Count Single Mode Fiber	\$
Est. 20	AFL ADSS Formed Wire Dead End Assembly	\$
Est. 70	AFL ADSS Tangent Assembly (Trunnion)	\$
Est. 12	AFL ADSS Fiber Storage Unit (Snow Shoes)	\$
Est. 4	AFL Splice Enclosure LG-150 w/ Trays	\$
Est. 1	Corning 6-Pack LC LIU	\$
Est. 3	3x3 Storage Vaults	\$
Miscellaneous Material (Pole hardware, J-hooks, Riser ...etc)		\$

**TOTAL PROJECT BID PRICE:**

\$ \_\_\_\_\_  
\_\_\_\_\_  
\_\_\_\_\_

## GENERAL TERMS AND CONDITIONS FOR THE CITY OF NORTH LITTLE ROCK, AR

1. When submitting an "Invitation to Bid," the bidder warrants that the commodities covered by the bid shall be free from defects in material and workmanship under normal use and service. In addition, bidder must deliver new commodities of the latest design and model, unless otherwise specified in the "Invitation to Bid."
2. Prices quoted are to be net process, and when an error is made in extending total prices, the City may accept the bid for the lesser amount whether reflected by extension or by the correct multiple of the unit price.
3. Discounts offered will be taken when the City qualifies for such. The beginning date for computing discounts will be the date of invoice or the date of delivery and acceptance, whichever is later.
4. When bidding other than the brand and/or model specified in the "Invitation to Bid," the brand and/or model number must be stated by that item in the "Invitation to Bid," and descriptive literature be submitted with the bid.
5. **REJECTION**
  - A. The City reserves the right to reject any or all Bids, to waive any minor informality or irregularity in any Bid, to negotiate changes and/or modifications with the lowest responsible bidder and to make award to the response deemed to be the most advantageous to the City. Bidders shall be required to comply with all applicable federal, state and local laws.
  - B. The City reserves the right to cancel request for bids without penalty with it is in the best interest of the City. Notice of Cancellation shall be inserted on the City's website ([www.nlr.ar.gov](http://www.nlr.ar.gov)).
  - C. Any Bid not conforming to the specifications or requirements set forth by the City in this Bid Request may be rejected.
  - D. Bids may be also rejected if they are made by a Bidder that is deemed un-responsible due to lack of qualifications, capacity, skill, character, experience, reliability, financial stability or quality of services, supplies, materials, equipment or labor.
  - E. The City of North Little Rock reserves the right to reject any and all bids, to accept in whole or in part, to waive any informalities in bids received, to accept bids on materials or equipment with variations from specifications in those cases where efficiency of operation will not be impaired, and unless otherwise specified by the bidder, to accept any item in the bid. If unit prices and extensions thereof do not coincide, the City of North Little Rock may accept the bid for the lesser amount whether reflected by the extension or by the correct multiple of the unit price
6. The Purchasing office reserves the right to award items, all or none, or by line item(s).
7. Quality, time and probability of performance may be factors in making an award.
8. Bid quotes submitted will remain firm for 30 calendar days from bid opening date; however, the prices may remain firm for a longer period of time if mutually agreeable between bidder and the Department of Commerce.
9. Bidder must submit a completed signed copy of the front page of the "Invitation to Bid" and must submit any other information required in the "Invitation to Bid."
10. In the event a contract is entered into pursuant to the "Invitation to Bid," the bidder shall not discriminate against any qualified employee or qualified applicant for employment because of race, sex, color, creed, national origin or ancestry. The bidder must include in any and all subcontracts a provision similar to the above.
11. Sales or use tax is not to be included in the bid price, but is to be added by the vendor to the invoice billing to the City. Although use tax is not to be included in this bid, vendors are to register and pay tax direct to the Arkansas State Revenue Department.
12. Prices quoted shall be "Free on Board" (F.O.B.) to destination at designated facility in North Little Rock. Charges may not be added after the bid is opened.
13. In the event of two or more identical low bids, the contract may be awarded arbitrarily or for any reason to any of such bidders or split in any proportion between them at the discretion of the Department of Commerce.

14. Specifications furnished with this Invitation are intended to establish a desired quality or performance level, or other minimum dimensions and capacities, which will provide the best product available at the lowest possible price. Other than designated brands and/or models approved as equal to designated products shall receive an equal consideration.
15. Samples of items when required, must be furnished free, and, if not called for within 30 days from date of bid opening, will become property of the City.
16. Bids will not be considered if they are:
  1. Submitted after the bid's opening time.
  2. Submitted electronically or faxed (unless authorized by Purchasing Manager).
17. Guarantees and warranties should be submitted with the bid, as they may be a consideration in making an award.
18. **CONSTRUCTION**
  - A. Contractor is to supply the City with evidence of having and maintaining proper and complete insurance, specifically Workman's Compensation Insurance in accordance with the laws of the State of Arkansas, Public Liability and Property Damage. All premiums and cost shall be paid by the Contractor. In no way will the City be responsible in case of accident.
  - B. When noted, a Certified check or bid bond in the amount of 5% of total bid shall accompany bid.
  - C. A Performance Bond equaling the total amount of any bid exceeding \$50,000.00 must be provided for any contract for the repair, alteration or erection of any public building, public structure or public improvement (pursuant to Arkansas Code Annotated Section 22-9-203).
19. **LIQUIDATED DAMAGES** – Liquidated damages shall be determined at the time of contract negotiations, based upon the construction contract price and stated time period set for completion of the project. Liquidated damages shall be assessed beginning on the first day following the maximum delivery or completion time entered on this bid form and/or provided for by the plans and specifications.
20. **AMBIGUITY IN BID** - Any ambiguity in any bid as the result of omission, error, lack of clarity or non-compliance by the bidder with specifications, instructions, and all conditions of bidding shall be construed in the light most favorable to the City.
21. The bid number should be stated on the face of the sealed bid envelope. If it is not, the envelope will have to be opened to identify.
22. Whenever a bid is sought seeking a source of supply for a specified period of time for materials and services, the quantities of usage shown are estimated ONLY. No guarantee or warranty is given or implied by the participants as to the total amount that may or may not be purchased from any resulting contracts. These quantities are for the bidders information ONLY and will be used for tabulation and presentation of bid and the participant reserves the right to increase or decrease quantities as required.
23. The City of North Little Rock will follow procedures to check bidder eligibility through the federal System for Award Management (S.A.M.) as outlined in 2 C.F.R. § 200. This will be completed prior to the award of any contract in which federal grant funds will be expended.
24. Respondents acknowledge and understand that upon award of the winning Bid, the Respondent will be required to review and sign a contract with the City of North Little Rock, which will contain additional terms and conditions, prior to providing any services to the City. In the event of any discrepancy or contradiction between the bid documents, Terms and Conditions or other such documents, the provisions in the contract shall take precedence.
25. Additional information or bid forms may be obtained from:

**Bidding documents must be submitted on or before the bid's opening date and time. Unless noted, bids must be sealed and mailed or delivered to:**

Amy Smith, Purchasing Manager  
Commerce Department  
700 W. 29<sup>th</sup> Street, 3<sup>rd</sup> Floor  
North Little Rock, AR 72114

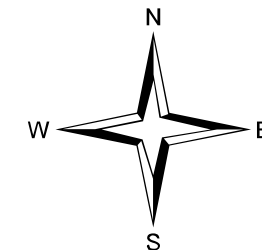

- Legend**
- ◆ Storage 100 OH
  - ◆ Storage 100 UG
  - ★ Splice Enclosure UG
  - Vault 3x3
  - ★ Splice Enclosure OH
  - ▲ Riser
  - Single Mode Fiber UG
  - Single Mode Fiber OH

**City of North Little Rock**  
 Department of Information Technology  
 1 Justice Center Drive  
 (501) 906-6500

Customer NLR  
 Address HWY 165 and Blaze  
 Tree Trimming No  
 Job Staked No  
 Use Utility - Municipal  
 Job Type Construction - Install  
 Design N. Dicus  
 Design Date 01.10.2024

Notes: 15,000' 48CT OH SM Fiber  
 1,200' 48CT OH SM Storage  
 250' 48CT UG SM Fiber  
 1000' 12CT UG SM Fiber  
 200' 12CT UG SM Storage

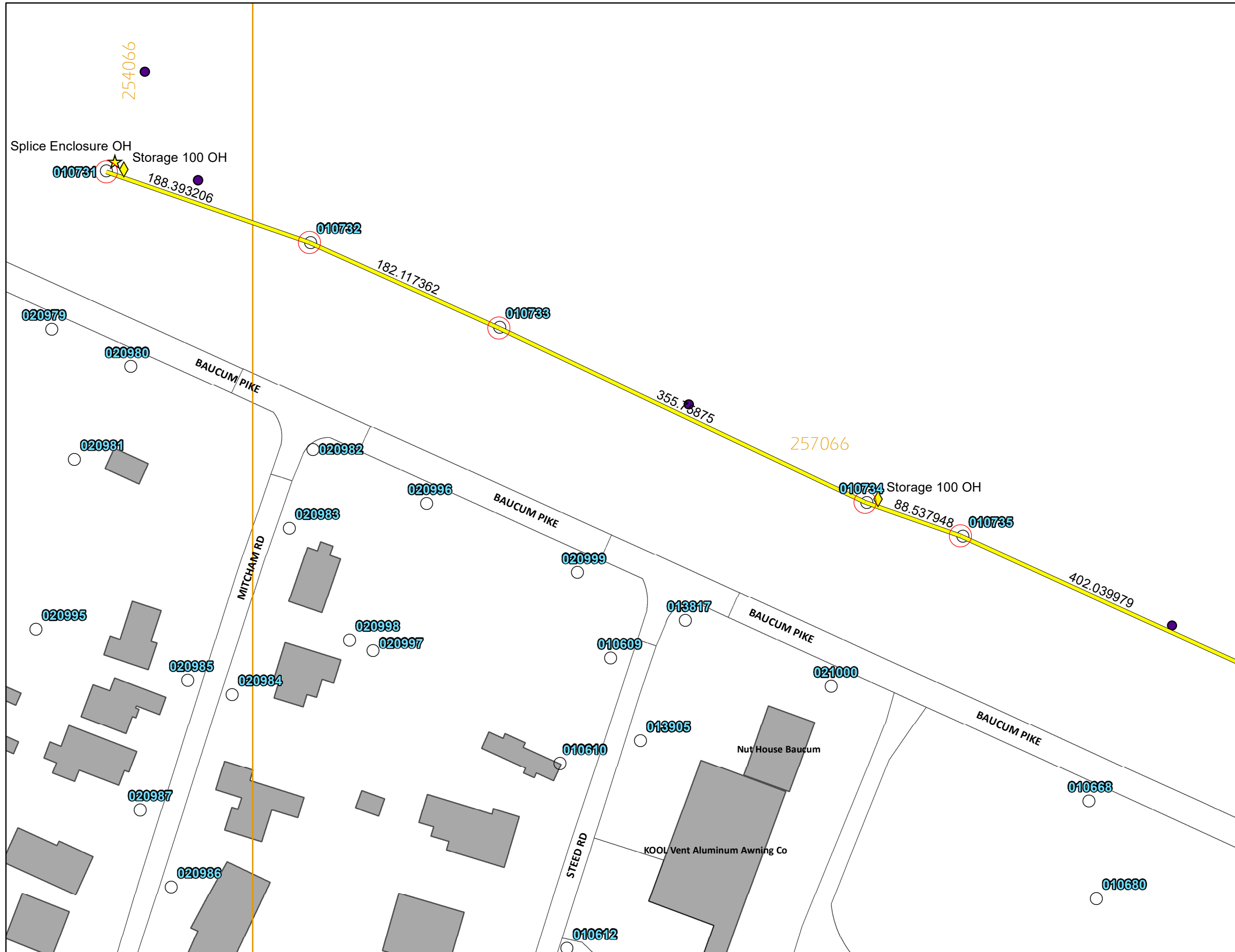
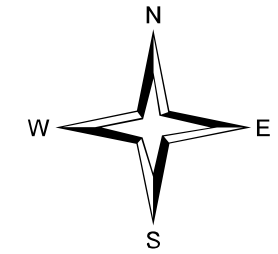

**Legend**

- Pole Marker
- Storage 100 OH
- Splice Enclosure OH
- Single Mode Fiber OH
- Pole**
- Unclassified Pole
- Type**
- Aluminum
- Concrete
- Steel
- UNK
- Wood
- Tower



**City of North Little Rock**  
 Department of Information Technology  
 1 Justice Center Drive  
 (501) 906-6500







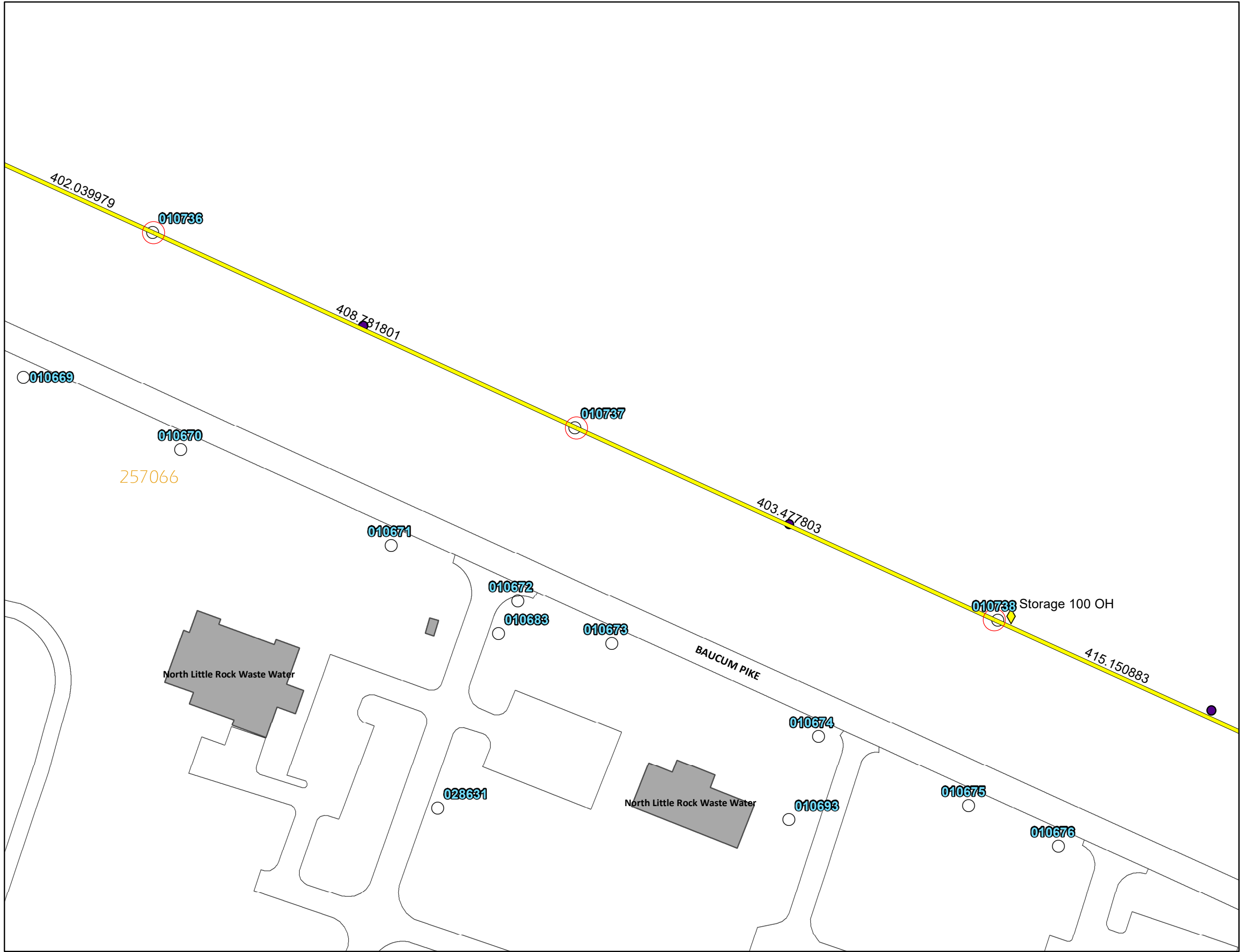
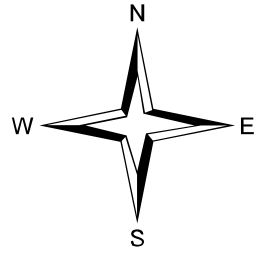

Customer NLR  
 Address HWY 165 and Blaze  
 Tree Trimming No  
 Job Staked No  
 Use Utility - Municipal  
 Job Type Construction - Install  
 Design N. Dicus  
 Design Date 01.10.2024

Notes: 15,000' 48CT OH SM Fiber  
 1,200' 48CT OH SM Storage  
 250' 48CT UG SM Fiber  
 1000' 12CT UG SM Fiber  
 200' 12CT UG SM Storage



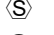
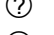

**Legend**

-  Pole Marker
-  Storage 100 OH
-  Single Mode Fiber OH
- Pole**
-  Unclassified Pole
- Type**
-  Aluminum
-  Concrete
-  Steel
-  UNK
-  Wood
-  Tower



City of North Little Rock







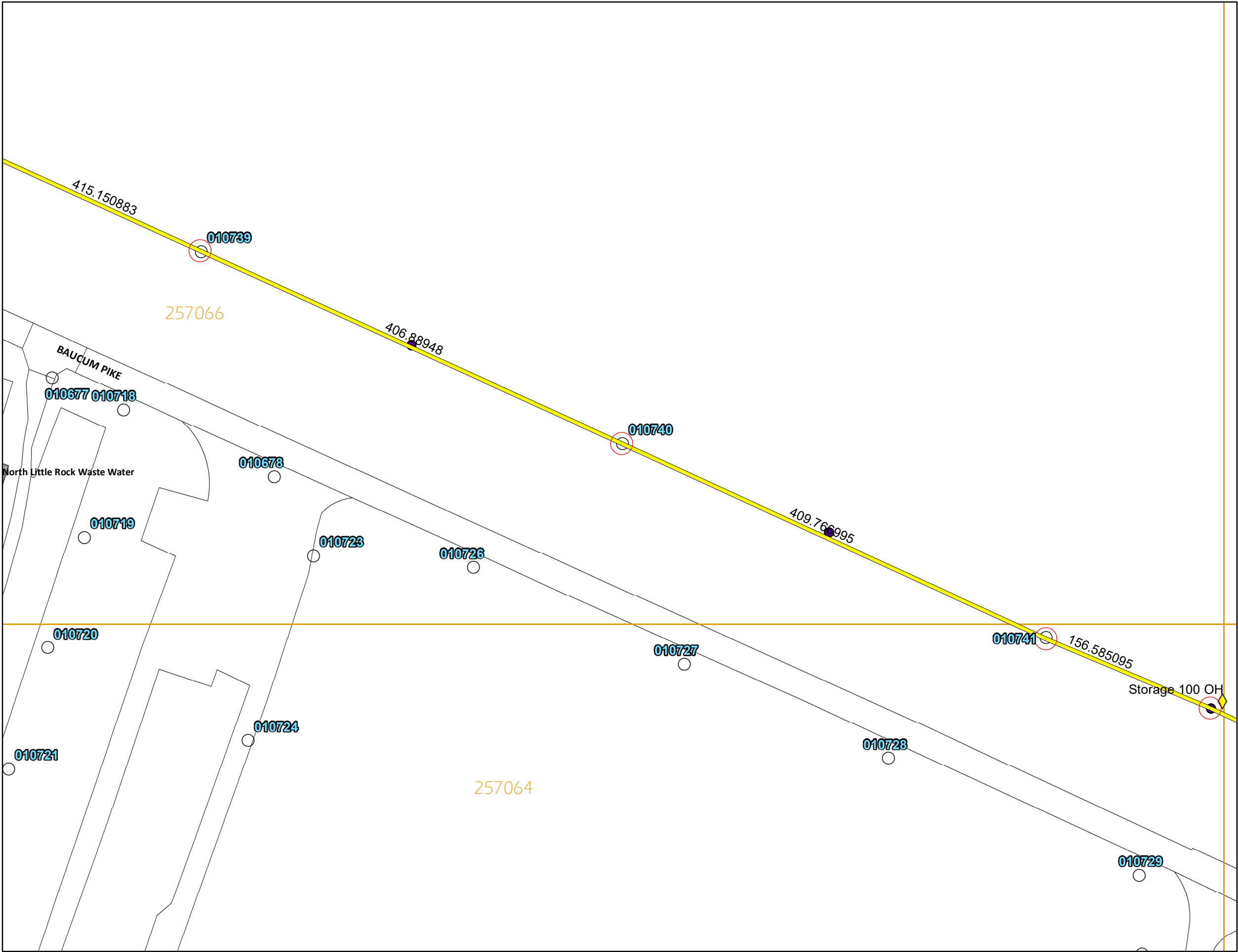
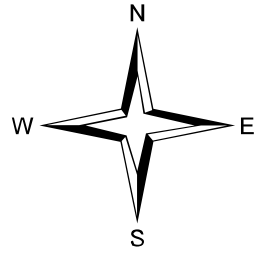

Department of Information Technology  
1 Justice Center Drive  
(501) 906-6500

Customer NLR  
 Address HWY 165 and Blaze  
 Tree Trimming No  
 Job Staked No  
 Use Utility - Municipal  
 Job Type Construction - Install  
 Design N. Dicus  
 Design Date 01.10.2024

Notes: 15,000' 48CT OH SM Fiber  
 1,200' 48CT OH SM Storage  
 250' 48CT UG SM Fiber  
 1000' 12CT UG SM Fiber  
 200' 12CT UG SM Storage

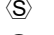
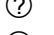

**Legend**

-  Pole Marker
-  Storage 100 OH
-  Single Mode Fiber OH
- Pole**
-  Unclassified Pole
- Type**
-  Aluminum
-  Concrete
-  Steel
-  UNK
-  Wood
-  Tower



City of North Little Rock

Department of Information Technology  
1 Justice Center Drive  
(501) 906-6500

Customer NLR  
 Address HWY 165 and Blaze  
 Tree Trimming No  
 Job Staked No  
 Use Utility - Municipal  
 Job Type Construction - Install  
 Design N. Dicus  
 Design Date 01.10.2024

Notes: 15,000' 48CT OH SM Fiber  
 1,200' 48CT OH SM Storage  
 250' 48CT UG SM Fiber  
 1000' 12CT UG SM Fiber  
 200' 12CT UG SM Storage

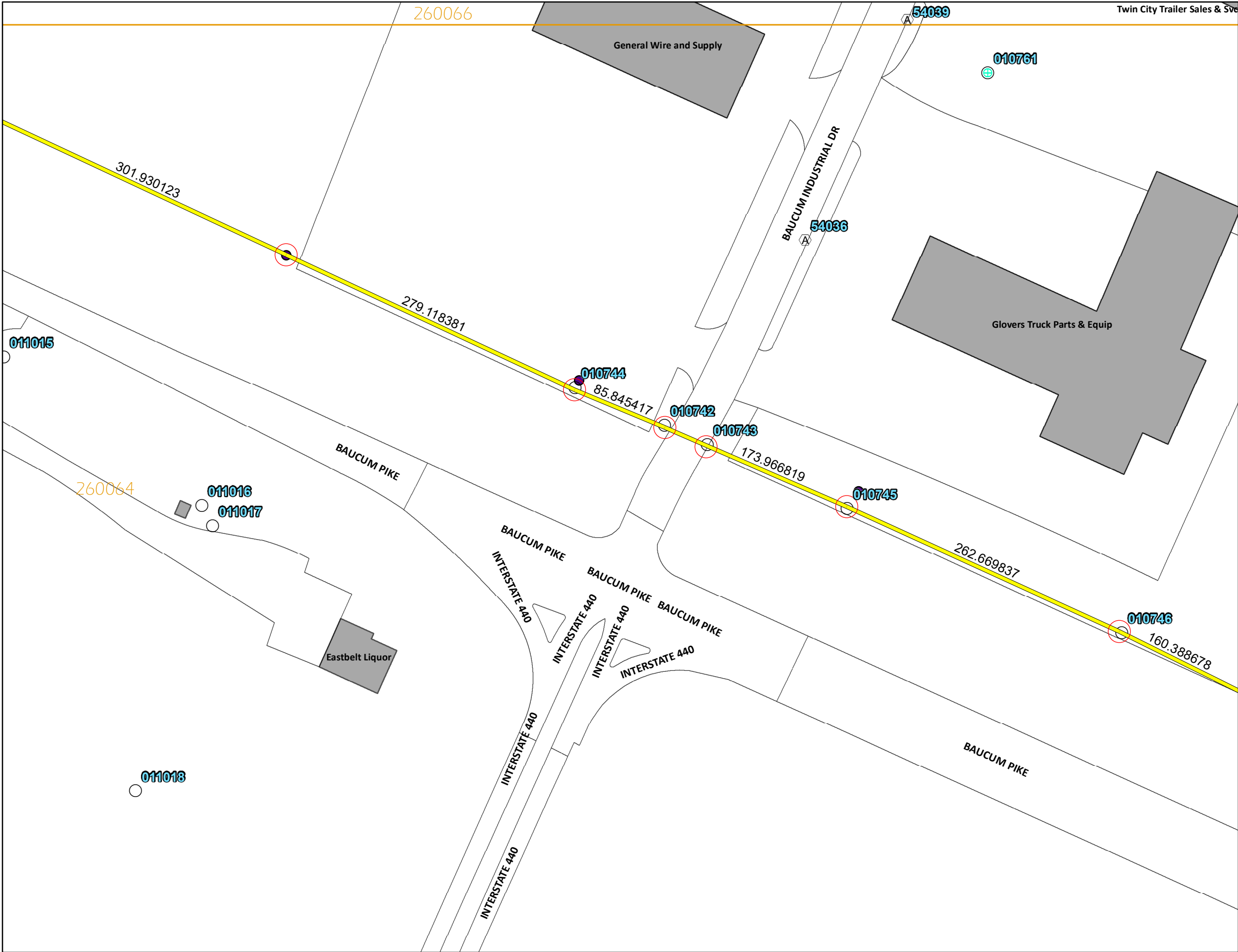
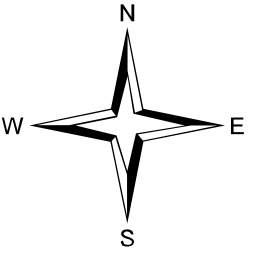

**Legend**

- Pole Marker
- Single Mode Fiber OH
- Pole**
- Unclassified Pole
- Type**
- Aluminum
- Concrete
- Steel
- UNK
- Wood
- Tower



City of North Little Rock

Department of Information Technology  
1 Justice Center Drive  
(501) 906-6500

Customer NLR  
 Address HWY 165 and Blaze  
 Tree Trimming No  
 Job Staked No  
 Use Utility - Municipal  
 Job Type Construction - Install  
 Design N. Dicus  
 Design Date 01.10.2024

Notes: 15,000' 48CT OH SM Fiber  
 1,200' 48CT OH SM Storage  
 250' 48CT UG SM Fiber  
 1000' 12CT UG SM Fiber  
 200' 12CT UG SM Storage

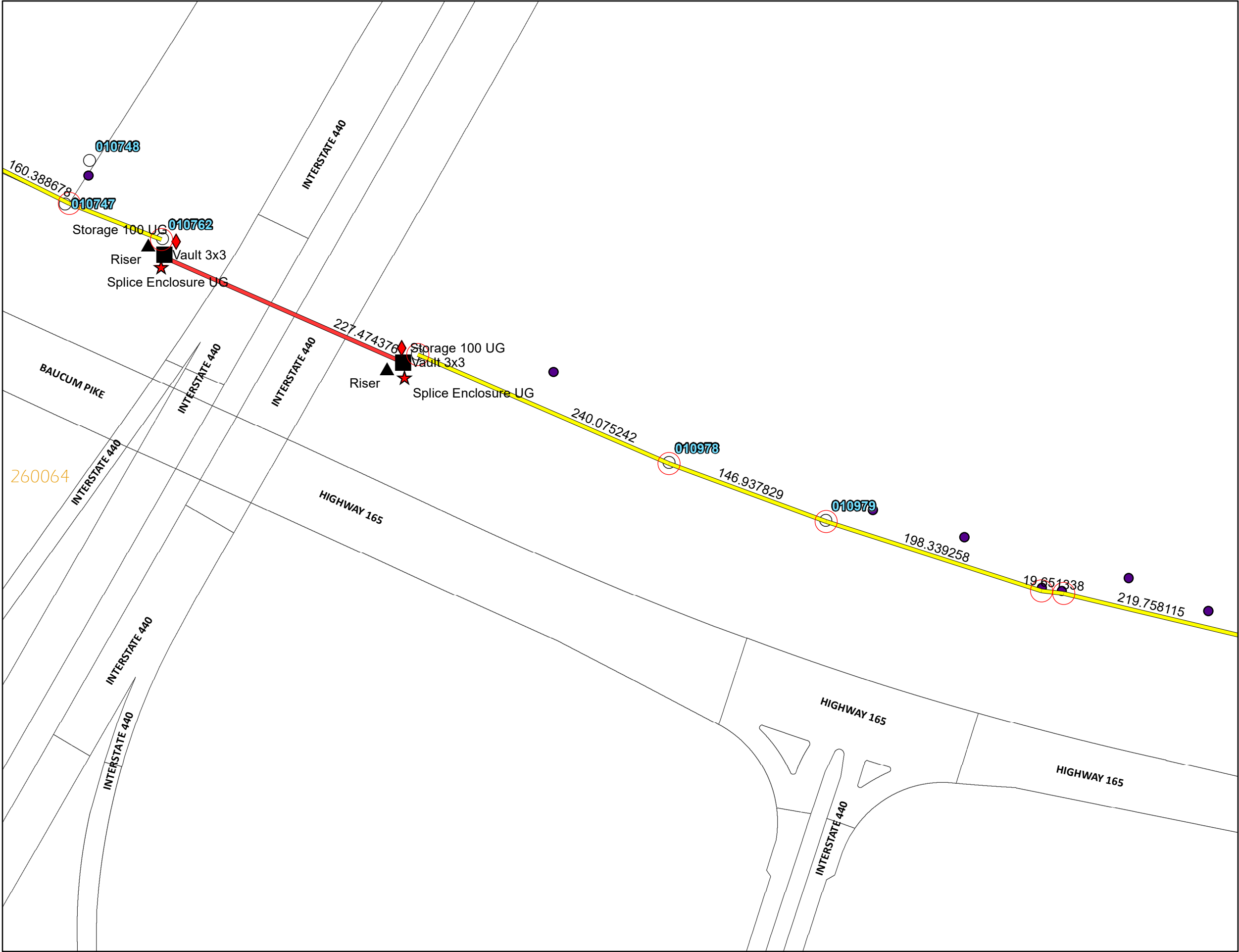
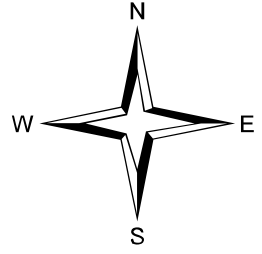

**Legend**

- Pole Marker
- Storage 100 UG
- Splice Enclosure UG
- Vault 3x3
- Riser
- Single Mode Fiber UG
- Single Mode Fiber OH

**Pole**

- Unclassified Pole

**Type**

- Aluminum
- Concrete
- Steel
- UNK
- Wood
- Tower



City of North Little Rock

Department of Information Technology  
1 Justice Center Drive  
(501) 906-6500

Customer NLR  
 Address HWY 165 and Blaze  
 Tree Trimming No  
 Job Staked No  
 Use Utility - Municipal  
 Job Type Construction - Install  
 Design N. Dicus  
 Design Date 01.10.2024

Notes: 15,000' 48CT OH SM Fiber  
 1,200' 48CT OH SM Storage  
 250' 48CT UG SM Fiber  
 1000' 12CT UG SM Fiber  
 200' 12CT UG SM Storage

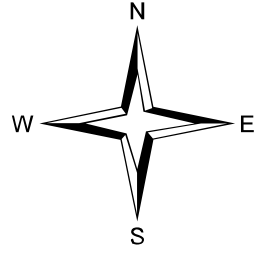

**Legend**

- Pole Marker
  - Storage 100 OH
  - Single Mode Fiber OH
- Pole**
- Unclassified Pole
- Type**
- Aluminum
  - Concrete
  - Steel
  - UNK
  - Wood
  - Tower









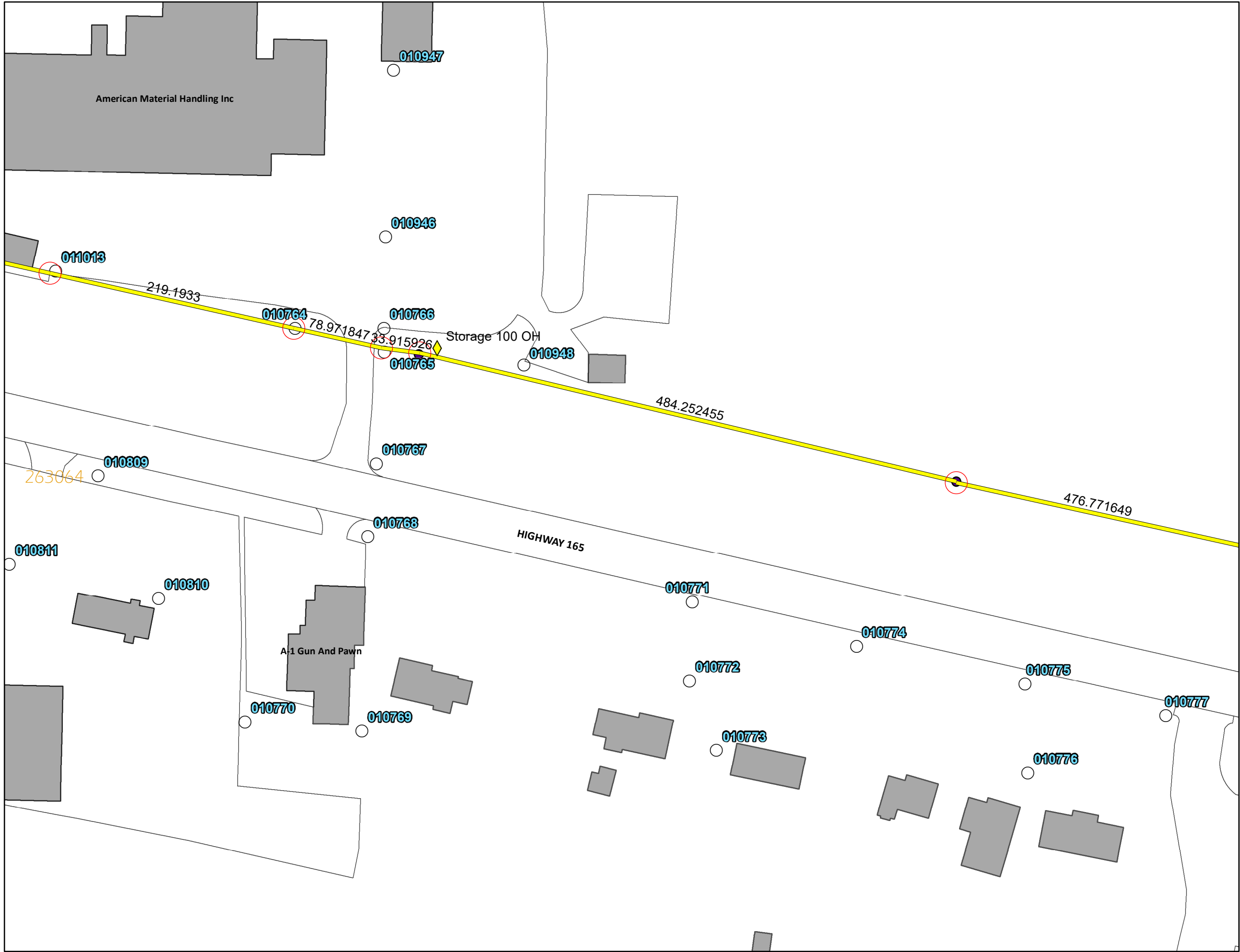
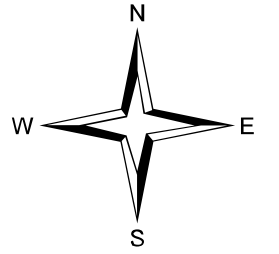



**City of North Little Rock**  
 Department of Information Technology  
 1 Justice Center Drive  
 (501) 906-6500

Customer NLR  
 Address HWY 165 and Blaze  
 Tree Trimming No  
 Job Staked No  
 Use Utility - Municipal  
 Job Type Construction - Install  
 Design N. Dicus  
 Design Date 01.10.2024

Notes: 15,000' 48CT OH SM Fiber  
 1,200' 48CT OH SM Storage  
 250' 48CT UG SM Fiber  
 1000' 12CT UG SM Fiber  
 200' 12CT UG SM Storage



**Legend**

-  Pole Marker
-  Storage 100 OH
-  Single Mode Fiber OH
- Pole**
-  Unclassified Pole
- Type**
-  Aluminum
-  Concrete
-  Steel
-  UNK
-  Wood
-  Tower



City of North Little Rock







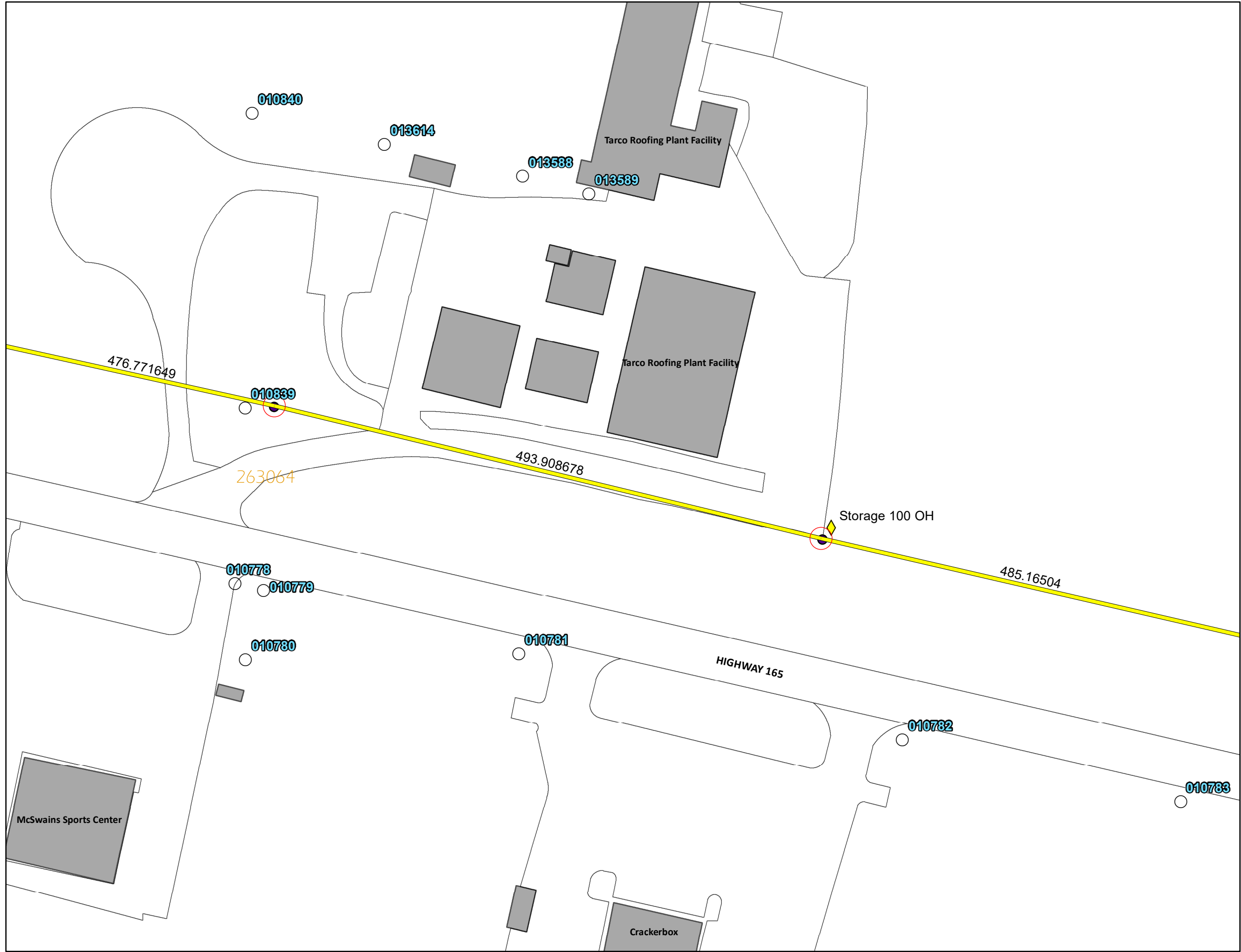
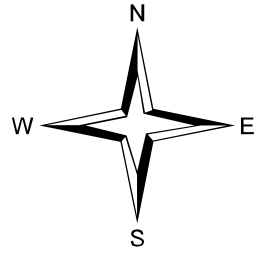



Department of Information Technology  
1 Justice Center Drive  
(501) 906-6500

Customer NLR  
 Address HWY 165 and Blaze  
 Tree Trimming No  
 Job Staked No  
 Use Utility - Municipal  
 Job Type Construction - Install  
 Design N. Dicus  
 Design Date 01.10.2024

Notes: 15,000' 48CT OH SM Fiber  
 1,200' 48CT OH SM Storage  
 250' 48CT UG SM Fiber  
 1000' 12CT UG SM Fiber  
 200' 12CT UG SM Storage



**Legend**

-  Pole Marker
-  Storage 100 OH
-  Single Mode Fiber OH
- Pole**
-  Unclassified Pole
- Type**
-  Aluminum
-  Concrete
-  Steel
-  UNK
-  Wood
-  Tower



City of North Little Rock

Department of Information Technology  
1 Justice Center Drive  
(501) 906-6500

Customer NLR  
 Address HWY 165 and Blaze  
 Tree Trimming No  
 Job Staked No  
 Use Utility - Municipal  
 Job Type Construction - Install  
 Design N. Dicus  
 Design Date 01.10.2024

Notes: 15,000' 48CT OH SM Fiber  
 1,200' 48CT OH SM Storage  
 250' 48CT UG SM Fiber  
 1000' 12CT UG SM Fiber  
 200' 12CT UG SM Storage

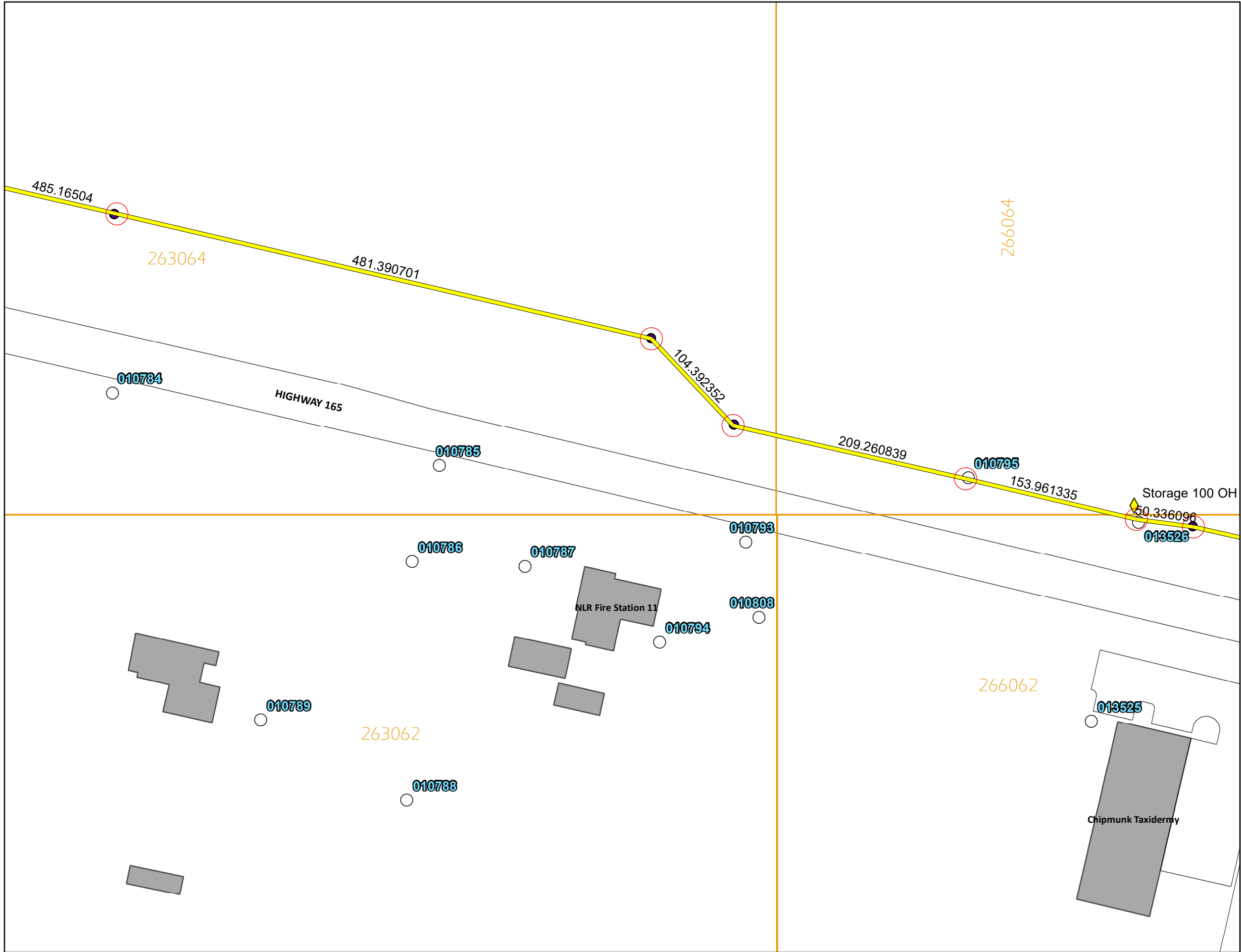
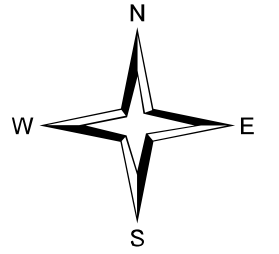

**Legend**

- Pole Marker
- Storage 100 OH
- Single Mode Fiber OH
- Pole**
- Unclassified Pole
- Type**
- Aluminum
- Concrete
- Steel
- UNK
- Wood
- Tower



City of North Little Rock

Department of Information Technology  
1 Justice Center Drive  
(501) 906-6500

Customer NLR

Address HWY 165 and Blaze

Tree Trimming No

Job Staked No

Use Utility - Municipal

Job Type Construction - Install

Design N. Dicus

Design Date 01.10.2024

Notes: 15,000' 48CT OH SM Fiber  
 1,200' 48CT OH SM Storage  
 250' 48CT UG SM Fiber  
 1000' 12CT UG SM Fiber  
 200' 12CT UG SM Storage



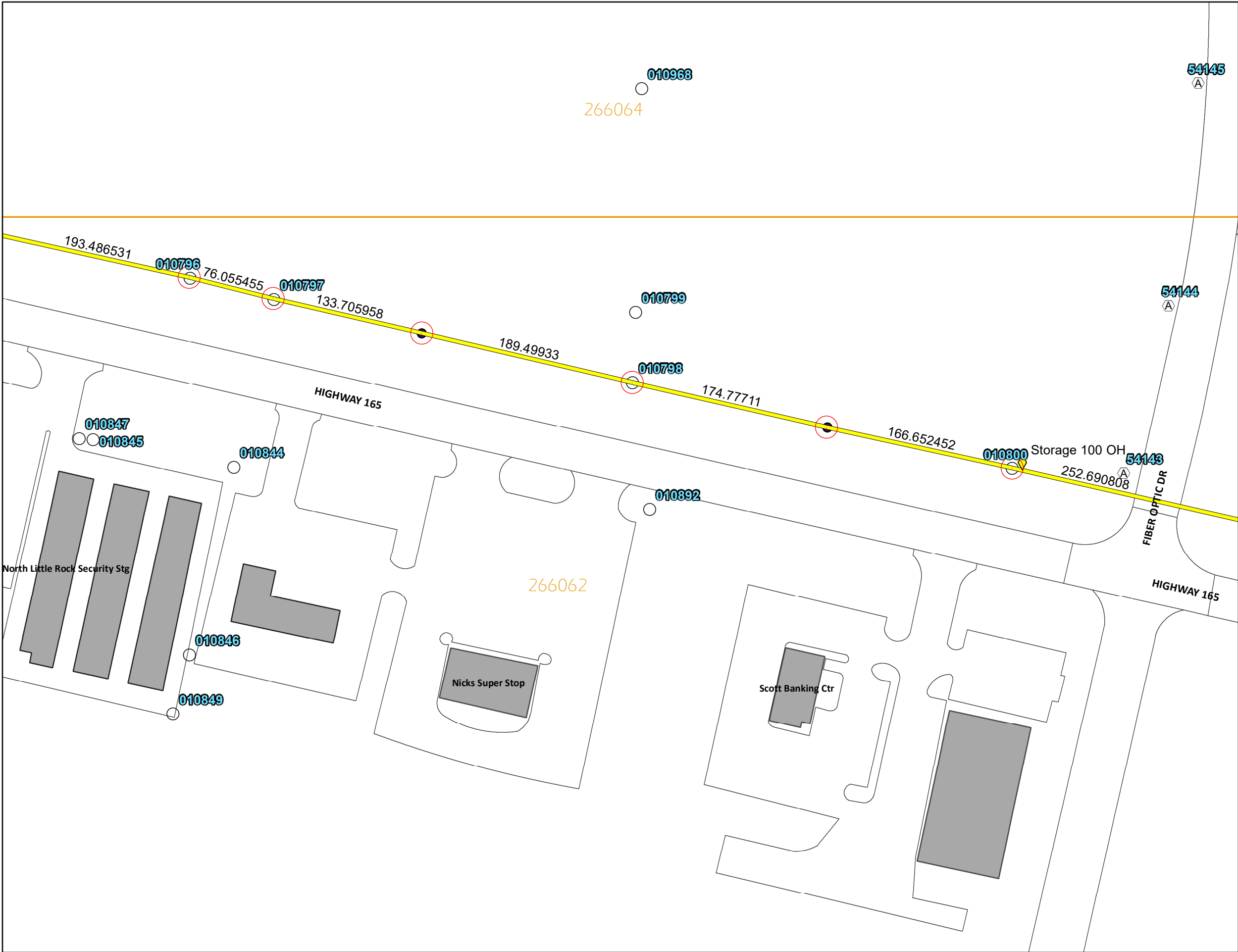
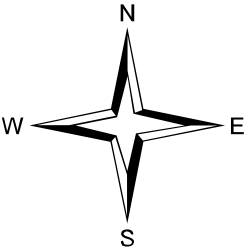

**Legend**

- Pole Marker
- Storage 100 OH
- Single Mode Fiber OH
- Pole**
- Unclassified Pole
- Type**
- Aluminum
- Concrete
- Steel
- UNK
- Wood
- Tower



City of North Little Rock

Department of Information Technology  
1 Justice Center Drive  
(501) 906-6500

Customer NLR  
 Address HWY 165 and Blaze  
 Tree Trimming No  
 Job Staked No  
 Use Utility - Municipal  
 Job Type Construction - Install  
 Design N. Dicus  
 Design Date 01.10.2024

Notes: 15,000' 48CT OH SM Fiber  
 1,200' 48CT OH SM Storage  
 250' 48CT UG SM Fiber  
 1000' 12CT UG SM Fiber  
 200' 12CT UG SM Storage

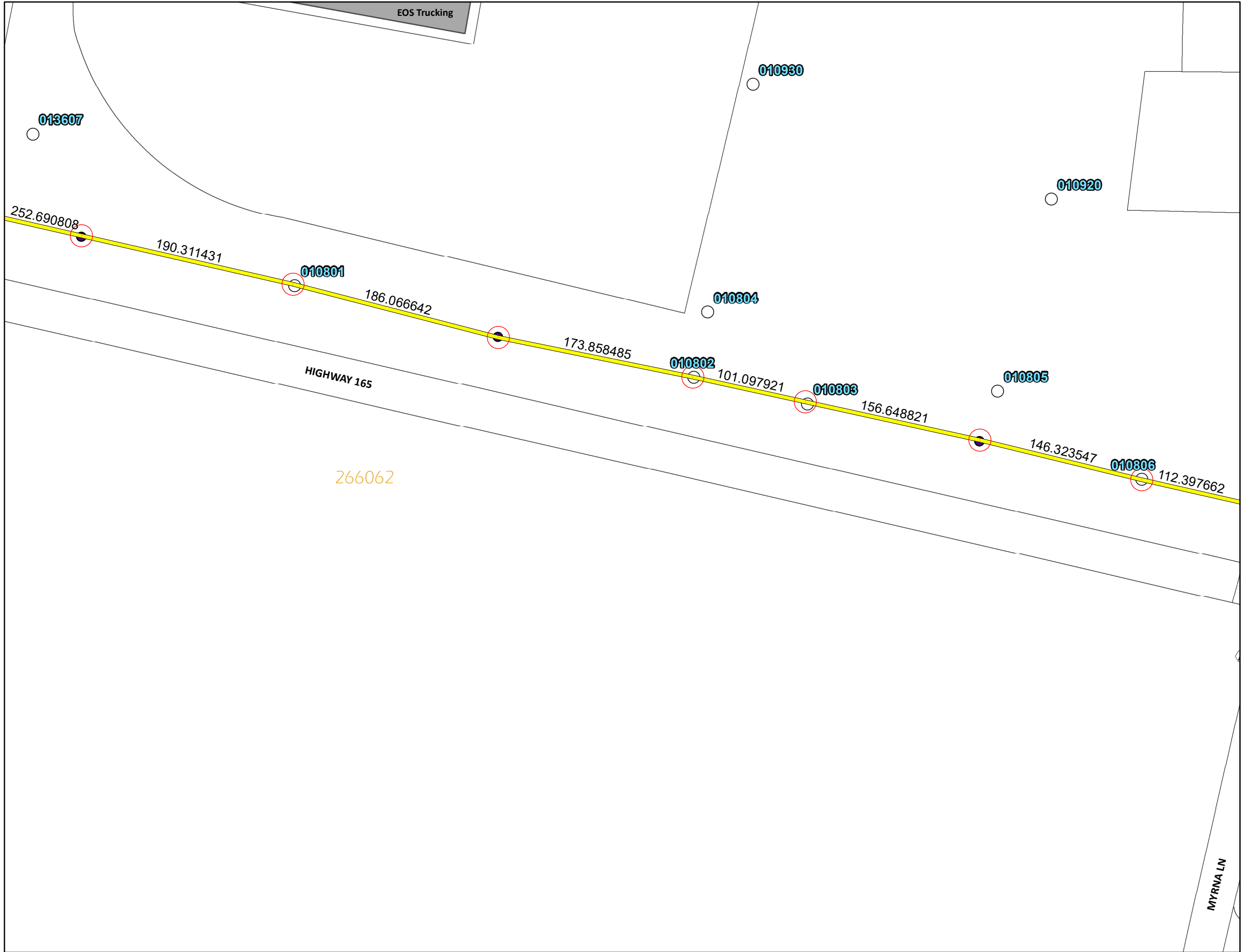
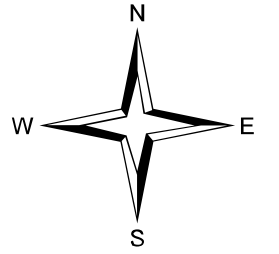

**Legend**

- Pole Marker
- Single Mode Fiber OH
- Pole**
- Unclassified Pole
- Type**
- Aluminum
- Concrete
- Steel
- UNK
- Wood
- Tower



City of North Little Rock

Department of Information Technology  
1 Justice Center Drive  
(501) 906-6500

Customer NLR  
 Address HWY 165 and Blaze  
 Tree Trimming No  
 Job Staked No  
 Use Utility - Municipal  
 Job Type Construction - Install  
 Design N. Dicus  
 Design Date 01.10.2024

Notes: 15,000' 48CT OH SM Fiber  
 1,200' 48CT OH SM Storage  
 250' 48CT UG SM Fiber  
 1000' 12CT UG SM Fiber  
 200' 12CT UG SM Storage

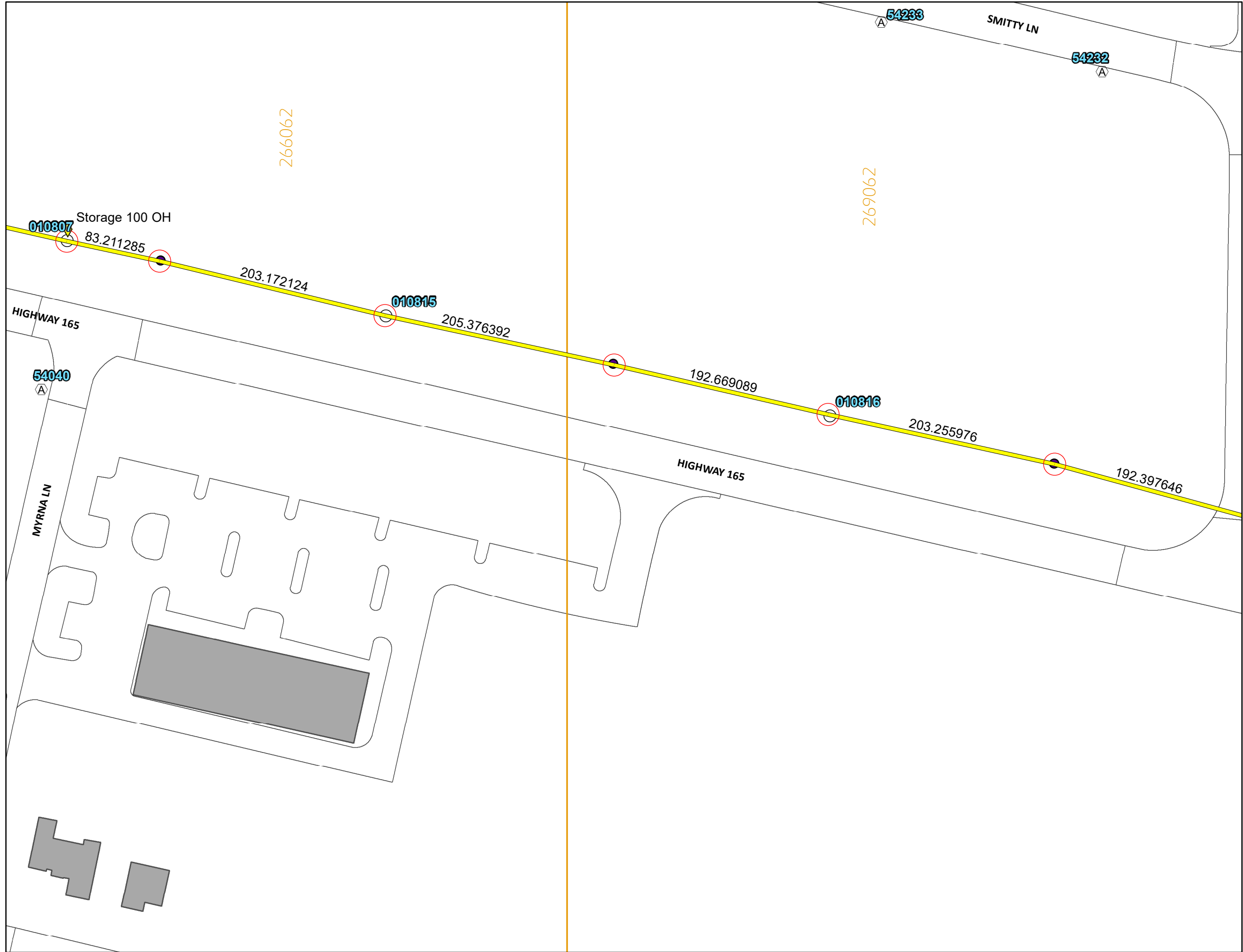
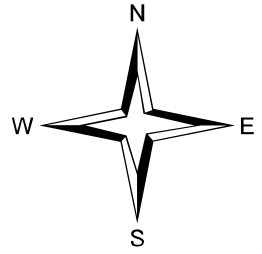

**Legend**

- Pole Marker
- Storage 100 OH
- Single Mode Fiber OH
- Pole**
- Unclassified Pole
- Type**
- Aluminum
- Concrete
- Steel
- UNK
- Wood
- Tower



City of North Little Rock

Department of Information Technology  
1 Justice Center Drive  
(501) 906-6500

Customer NLR

Address HWY 165 and Blaze

Tree Trimming No

Job Staked No

Use Utility - Municipal

Job Type Construction - Install

Design N. Dicus

Design Date 01.10.2024

Notes: 15,000' 48CT OH SM Fiber  
 1,200' 48CT OH SM Storage  
 250' 48CT UG SM Fiber  
 1000' 12CT UG SM Fiber  
 200' 12CT UG SM Storage

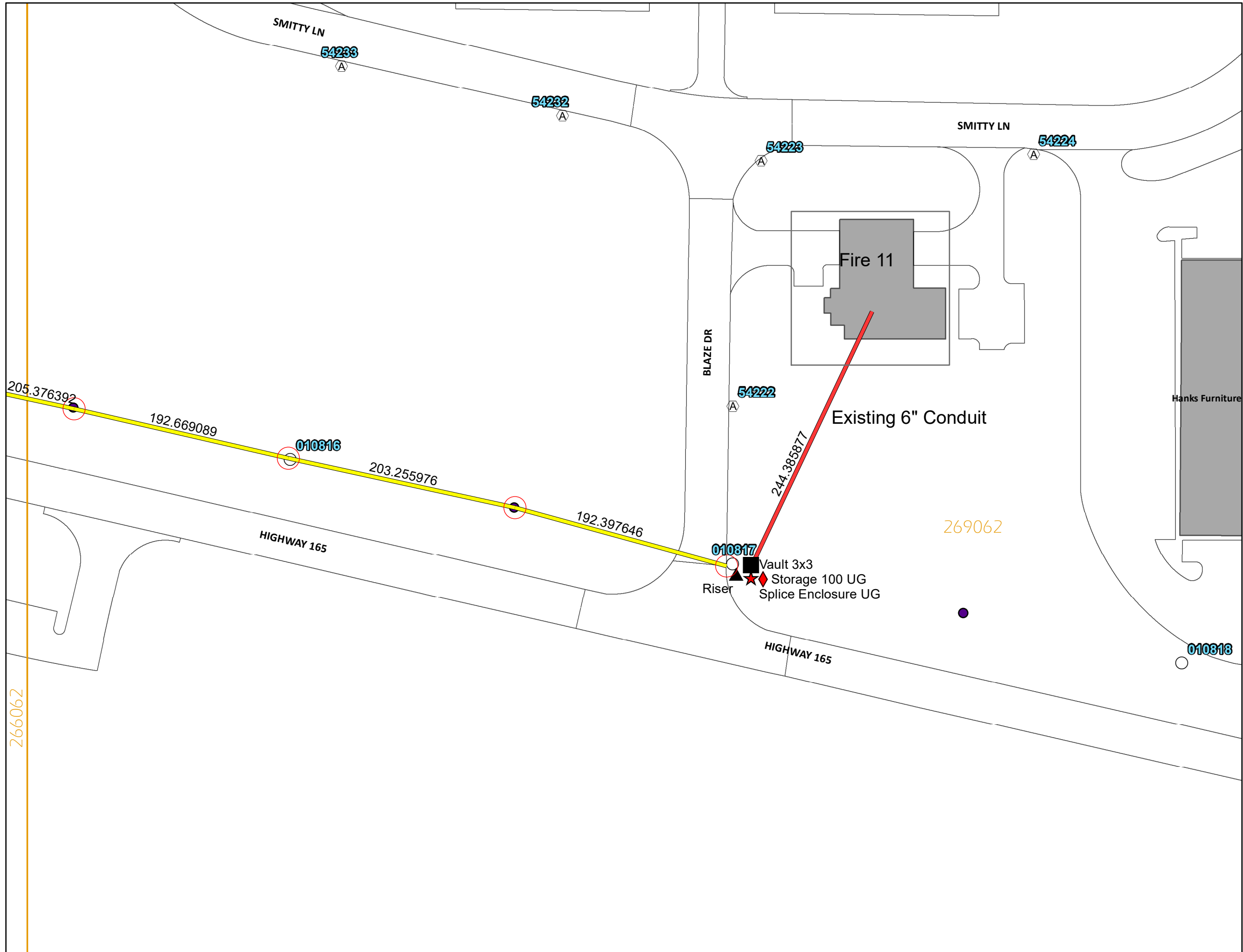
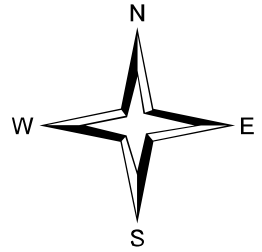

**Legend**

- Pole Marker
- ◆ Storage 100 UG
- ★ Splice Enclosure UG
- Vault 3x3
- ▲ Riser
- Single Mode Fiber UG
- Single Mode Fiber OH
- Pole**
- Unclassified Pole
- Type**
- A Aluminum
- C Concrete
- S Steel
- ? UNK
- Wood
- Tower

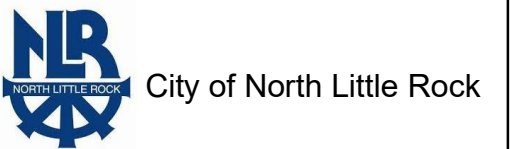

City of North Little Rock  
 Department of Information Technology  
 1 Justice Center Drive  
 (501) 906-6500

Customer NLR

Address HWY 165 and Blaze

Tree Trimming No

Job Staked No

Use Utility - Municipal

Job Type Construction - Install

Design N. Dicus

Design Date 01.10.2024

Notes: 15,000' 48CT OH SM Fiber  
 1,200' 48CT OH SM Storage  
 250' 48CT UG SM Fiber  
 1000' 12CT UG SM Fiber  
 200' 12CT UG SM Storage

266062

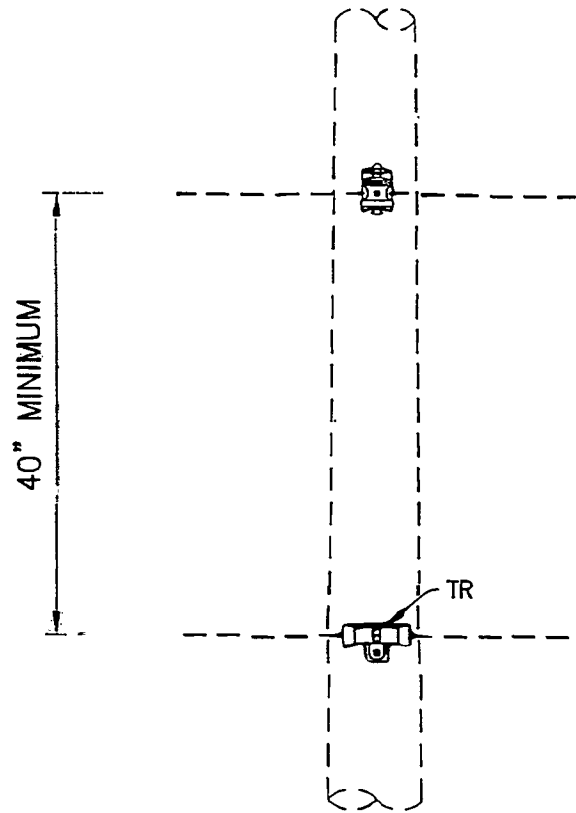
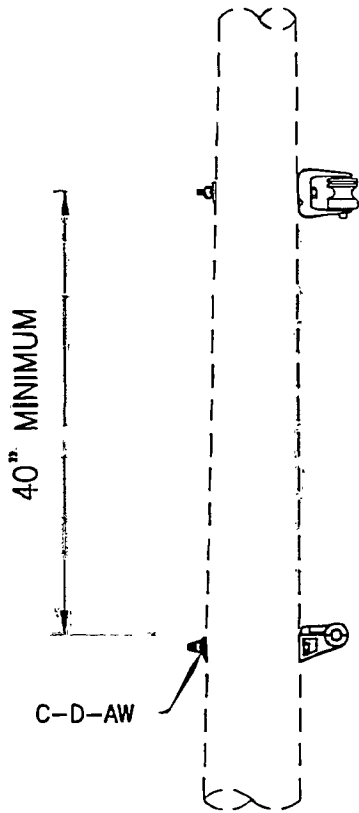

**NOTE:**  
 ALL NEW POLES ARE REQUIRED TO  
 HAVE A GROUNDLINE POLE WRAP  
 AND A POLE TOP CAP INSTALLED.

**NOTE:**  
 FIBER ATTACHMENT MUST BE 40"  
 MINIMUM BELOW LOWEST SUPPLY  
 CONDUCTOR

ITEM	QUAN.	MATERIAL DESCRIPTION		
C	1	MACHINE BOLT, 5/8" x REQ'D LENGTH		
D	1	SQUARE WASHER, 2 1/4" x 2 1/4"		
AW	1	LOCK WASHER (SPRING TYPE), AS REQ'D		
TR	1	TRUNNION ASSEMBLY		
	NORTH LITTLE ROCK ELECTRIC CONSTRUCTION STANDARDS TANGENT ADSS FIBER		DATE: 7-14-2016	REVISION
			SHT No: 1	0
			CONSTRUCTION STANDARD No.	Z-1

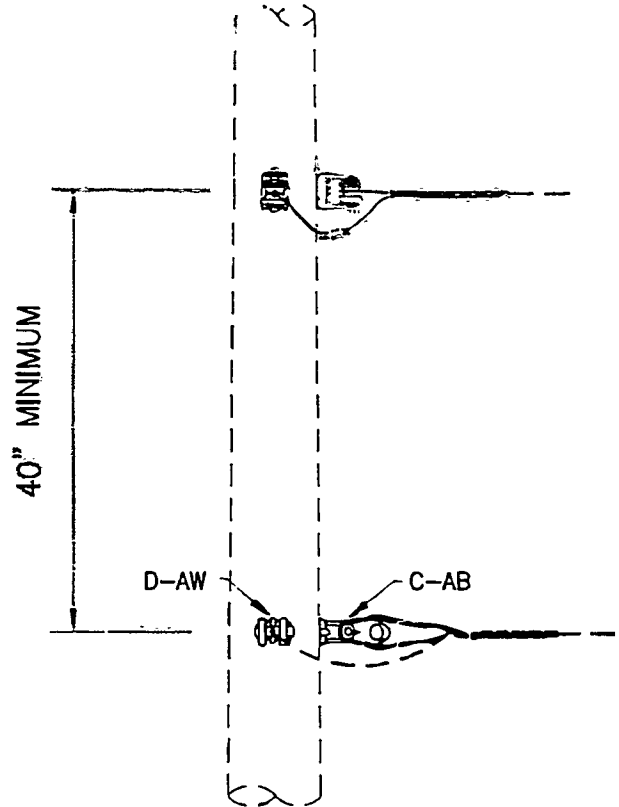
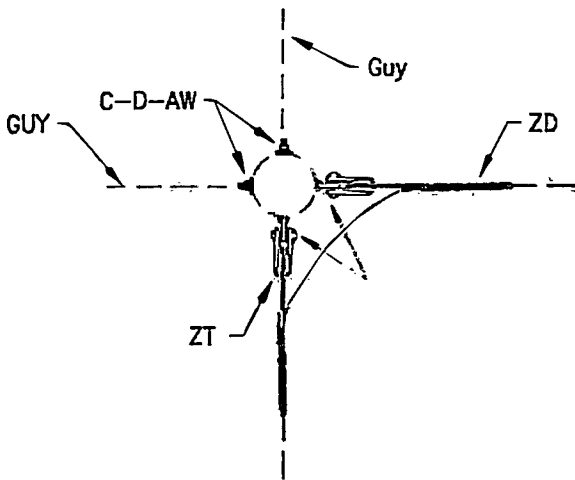

**NOTE:**

ALL NEW POLES ARE REQUIRED TO HAVE A GROUNDLINE POLE WRAP AND A POLE TOP CAP INSTALLED.

**NOTE:**

FIBER ATTACHMENT MUST BE 40" MINIMUM BELOW LOWEST SUPPLY CONDUCTOR

ITEM	QUAN.	MATERIAL DESCRIPTION
C	2	MACHINE BOLT, 5/8" x REQ'D LENGTH
D	2	WASHER, 2 1/4" x 2 1/4"
AB	2	STD EYELET BOLT, 5/8"
AW	2	LOCK WASHER (SPRING TYPE), AS REQ'D
ZD	2	FIBER DEAD END ASSEMBLY
ZT	2	THIMBLE CLEVIS



NORTH LITTLE ROCK ELECTRIC CONSTRUCTION STANDARDS

DEAD-END ANGLE - 16° TO 165° ANGLE

ADSS FIBER

DATE: 7-20-2016

SHT No: 1

CONSTRUCTION STANDARD No.

REVISION

0

Z-4

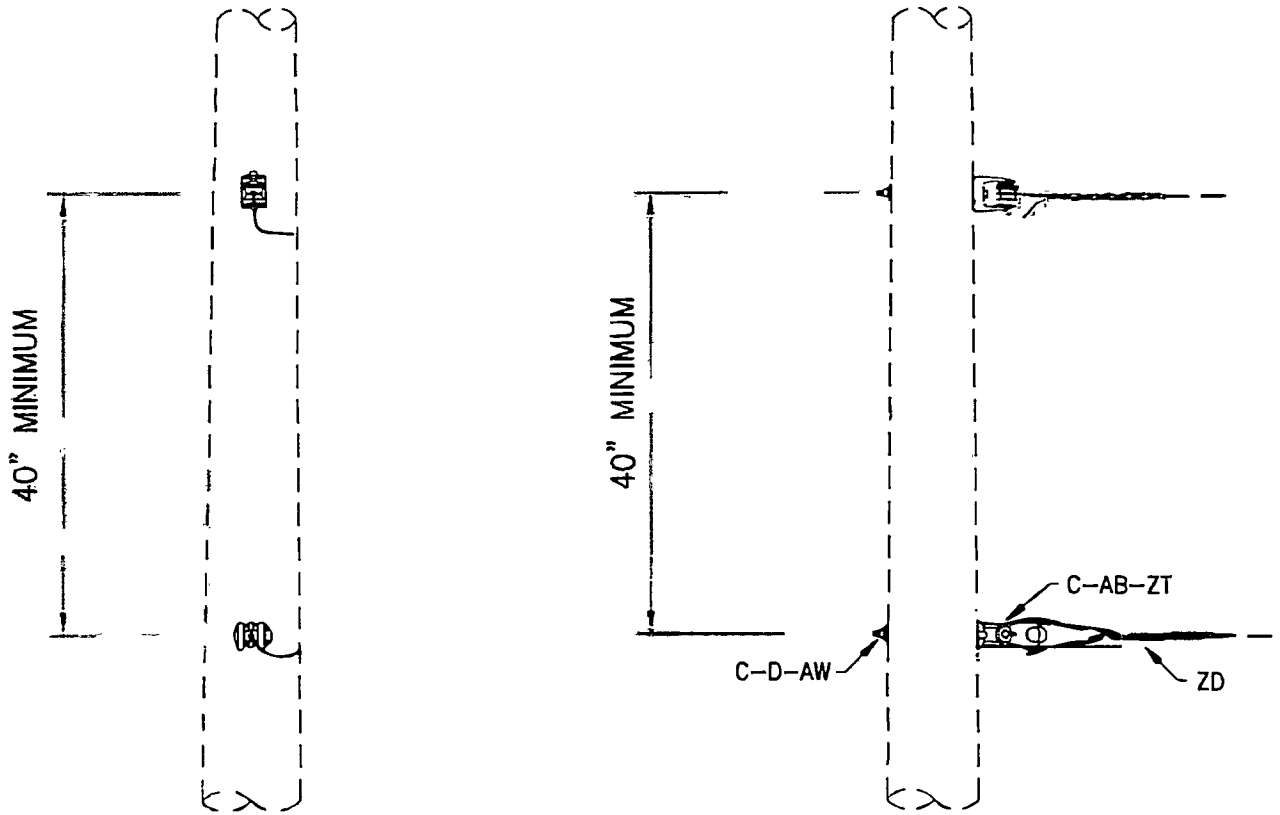

**NOTE:**  
 ALL NEW POLES ARE REQUIRED TO  
 HAVE A GROUNDLINE POLE WRAP  
 AND A POLE TOP CAP INSTALLED.

**NOTE:**  
 FIBER ATTACHMENT MUST BE 40"  
 MINIMUM BELOW LOWEST SUPPLY  
 CONDUCTOR

ITEM	QUAN.	MATERIAL DESCRIPTION
C	1	MACHINE BOLT, 5/8" x REQ'D LENGTH
D	1	WASHER, 2 1/4" x 2 1/4"
AB	1	STD EYELET BOLT, 5/8"
AW	1	LOCK WASHER (SPRING TYPE), AS REQ'D
ZD	1	FIBER DEAD END ASSEMBLY
ZT	1	THIMBLE CLEVIS



NORTH LITTLE ROCK ELECTRIC CONSTRUCTION STANDARDS  
 SINGLE DEAD-END  
 ADSS FIBER

DATE: 7-14-2016	REVISION 0
SHT No: 1	
CONSTRUCTION STANDARD No.	Z-5

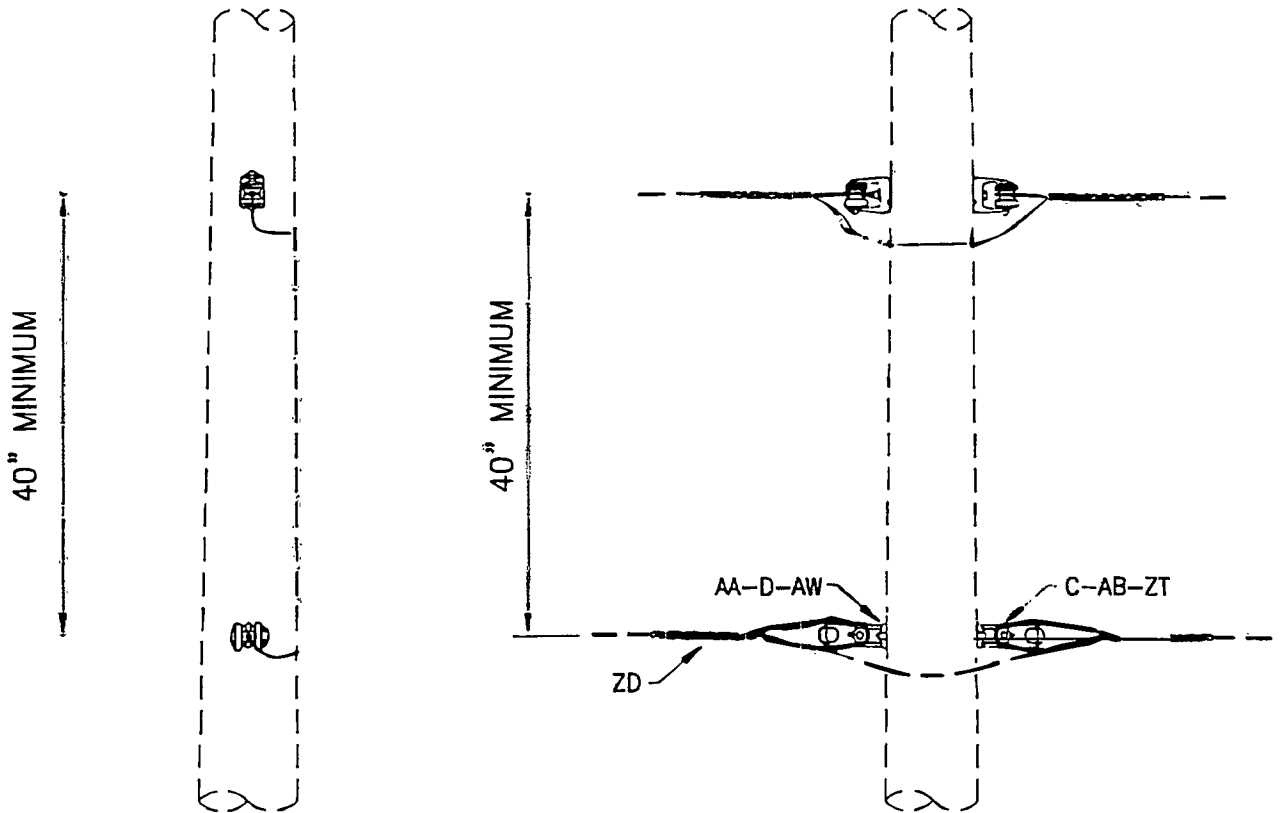

**NOTE:**  
 ALL NEW POLES ARE REQUIRED TO  
 HAVE A GROUNDLINE POLE WRAP  
 AND A POLE TOP CAP INSTALLED.

**NOTE:**  
 FIBER ATTACHMENT MUST BE 40"  
 MINIMUM BELOW LOWEST SUPPLY  
 CONDUCTOR

ITEM	QUAN.	MATERIAL DESCRIPTION
C	1	MACHINE BOLT, 5/8" x REQ'D LENGTH
D	1	WASHER, 2 1/4" x 2 1/4"
AA	1	EYE NUT, 5/8"
AB	1	STD EYELET BOLT, 5/8"
AW	1	LOCK WASHER (SPRING TYPE), AS REQ'D
ZD	2	FIBER DEAD END ASSEMBLY
ZT	2	THIMBLE CLEVIS



NORTH LITTLE ROCK ELECTRIC CONSTRUCTION STANDARDS

DOUBLE DEAD-END  
 ADSS FIBER

DATE: 7-14-2016

SHT No: 1

CONSTRUCTION  
 STANDARD No.

REVISION

0

Z-6



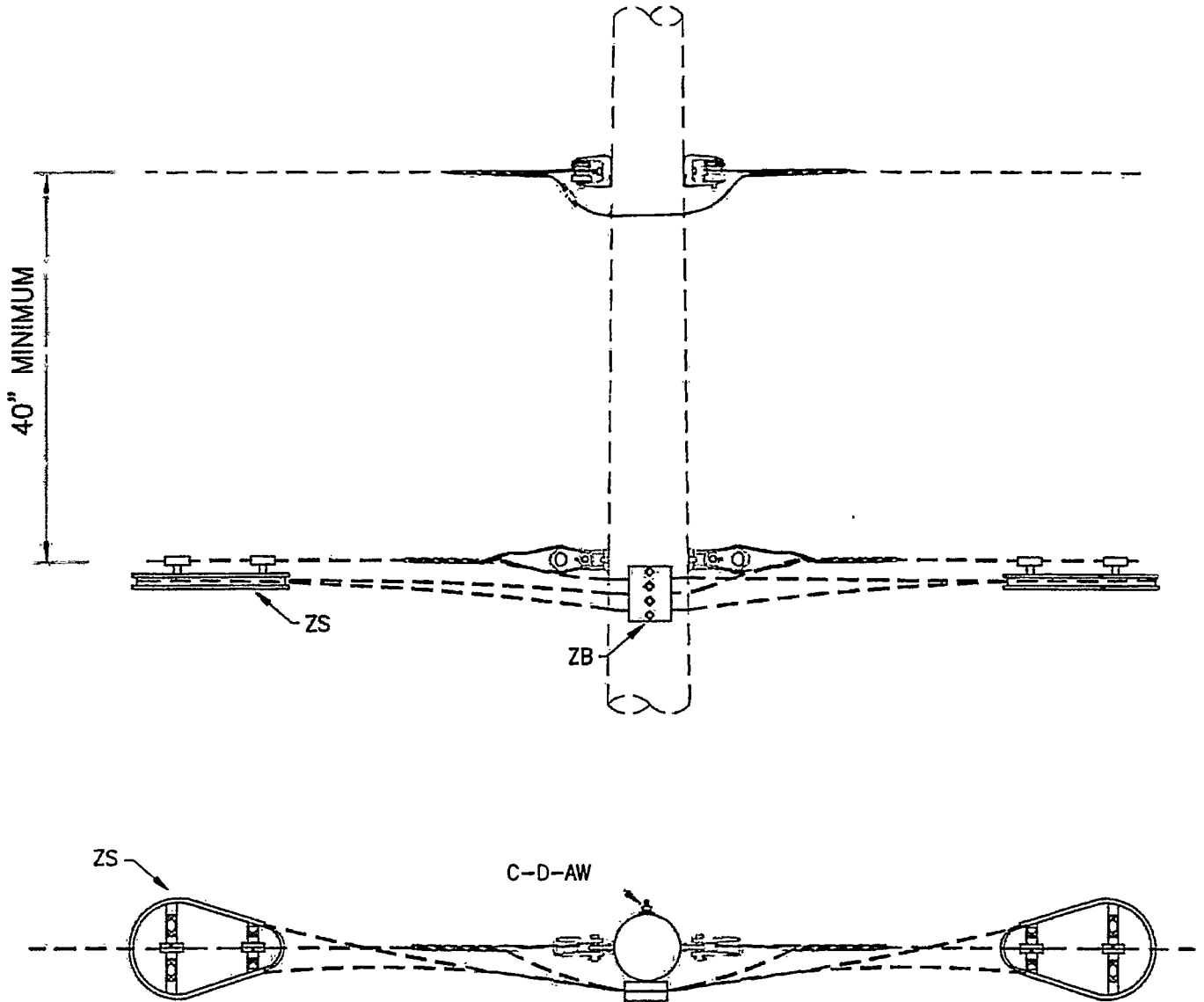

**NOTE:**  
 ALL NEW POLES ARE REQUIRED TO  
 HAVE A GROUNDLINE POLE WRAP  
 AND A POLE TOP CAP INSTALLED.

**NOTE:**  
 FIBER ATTACHMENT MUST BE 40"  
 MINIMUM BELOW LOWEST SUPPLY  
 CONDUCTOR

ITEM	QUAN.	MATERIAL DESCRIPTION
C	1	MACHINE BOLT, 5/8" x REQ'D LENGTH
D	1	WASHER, 2 1/4" x 2 1/4"
AW	1	LOCK WASHER (SPRING TYPE), AS REQ'D
ZB	1	FIBER MOUNTING BRACKET
ZS	2	FIBER STORAGE UNIT



NORTH LITTLE ROCK ELECTRIC CONSTRUCTION STANDARDS  
 STORAGE UNIT  
 ADSS FIBER

DATE: 7-21-2016	REVISION
SHT No: 1	0
CONSTRUCTION STANDARD No.	ZQ-1

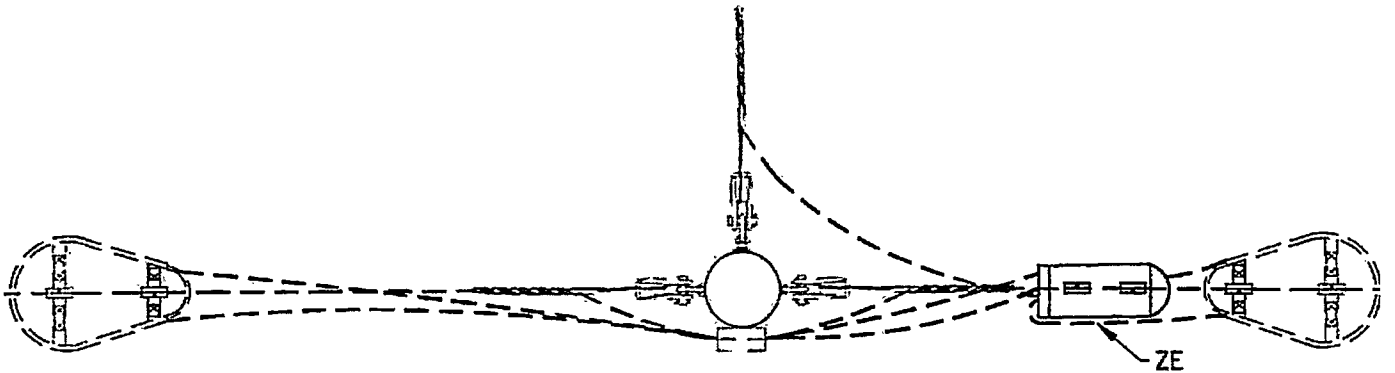
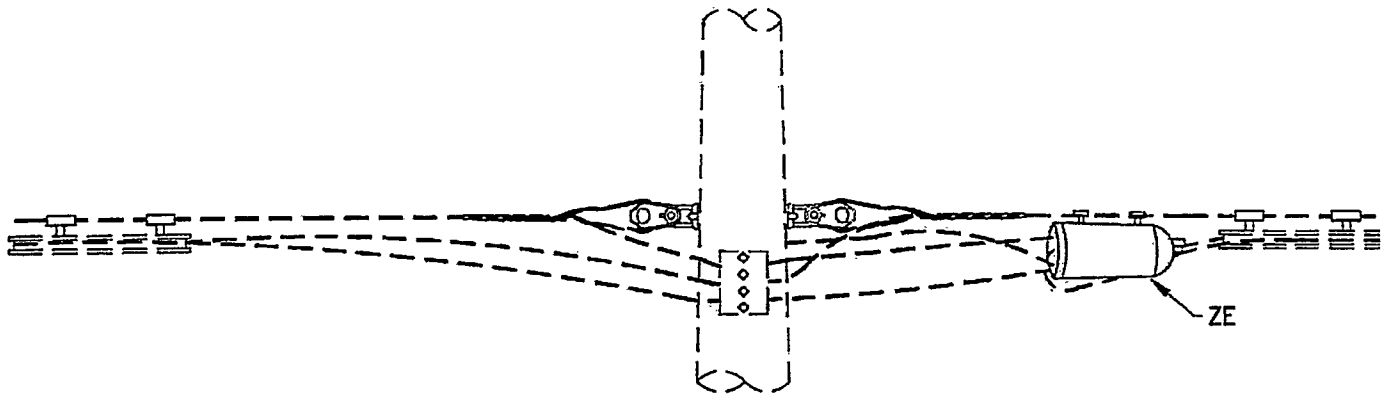

**NOTE:**  
ALL NEW POLES ARE REQUIRED TO  
HAVE A GROUNDLINE POLE WRAP  
AND A POLE TOP CAP INSTALLED.

**NOTE:**  
FIBER ATTACHMENT MUST BE 40"  
MINIMUM BELOW LOWEST SUPPLY  
CONDUCTOR

ITEM	QUAN.	MATERIAL DESCRIPTION		
ZE	1	FIBER SPLICE ENCLOSURE		
	NORTH LITTLE ROCK ELECTRIC CONSTRUCTION STANDARDS SPLICE ENCLOSURE ADSS FIBER		DATE: 7-25-2016	REVISION
			SHT No: 1	0
			CONSTRUCTION STANDARD No.	ZQ-2

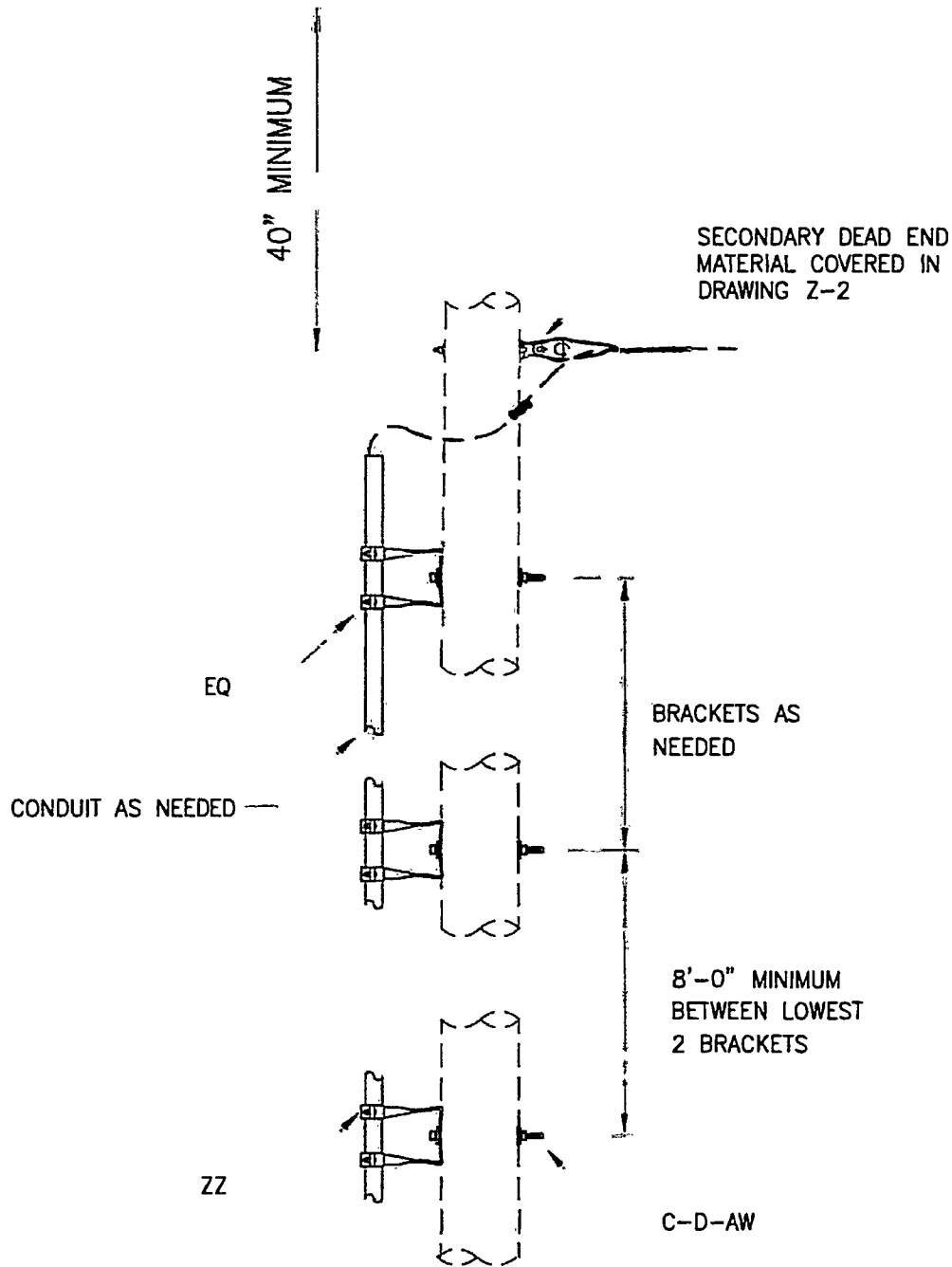

**NOTE:**  
 ALL NEW POLES ARE REQUIRED TO  
 HAVE A GROUNDLINE POLE WRAP  
 AND A POLE TOP CAP INSTALLED.

**NOTE:**  
 FIBER ATTACHMENT MUST BE 40"  
 MINIMUM BELOW LOWEST SUPPLY  
 CONDUCTOR

ITEM	QUAN.	MATERIAL DESCRIPTION
C	4	MACHINE BOLT, 5/8" x REQ'D LENGTH
D	4	WASHER, 2 1/4" x 2 1/4"
AW	4	LOCK WASHER (SPRING TYPE), AS REQ'D
EQ	4	CONDUIT BRACKET
ZZ	4	2" ONE HOLE PIPE STRAP W/ BOLT



NORTH LITTLE ROCK ELECTRIC CONSTRUCTION STANDARDS

RISER  
 ADSS FIBER

DATE: 7-20-2016	REVISION
SHT No: 1	0
CONSTRUCTION STANDARD No.	ZU-1